

Lap Tray

NOTE: Due to a design change, when ordering Lap Trays for models manufactured before 4/13/00, see page titled "Arms" and order the Adjustable Height Arm Tubes also. THE PRODUCTION OF THE HTR IS CURRENTLY SUSPENDED AND SOME SERVICE PARTS MAY NOT BE AVAILABLE TO ORDER.

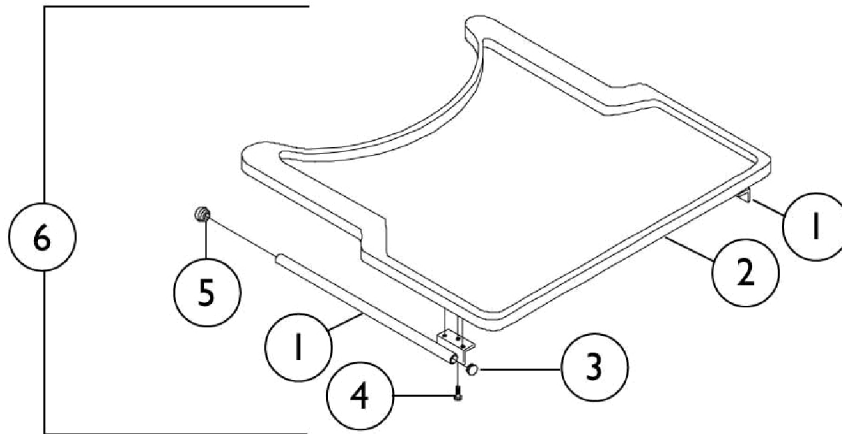

Item Number	Note	Part Number	Description	Quantity Per	
				Package	Assembly
1	A	460082-1-NLA	Rod, Tray, Chrome - Right	1	1
1	B	1129543	Rod, Tray, Grey - Right	1	1
1	A	460081-1-NLA	Rod, Tray, Chrome - Left	1	1
1	B	1129544	Rod, Tray, Grey - Left	1	1
2		350056	Tray, Lap (16")	1	1
2		350057	Tray, Lap (18")	1	1
3		1027097	Plug Button, Black (3/4")	1	2
4		1108148-NLA	NLA - Screw, Phillips Pan Head w/Patch (#10-24 x 3/8")	1	6
5		1108107-NLA	NLA - Plug Button, Dome, Black (3/4")	1	2
6	A	460087	Lap Tray Assembly, Chrome (16")	1	1
6	B	1129601	Lap Tray Assembly, Grey (16")	1	1
6	A	460088	Lap Tray Assembly, Chrome (18")	1	1
6	B	1129602	Lap Tray Assembly, Grey (18")	1	1

NOTE: A - Before 1/24/05. For use on chairs with "Chrome Frame Finish."
 B - After 1/23/05. For use on chairs with "Grey Frame Finish."