

C-Arm (Standard) and C-Arm Adjustable (Optional)

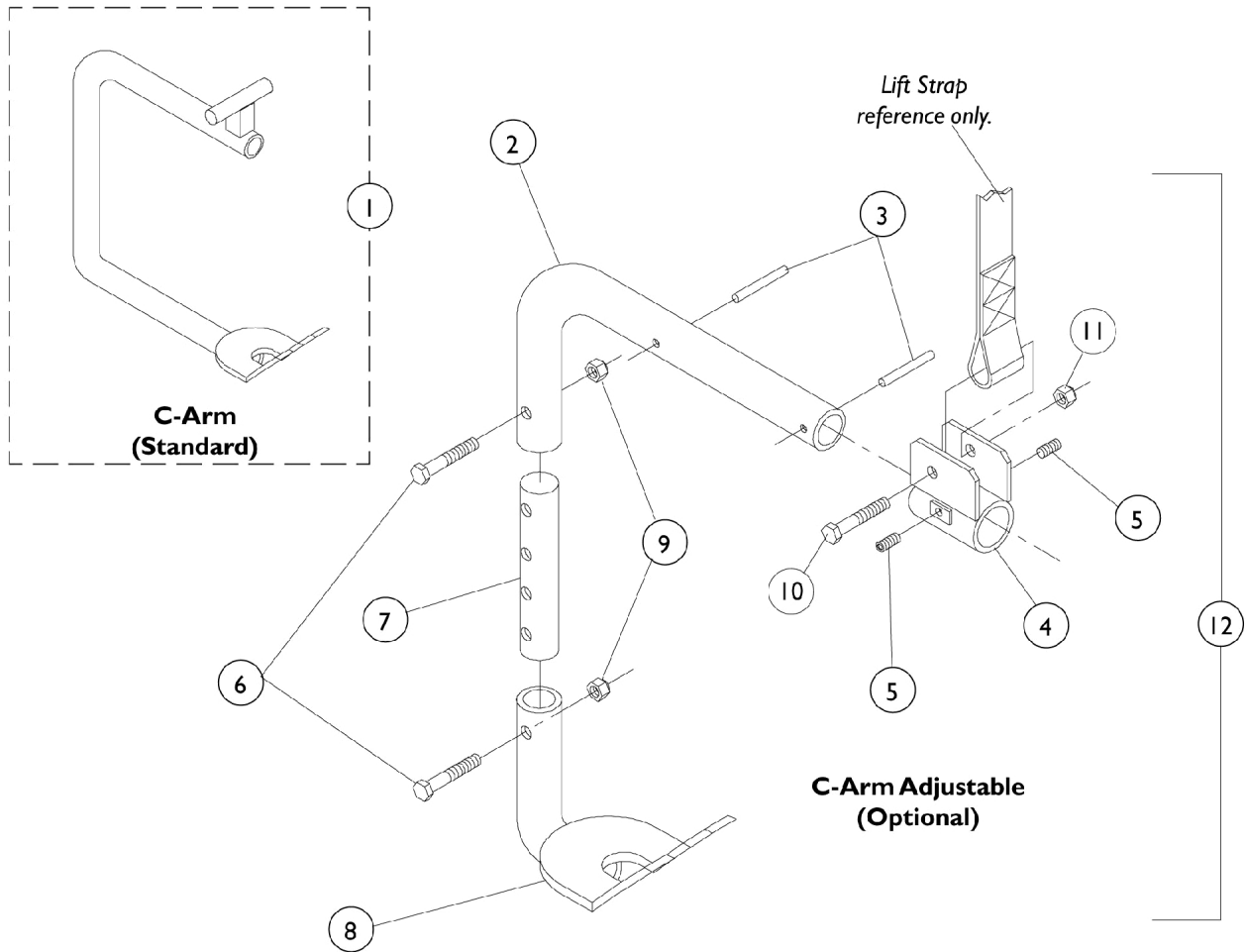

C-Arm (Standard) and C-Arm Adjustable (Optional)

| Item Number | Note | Part Number | Description | Quantity Per | |
|-------------|------|--------------|--|--------------|----------|
| | | | | Package | Assembly |
| 1 | | AP072358-NLA | NLA - C-Arm | 1 | 1 |
| 2 | | AP072464-NLA | NLA - Arm, Upper | 1 | 1 |
| 3 | | AP100708-NLA | NLA - Pin, Roll (3/16 x 1-1/2") | 1 | 2 |
| 4 | | AP072461-NLA | NLA - Bracket, Lift | 1 | 1 |
| 5 | | AP101395-NLA | NLA - Screw, Socket Set (1/4-20 x 1/4") | 1 | 2 |
| 6 | | AP100581-NLA | NLA - Screw, Hex Head (5/16-18 x 1-1/2") | 1 | 2 |
| 7 | | AP072465-NLA | NLA - Shaft, Adjustable, C-Arm | 1 | 1 |
| 8 | | AP072468-NLA | NLA - Arm, Lower | 1 | 1 |
| 9 | | AP100627-NLA | NLA - Locknut (5/16-18 x 2-1/4") | 1 | 2 |
| 10 | | AP100561-NLA | NLA - Screw, Hex Head (3/8-16 x 1-3/4") | 1 | 1 |
| 11 | | AP100562-NLA | NLA - Locknut (3/8-16) | 1 | 1 |
| 12 | A | AP072469-NLA | NLA - C-Arm, Adjustable (Optional) | 1 | 1 |

NOTE: A - Includes items 2-11.