

Motor, Transformer and Pendant AC, DC - Canadian

**Motor AC and Pendant
Before 5/23/98**

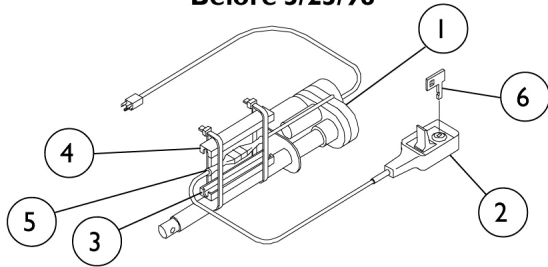

**Motor DC and Pendant
From 5/23/98 thru 1/27/99**

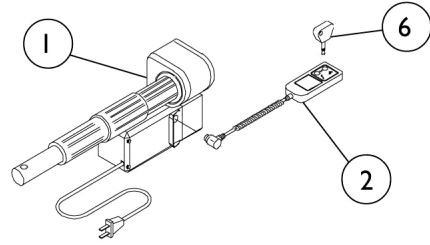

Motor, Transformer, and Pendant - After 1/27/99

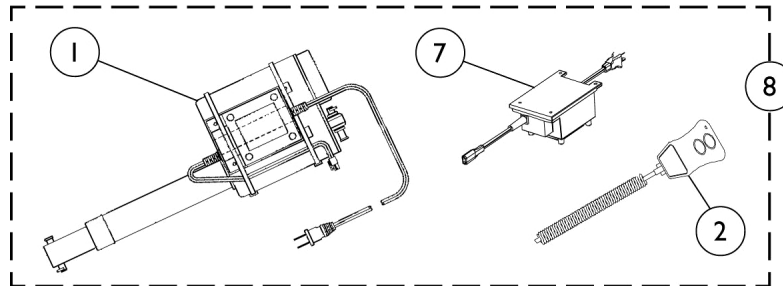

Motor, Transformer and Pendant AC, DC - Canadian

Item Number	Note	Part Number	Description	Quantity Per	
				Package	Assembly
1	A	52000M330-NLA	NLA - Motor Assembly Kit, AC (Includes: Motor, Pendant, and Instruction Sheet)	1	1
1	B	52000M339-NLA	NLA - Motor Assembly Kit, DC (Includes: Motor, Pendant, and Instruction Sheet)	1	1
1		7000M331-NLA	NLA - Motor with Pull Tube	1	1
1	C	52000M345-NLA	NLA - Kit, Motor, DC with Transformer (Includes: Hitch Pin, Clevis Pin, Washers, Cable Ties, and Instruction Sheet)	1	1
2	A	54000M644-NLA	NLA - Pendant, AC with Key Switch	1	1
2	B	52000M358-NLA	NLA - Pendant, DC Replacement Kit (Includes: Pendant, Key, and Attaching Hardware)	1	1
2	C	52000M357-NLA	NLA - Pendant, DC Replacement Kit (Includes: Pendant, Key, and Attaching Hardware)	1	1
3		51000M915-NLA	NLA - Housing, Connector - Top	1	1
4		51000M916-NLA	Housing, Connector - Bottom	1	1
5		51000M712	Bushing	1	1
6	A	52000M136-NLA	NLA - Key, AC Motor Switch	1	1
6	A	52000M327-NLA	NLA - Key, AC Pendant	1	1
6	B	52000M341-NLA	NLA - Key, DC Pendant	1	1
6	C	52000M351-NLA	NLA - Key, DC Pendant	1	1
7	C	54000M801-NLA	NLA - Transformer, 115V US/Canada	1	1
8	C	1090518-NLA	NLA - Motor, Transformer, and Pendant Kit	1	1
	D,E	52000M359-NLA	NLA - Kit, Transformer Replacement(Includes: Power Supply and Cable Ties)	1	1

NOTE: A - Before 5/23/98
 B - Between 5/24/98 through 1/27/99
 C - After 1/28/99
 D - Not Shown
 E - Transformer required only on chairs built after 1/27/99.