

Motor, Transformer and Pendant AC/DC - U.S.

**Motor AC and Pendant
Before 10/13/97**

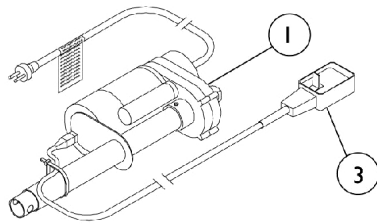

**Motor DC and Pendant
From 10/13/97 thru 11/8/98**

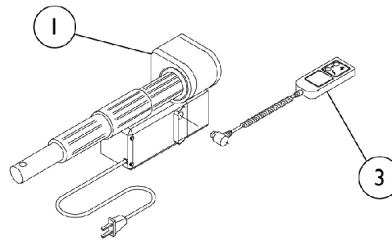

**Motor, Transformer, and Pendant
After 11/8/98**

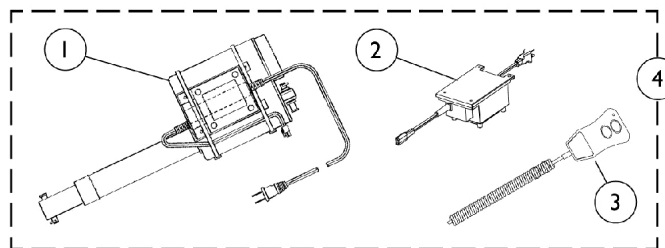

| Item Number | Note | Part Number | Description | Quantity Per | |
|-------------|------|---------------|--|--------------|----------|
| | | | | Package | Assembly |
| 1 | A,H | 52000M330-NLA | NLA - Motor Assembly Kit, AC (Includes: Motor, Pendant, and Instruction Sheet) | 1 | 1 |
| 1 | B,C | 52000M335-NLA | NLA - Kit, Motor DC | 1 | 1 |
| 1 | D | 52000M345-NLA | NLA - Kit, Motor, DC with Transformer (Includes: Hitch Pin, Clevis Pin, Washers, Cable Ties, and Instruction Sheet) | 1 | 1 |
| 2 | E | 54000M801-NLA | NLA - Transformer, 115V US/Canada | 1 | 1 |
| 3 | A | 54000M644-NLA | NLA - Pendant, AC with Key Switch | 1 | 1 |
| 3 | B,C | 52000M356-NLA | NLA - Pendant, DC Motor | 1 | 1 |
| 3 | D | 52000M347-NLA | NLA - Pendant, DC Motor - No Longer Available (Includes: Screws, Cable Ties, and Cable Clamps) | 1 | 1 |
| 4 | | 52000M348-NLA | NLA - Kit, Motor, Transformer and Pendant (Includes: Attaching Hardware and Instructions) | 1 | 1 |
| | F,G | 52000M359-NLA | NLA - Kit, Transformer Replacement(Includes: Power Supply and Cable Ties) | 1 | 1 |
| | F | 52000M354-NLA | NLA - Kit, Transformer Bracket (Includes: Linkage Plate, Washers, Screws, Bolts, Nuts, Cable Ties, and Instruction Sheet) | 1 | 1 |

NOTE: A - Before 10/13/97
 B - Between 10/14/97 to 11/8/98
 C - Motor and Pendant are NLA, order item 4 Motor, Transformer, and Pendant kit.
 D - After 11/8/98
 E - After 12/15/98
 F - Not Shown
 G - When Ordering a Transformer Replacement Kit on chairs built before 12/15/98, a Transformer Bracket Kit should be ordered as well.
 H - Includes #53000M566.