

Solid Folding Seat

NOTE: Due to the possibility of various manufacturing dates for Tracer IV Wheelchairs built with a serial # starting with "03H" or "03I", replacement parts will need to be ordered thru an Invacare Parts Specialist at 1-800-333-6900.

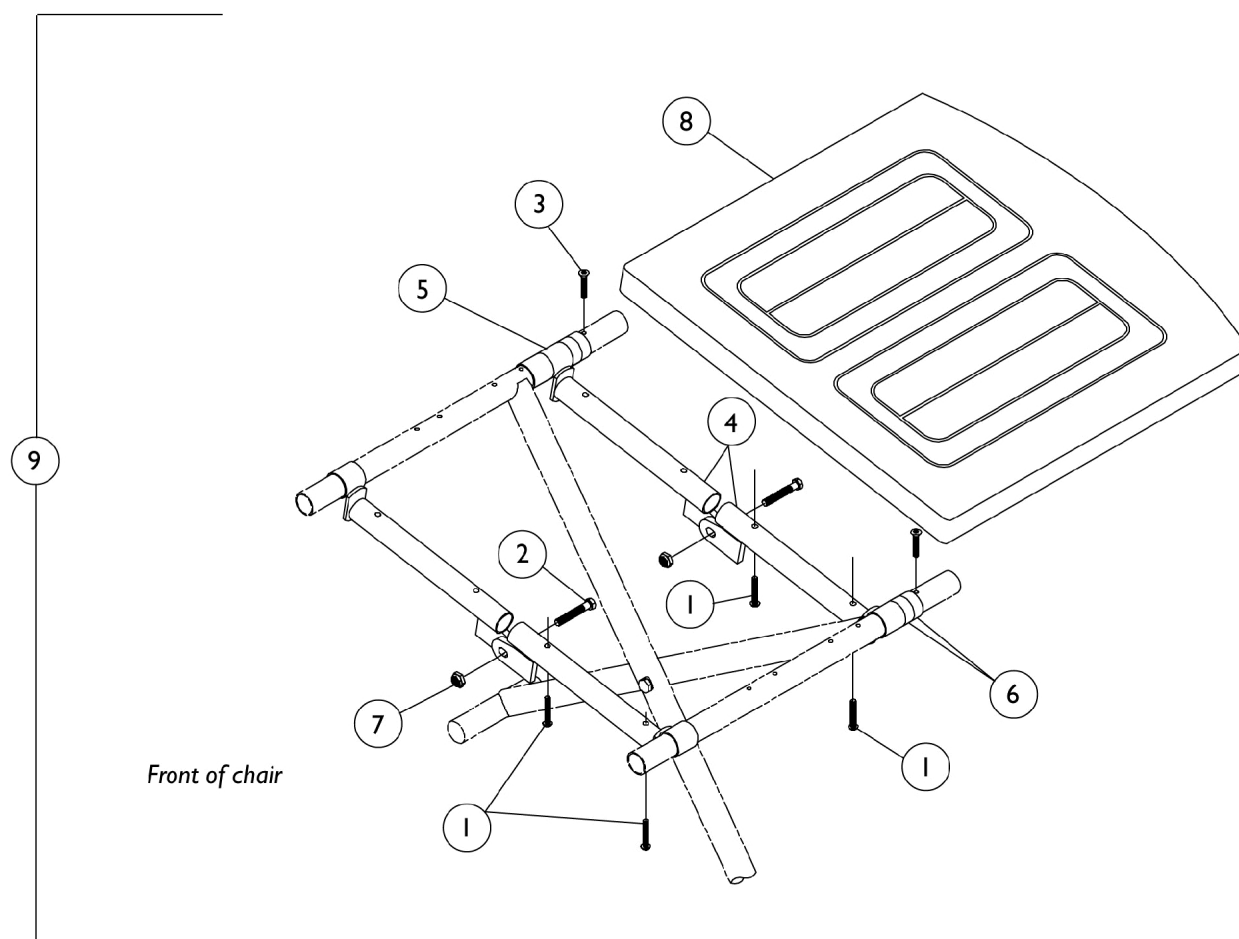

Solid Folding Seat

NOTE: Due to the possibility of various manufacturing dates for Tracer IV Wheelchairs built with a serial # starting with "03H" or "03I", replacement parts will need to be ordered thru an Invacare Parts Specialist at 1-800-333-6900.

Item Number	Note	Part Number	Description	Quantity Per	
				Package	Assembly
1		11008X011	Screw, Phillips Round Head (#10-32 x 1-3/8")	1	4
2		12144X000	Screw, Hex Head (5/16-18 x 1")	1	2
3		20228X013-NLA	NLA - Screw, Phillips Oval Head (#10 x 7/8")	1	2
4	B,C,D	1012976-NLA	NLA - Crossbrace, Chrome (16-1/2" W)	1	4
4	B,C,E	1012979-NLA	NLA - Crossbrace, Chrome (18" W)	1	4
5		47397X019	Spacer (7/8 x 1 x 1")	1	1
6		47397X024	Spacer (7/8 x 1 x 7/16")	1	1
7		60290X002	Locknut (5/16-18)	1	2
8	D	8881105954	Upholstery, Seat, Solid, Vinyl (16-1/2" Wide Chairs)	1	1
8	E	8881105955	Upholstery, Seat, Solid, Vinyl (18" Wide Chair)	1	1
9	B,D,F	8881105956-NLA	NLA - Seat, Solid Folding (16-1/2" W)	1	1
9	B,D,F	8881105957-NLA	NLA - Seat, Solid Folding (18" W)	1	1
9	C,D,F	8881105958-NLA	NLA - Seat, Solid Folding (16-1/2" W)	1	1
9	C,D,F	1045992	Solid Folding Seat Assembly, Vinyl, U05 Jet Black (16-1/2" W)	1	1
9	C,E,F	8881105959-NLA	NLA - Seat, Solid Folding (18" W)	1	1
9	C,E,F	1045994-NLA	NLA - Solid Folding Seat Assembly, Vinyl, U05 Jet Black (18" W)	1	1
	A,G	1036813-NLA	NLA - Instruction Sheet	1	1

NOTE: A - Not Shown
 B - Permanent Arm Chair.
 C - Removable Arm Chair.
 D - 16-1/2" Wide Chair.
 E - 18" Wide Chair.
 F - Includes Items 1-8.
 G - Item is no longer available from the Invacare Service Parts Department. Refer to the Invacare Website under "Product Literature Search". Enter the part number in the "Keywords" field and download a free PDF version copy.