

Anti-Tipper

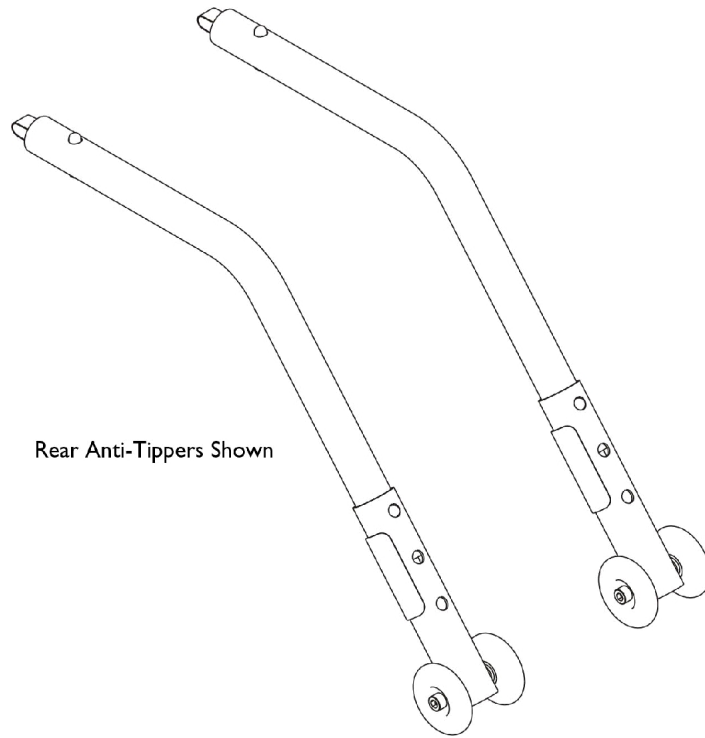

Rear Anti-Tippers Shown

Anti-Tipper

Chair Model and/or Type	Frame Style	Seat to Floor Height	Rear Wheel Size	Anti-Tip Model	Service Kit Part Number
Titan	Standard	19-1/2"	N/A	9759	1086189 See Note(s) B
Titan	Standard	18-1/2"	N/A	9759	1086189 See Note(s) B
Titan	Standard	17-1/2"	N/A	9759	1086189 See Note(s) B
Titan	Standard	16-1/2"	N/A	9758	1086190 See Note(s) B
Titan	Standard	15-1/2"	N/A	9758	1086190 See Note(s) B
SX	Standard	19-1/2"	24"	9759	1086189 See Note(s) B
SX	Standard	18-1/2"	22"	9759	1086189 See Note(s) B
SX	Standard	17-1/2"	20 or 24"	9759	1086189 See Note(s) B
SX	Standard	16-1/2"	22"	9758	1086190 See Note(s) B
SX	Standard	15-1/2"	20"	9758	1086190 See Note(s) B
SX Recliner	Recliner	19-1/2"	All	See Note See Note(s) A	1088242-NLA See Note(s) A, C
SX Recliner	Recliner	19-1/2"	All	See Note	1192313 See Note(s) A
DLX	Standard	19-1/2"	24"	9759	1086189 See Note(s) B
DLX	Standard	18-1/2"	22"	9759	1086189 See Note(s) B
DLX	Standard	17-1/2"	20 or 24"	9759	1086189 See Note(s) B
DLX	Standard	16-1/2"	22"	9758	1086190 See Note(s) B
DLX	Standard	15-1/2"	20"	9758	1086190 See Note(s) B
EX	"S" Frame Style (Before 3/99)	19-1/2"	24"	1358M	1036900 See Note(s) B
EX w/ 1-Arm Drive	"S" Frame Style (Before 3/99)	19-1/2"	24"	1358N	1036901-NLA See Note(s) B
EX and MGI	Box Frame Style (After 3/99)	21"	24"	9758	1086190 See Note(s) B
EX and MGI	Box Frame Style (After 3/99)	20"	22"	9758	1086190 See Note(s) B
EX	Box Frame Style (After 3/99)	19-20"	20"	9859	1064227-NLA See Note(s) B
MGI	Fixed Frame or Box Frame Style (After 3/99)	19"	20"	9859	1064227-NLA See Note(s) B

Anti-Tipper

Chair Model and/or Type	Frame Style	Seat to Floor Height	Rear Wheel Size	Anti-Tip Model	Service Kit Part Number
EX w/1-Arm Drive	Box Frame Style (After 3/99)	19-1/2"	24"	9758	1086190 See Note(s) B
EX with Amputee	Box Frame Style (After 3/99)	19-1/2"	24"	9758	1086190 See Note(s) B
MG	"S" Frame Style (Before 3/99)	19-1/2"	24"	1358M	1036900 See Note(s) B
MG	Box Frame Style (After 3/99)	19-1/2"	24"	9758	1086190 See Note(s) B
MGI and MG Fixed Frame	Fixed Frame	21"	24"	9758	1086190 See Note(s) B
CareGuard	Standard	All	N/A	9758	1086190 See Note(s) B
CareGuard Titan	Standard	All	24"	TITAN9759	1086189 See Note(s) B
<p>NOTE: A - Tracer SX Recliner Anti-Tippers are standard when chair is ordered. Therefore, Anti-Tippers are sold as one each and not as a pair. B - Includes a pair of Anti-Tippers and Instruction Sheet. C - Chrome is No Longer Available. Order part #1192313 Black as a replacement. Recommended to order a quantity of 2 to match.</p>					

Anti-Tipper

Front Anti-Tipper (not shown)

Part Description	Part Number
Front Anti-Tipper (1326) (Pair)	1042412