

Crossbraces and Hardware

Removable Arm Chairs - Tracer IV Only (Before 10/1/03)

NOTE: Due to the possibility of various manufacturing dates for Tracer IV Wheelchairs built with a serial # starting with "03H" or "03I", replacement parts will need to be ordered thru an Invacare Parts Specialist at 1-800-333-6900.

NOTE: If your Tracer IV chair was built with a serial # starting with "03H" or "03I", please contact Parts Specialist for replacement parts at Invacare 1-800-333-6900 Ext. 3722.

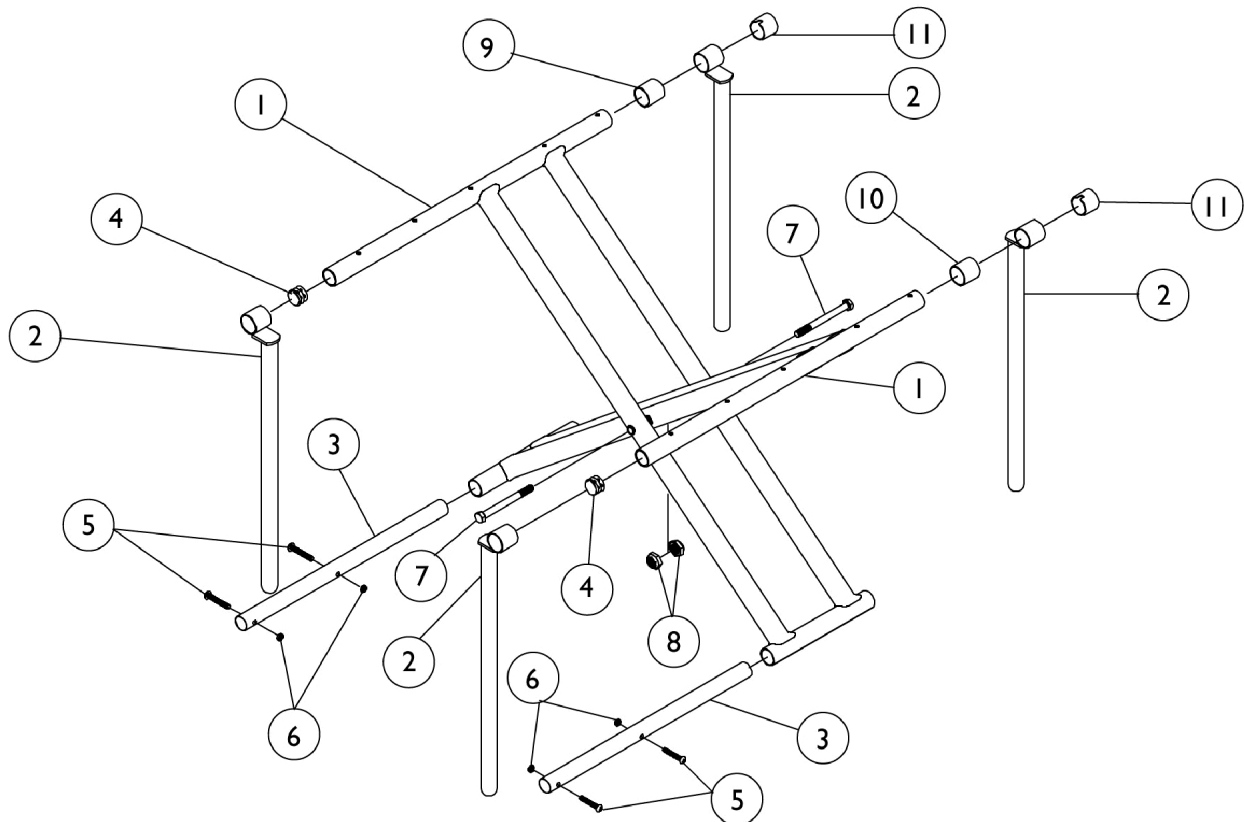

Crossbraces and Hardware

Removable Arm Chairs - Tracer IV Only (Before 10/1/03)

NOTE: Due to the possibility of various manufacturing dates for Tracer IV Wheelchairs built with a serial # starting with "03H" or "03I", replacement parts will need to be ordered thru an Invacare Parts Specialist at 1-800-333-6900.

Item Number	Note	Part Number	Description	Quantity Per	
				Package	Assembly
1		See Chart	Crossbraces without Hardware	1	1
2		1054951-NLA	NLA - Guide, Seat	1	4
3		1055409	Tube, Insert	1	2
4		1027095	Plug Button, Black (7/8")	1	2
5		40183X002	Screw, Phillips Pan Head (#10-32 x 1-1/8")	1	4
6		60279X003	Locknut (#10-32)	1	4
7		40317X001	Screw, Hex Head (5/16-24 x 2-3/4")	1	2
8		1107321	Nut, Low Cap (5/16"-24)	1	2
9	A	47397X020	Spacer (7/8 x 1 x 1-3/8")	1	1
10	B	47397X022	Spacer (7/8 x 1 x 7/8")	1	1
11		1055646	Cap, End, Black	1	2

NOTE: A - For right side.
B - For left side.

Crossbraces without Hardware

Chair Width	Adult - Chrome Before 2/7/00	Adult - Tuff Black 2/8/00-9/9/01	Adult - Tuff Black Between 9/10/01 - 9/30/03
20" Right	1055010	1091690-NLA	1105147-NLA
20" Left	1055011	1091691-NLA	1105148-NLA
22" Right	1054959	1087086-NLA	1105152-NLA
22" Left	1054960	1087087-NLA	1105153-NLA
24" Right	1055006	1091692-NLA	1105157
24" Left	1055007	1091693-NLA	1105158