

Crossbraces and Hardware

Permanent Arm Chairs

NOTE: Due to the possibility of various manufacturing dates for Tracer IV Wheelchairs built with a serial # starting with "03H" or "03I", replacement parts will need to be ordered thru an Invacare Parts Specialist at 1-800-333-6900.

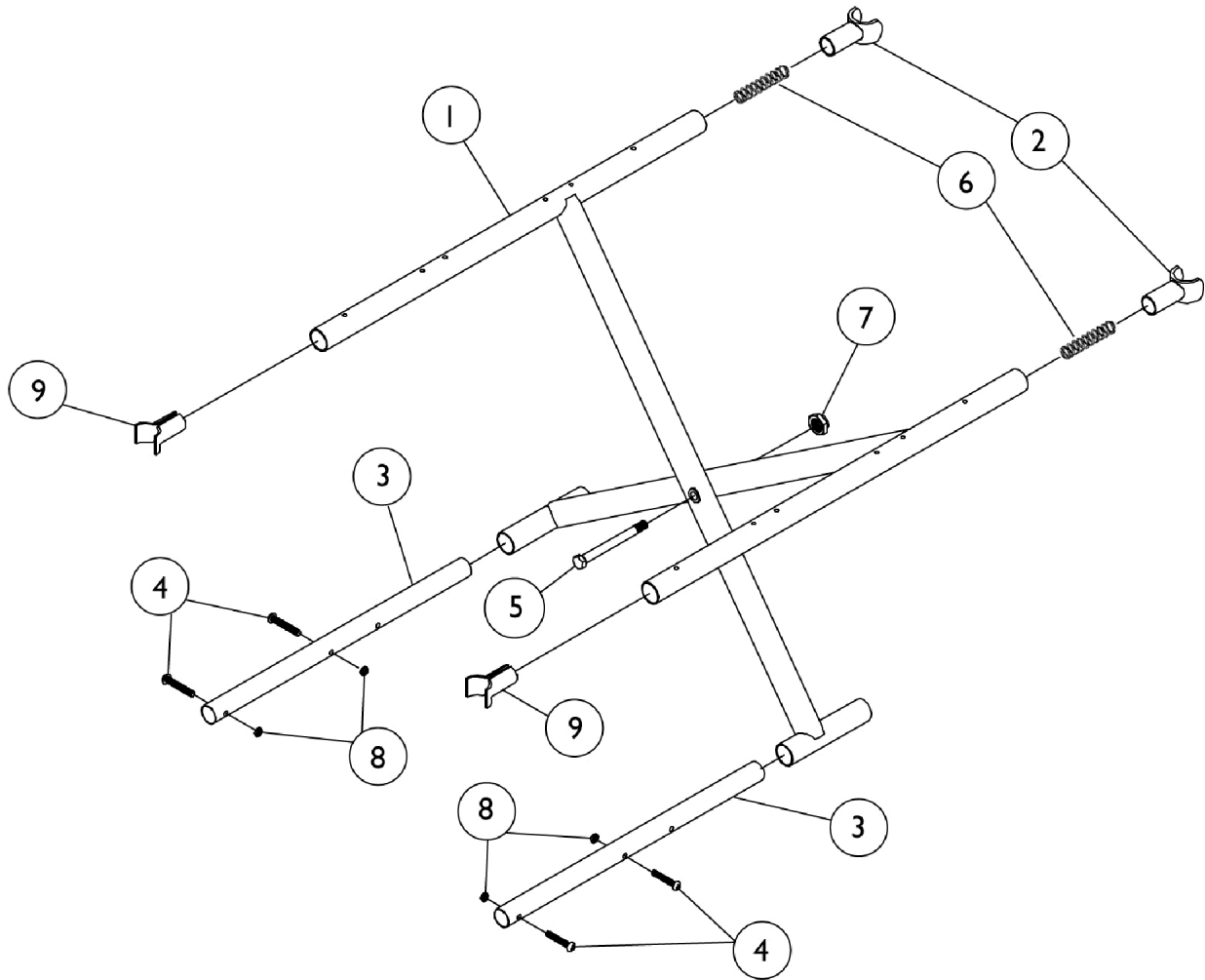

Crossbraces and Hardware

Permanent Arm Chairs

NOTE: Due to the possibility of various manufacturing dates for Tracer IV Wheelchairs built with a serial # starting with "03H" or "03I", replacement parts will need to be ordered thru an Invacare Parts Specialist at 1-800-333-6900.

| Item Number | Note | Part Number | Description | Quantity Per | |
|--|------|---------------|--|--------------|----------|
| | | | | Package | Assembly |
| 1 | | See Chart | Crossbraces without Hardware - Tracer, Plus, LX Chairs | 1 | 1 |
| 1 | | See Chart | Crossbraces without Hardware - Transport Chairs | 1 | 1 |
| 2 | A,B | 04723X003-NLA | NLA - Guide, Seat, Chrome | 1 | 2 |
| 2 | B | 1058416 | Guide, Seat, Front, Black | 1 | 2 |
| 2 | C,D | 1023617 | Guide, Seat, Rear, Black | 1 | 2 |
| 3 | | 1017985 | Tube, Insert | 1 | 2 |
| 4 | | 40183X002 | Screw, Phillips Pan Head (#10-32 x 1-1/8") | 1 | 4 |
| 5 | | 40317X001 | Screw, Hex Head (5/16-24 x 2-3/4") | 1 | 1 |
| 6 | B | 47236X001 | Spring, Tension | 1 | 2 |
| 7 | | 1107321 | Nut, Low Cap (5/16"-24) | 1 | 1 |
| 8 | | 60279X003 | Locknut (#10-32) | 1 | 4 |
| 9 | | 1058416 | Guide, Seat, Front, Black | 1 | 2 |
| NOTE: A - For use on Tracer and Tracer Plus before 2/95. B - For use on Tracer LX. C - For use on Tracer and Tracer Plus after 1/95. D - For use on Tracer Transport. | | | | | |

Crossbraces without Hardware - Tracer, Plus, LX Chairs

| Chair Width | Adult - Swingaway Frame | Adult Fixed Front | Hemi (Tracer LX Only) |
|--|--------------------------|-------------------|-----------------------|
| 14" Right | 1062973-NLA | N/A | N/A |
| 14" Left | 1062974-NLA | N/A | N/A |
| 16-1/2" Right | 1062978-NLA | 1089706 | 1035671 |
| 16-1/2" Left | 1062979-NLA | 1089707 | 1035669 |
| 18" Right | 1069719 See Note(s) A | 1011758 | 1035642 |
| 18" Left | 1069720 See Note(s) A | 1011759 | 1035640 |
| NOTE: A - Chrome Finish 1045586/ 1045587 is no longer available. Order right 1069719 and left 1069720 Crossbrace to match. | | | |

Crossbraces without Hardware - Transport Chairs

| Chair Width | Adult - Chrome | Adult - Black |
|---------------|--------------------------|---------------|
| 14" Right | 1062973-NLA | 1085517-NLA |
| 14" Left | 1062974-NLA | 1085518-NLA |
| 16-1/2" Right | 1062978-NLA | 1075879-NLA |
| 16-1/2" Left | 1062979-NLA | 1075880-NLA |
| 18" Right | 1069719 See Note(s) A | 1069719 |

Crossbraces and Hardware

Permanent Arm Chairs

NOTE: Due to the possibility of various manufacturing dates for Tracer IV Wheelchairs built with a serial # starting with "03H" or "03I", replacement parts will need to be ordered thru an Invacare Parts Specialist at 1-800-333-6900.

Crossbraces without Hardware - Transport Chairs

| Chair Width | Adult - Chrome | Adult - Black |
|--|--------------------------|---------------|
| 18" Left | 1069720 See Note(s) A | 1069720 |
| NOTE: A - Chrome Finish 1045586/ 1045587 is no longer available. Order right 1069719 and left 1069720 Crossbrace to match. | | |