

Side Frames and Hardware

Permanent Arm Chairs

NOTE: Due to the possibility of various manufacturing dates for Tracer IV Wheelchairs built with a serial # starting with "03H" or "03I", replacement parts will need to be ordered thru an Invacare Parts Specialist at 1-800-333-6900.

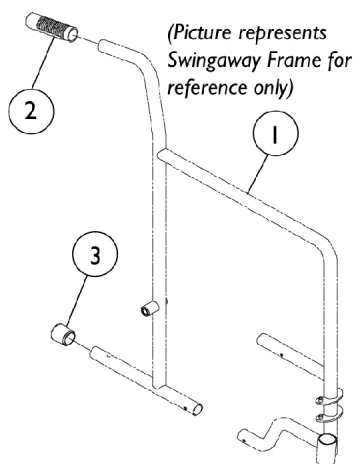

All Swingaway and Fixed Front Models (Except Transport)

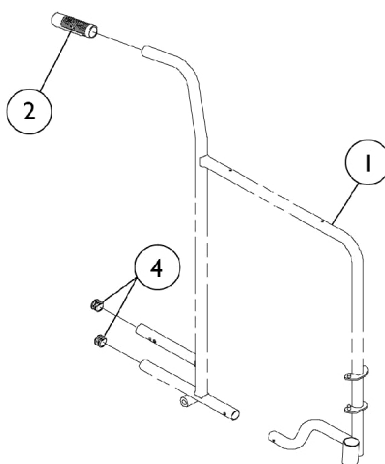

Fixed Back Transport Models

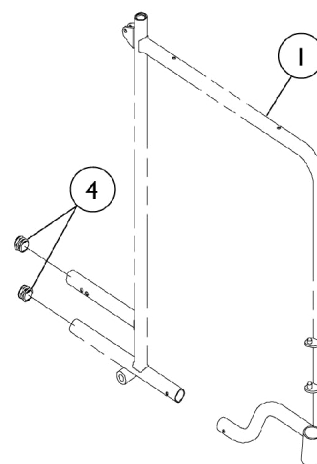

Fold Down Transport Models

Item Number	Note	Part Number	Description	Quantity Per	
				Package	Assembly
1		See Chart	Side Frames & Hardware - Tracer	1	1
1		See Chart	Side Frames & Hardware - Tracer LX	1	1
1		See Chart	Side Frames & Hardware - Tracer Plus	1	1
1		See Chart	Side Frames & Hardware - Transport	1	1
2		1021261	Grip, Hand (6")	1	1
3		1016346	Cap, End, Tube, Black (7/8")	1	1
4		1027095	Plug Button, Black (7/8")	1	2
	A	1085454	Bolt, Hex Head Cap (7/16-20 x 5-1/8")	1	1
	A	1045608	Locknut (7/16-20)	1	1
	A	1022671	Spacer (7/16 x 5/8 x 1/2")	1	1

NOTE: A - Not Shown. Components contained in Kit Hardware 1034109 must be ordered separately.

Tracer Frames

Chair Model	Adult Frames - Right	Adult Frames - Left	Rear Wheel Hardware
Swingaway Frame	1092382-NLA See Note(s) A	1092383-NLA See Note(s) A	1034106 See Note(s) A
Fixed Front	1092392 See Note(s) C, B	1092393 See Note(s) B, C	1034109-NLA See Note(s) B, D

Side Frames and Hardware

Permanent Arm Chairs

NOTE: Due to the possibility of various manufacturing dates for Tracer IV Wheelchairs built with a serial # starting with "03H" or "03I", replacement parts will need to be ordered thru an Invacare Parts Specialist at 1-800-333-6900.

NOTE:	A - Due to a design change, when ordering this frame, a rear wheel hardware kit must also be ordered. See Item #1034106 in the column titled, "Rear Wheel Hardware."
	B - Due to a design change, when ordering this frame, a rear wheel hardware kit must also be ordered. See Item #1034109 in the column titled, "Rear Wheel Hardware."
	C - After 10/14/14 color changed from Chrome to Black. It is recommended to order both the right and left side to match.
	D - Part #1034109 is No Longer Available. Must order components separately 1085454, 1045608, 1022671 along with 1047943.

Tracer Plus Frames

Chair Model	Adult Frames - Right	Adult Frames - Left	Rear Wheel Hardware
Swingaway Frame	1092382-NLA	1092383-NLA	1034106
	See Note(s) A	See Note(s) A	See Note(s) A
Fixed Front	1092392	1092393	1034109-NLA
	See Note(s) B, C	See Note(s) C, B	See Note(s) B, D
NOTE: A - Due to a design change, when ordering this frame, a rear wheel hardware kit must also be ordered. See Item #1034106 in the column titled, "Rear Wheel Hardware." B - Due to a design change, when ordering this frame, a rear wheel hardware kit must also be ordered. See Item #1034109 in the column titled, "Rear Wheel Hardware." C - After 10/14/14 color changed from Chrome to Black. It is recommended to order both the right and left side to match. D - Not Shown. Components contained in Kit Hardware 1034109 must now be ordered separately. Use part numbers 1085454 Bolt, 1045608 Locknut, 1022671 Spacer.			

Side Frames and Hardware

Permanent Arm Chairs

NOTE: Due to the possibility of various manufacturing dates for Tracer IV Wheelchairs built with a serial # starting with "03H" or "03I", replacement parts will need to be ordered thru an Invacare Parts Specialist at 1-800-333-6900.

Tracer LX Frames

Chair Model	Frame Style	Rear Wheel Hardware
Adult Frames - Right	1092382-NLA See Note(s) A	1034106 See Note(s) A
Adult Frames - Left	1092383-NLA See Note(s) A	1034106 See Note(s) A
Hemi Frames - Right	1092388-NLA See Note(s) A	1034106 See Note(s) A
Hemi Frames - Left	1092389-NLA See Note(s) A	1034106 See Note(s) A

NOTE: A - Due to a design change, when ordering this frame, a rear wheel hardware kit must also be ordered.

Tracer Transport Frames

Chair Model	Adult Frames Right	Adult Frames Left	Hemi Frames Right	Hemi Frames Left
Fixed Back	1091007-NLA	1091008-NLA	N/A	N/A
Fold Down Back	1061552-NLA	1061553-NLA	N/A	N/A