

# MKIV Joysticks

## RII, RX, A, A+, TCHJOY

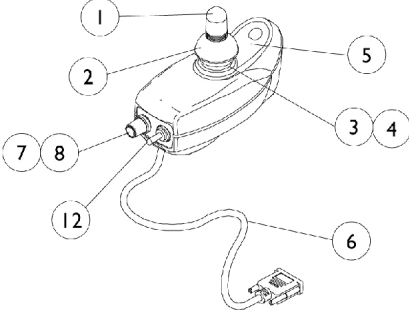

**1092610**  
**RII Joystick**

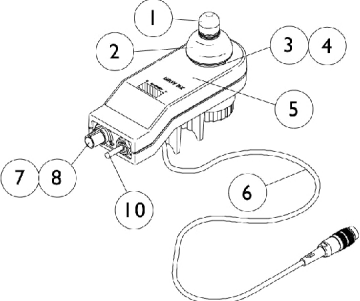

**1038603**  
**RX Joystick**

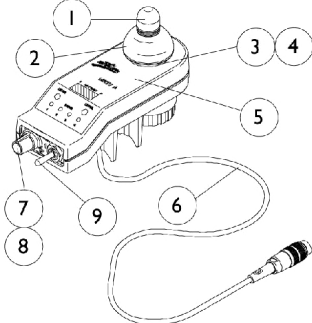

**1065944**  
**A Joystick**

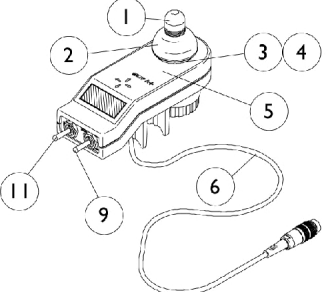

**1038608**  
**A+ Joystick**

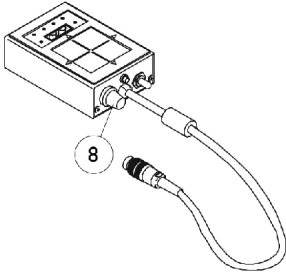

**1095289**  
**TCHJOY**  
**Touchpad "A"**  
**Joystick**

# MKIV Joysticks

## RII, RX, A, A+, TCHJOY

Item Number	Description	RII	RX	A	A+	TCHJOY
See Pictorial	Joystick Assembly	1092610-NLA	1038603-NLA	1065944-NLA	1038608-NLA	1095289-NLA
1	Knob, Joystick	1040217	1040217	1040217	1040217	N/A
2	Skirt, Joystick	1040218	1040218	1040218	1040218	N/A
3	Inductive, Joystick	1036764-NLA See Note(s) A	1036764-NLA See Note(s) B	1036764-NLA See Note(s) B	1036764-NLA See Note(s) A	N/A
3	Inductive, Joystick	N/A	1104397-NLA See Note(s) C	1104397-NLA See Note(s) C	N/A	N/A
4	Boot, Joystick	50000X364-NL A	50000X364-NL A	50000X364-NL A	50000X364-NL A	N/A
5	Overlay, Joystick Decal	N/A	1038642-NLA	1040190-NLA	1036776-NLA	N/A
6	Cable Assembly	N/A	1036750-NLA See Note(s) B	1036750-NLA See Note(s) B	1036750-NLA See Note(s) A	N/A
6	Cable Assembly	N/A	1104205-NLA See Note(s) C	1104205-NLA See Note(s) C	N/A	N/A
7	Potentiometer, Speed	1040225-NLA See Note(s) A	1040225-NLA See Note(s) B	1040225-NLA See Note(s) B	N/A	N/A
7	Potentiometer, Speed	N/A	1115518-NLA See Note(s) C	1115518-NLA See Note(s) C	N/A	N/A
8	Knob, Potentiometer	1025516-NLA	1025516-NLA	1025516-NLA	N/A	1025516-NLA
9	Switch, On/Off Momentary	N/A	N/A	1040185-NLA See Note(s) B	1040185-NLA See Note(s) A	N/A
9	Switch, On/Off Momentary	N/A	N/A	1115523-NLA See Note(s) C	N/A	N/A
10	Switch, Off/ 1-2	N/A	1038627-NLA See Note(s) B	N/A	N/A	N/A
10	Switch, Off/ 1-2	N/A	1115521-NLA See Note(s) C	N/A	N/A	N/A
11	Switch, Program	N/A	N/A	N/A	1040186-NLA See Note(s) A	N/A
12	Switch, Toggle SPDT	1010042-NLA See Note(s) A	N/A	N/A	N/A	N/A

NOTE: A - Item requires soldering  
 B - Before 10/01/02 item requires soldering  
 C - After 9/30/02 item has a non-solder connector.