

# MKIV Controller, Programmer & Attaching Hardware

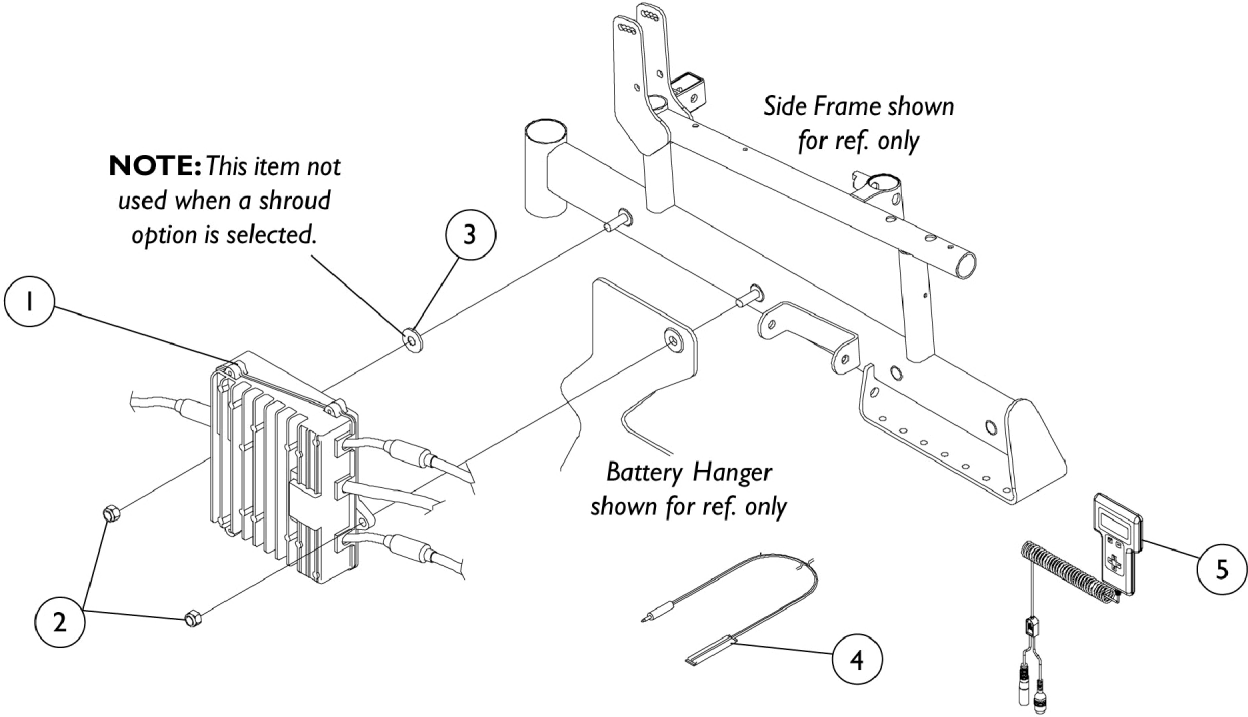

# MKIV Controller, Programmer & Attaching Hardware

Item Number	Note	Part Number	Description	Quantity Per	
				Package	Assembly
1	H	1105707-NLA	NLA - Controller, MKIV Quad Pulse	1	1
1	A,I	1095270-NLA	NLA - Controller, MKIV RII, Retro L.P.	1	1
1	B,J	1095269-NLA	NLA - Controller, MKIV RII, Retro	1	1
2		1026158	Locknut (5/16-18)	1	2
3		1079247	Washer, Flat (21/64 x 53/64 x 7/64")	1	1
4		1020818	Switch, Red Flex Ribbon (Tape) Reset	1	1
4	K	1123276	Kit, Switch, Black Egg Reset w/ Hook/Loop Adhesive Back Fastener & Attaching Screws (EGSBLK)	1	1
5		1109091-NLA	NLA - Programmer, Remote	1	1
	D	1064404-NLA	NLA - Virtual Service Modem Kit	1	1
	D	1091631-NLA	NLA - Virtual Service Software Kit	1	1
	D	1046117-NLA	NLA - Printer and Interface	1	1
	D,F	1091980-NLA	NLA - Disk, 3.5 H.D. Floppy with V.S. Software	1	1
	D,E,F	1095204-NLA	NLA - Cable, Virtual Service, Charger/Modem	1	1
	D,F	1091637-NLA	NLA - Adaptor, Null Modem	1	1
	D,F	1091636-NLA	NLA - Service Manual - V.S. Software Kit	1	1
	D,G	1026572-NLA	NLA - Paper, Printer	1	1
	D,G	1027280-NLA	NLA - Harness, Printer Wiring	1	1

NOTE: A - RII retro LP. controller after 4/30/00 and new RII joystick #1092610 serve as direct replacements for Joystick/Controller #1080953.  
 B - RII retro controller after 4/30/00 and new RII joystick #1092610 serve as direct replacements for Joystick/Controller #1080723.  
 D - Not Shown.  
 E - May be ordered as an individual part or is included in the "Virtual Service Modem Kit."  
 F - May be ordered as an individual part or is included in the "Virtual Service Software Kit."  
 G - May be ordered as an individual part or is included in "Printer and Interface."  
 H - MKIV Quad Pulse.  
 I - MKIV RII L.P. Retro (After 4/30/00) (EXCEL).  
 J - MKIV RII Retro (After 4/30/00) (RII and R2jr.).  
 K - Not Shown. After 5/23/04 the Egg Reset Switch became available as a service part and can be used as a direct replacement for the tape reset switch part # 1020818.