

Footplate with Hardware Assembly - J932A/J933A

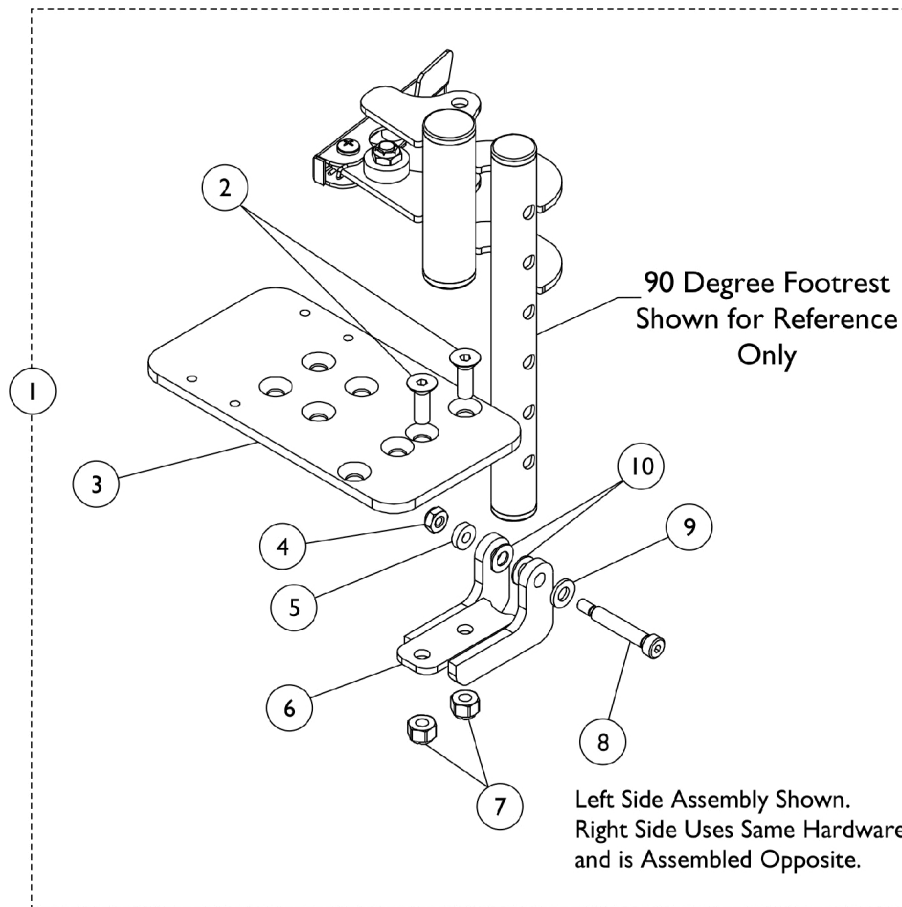

Footplate with Hardware Assembly - J932A/J933A

Item Number	Note	Part Number	Description	Quantity Per	
				Package	Assembly
1	A,B	1102493	Footplate Assembly with Hardware, Black (10" W)	1	1
1	A,B	1102494	Footplate Assembly with Hardware, Black (12-14" W)	1	1
2		1029545	Screw, Socket Flat Head (1/4-20 x 3/4")	1	2
3		1100988	Footplate, Black (3-1/4" W x 6" L) (10" W)	1	1
3		1100989	Footplate, Black (4-1/4" W x 6-1/2" L) (12" W)	1	1
4		1026035-NLA	NLA - Locknut (#10-24)	1	1
5		16347X000-NLA	NLA - Washer, Nylon (3/16 x 7/16 x 1/8")	1	1
6		1101020	Block, Hinge	1	1
7		1025736	Locknut (1/4-20)	1	2
8		1000212	Screw, Shoulder Hex Socket (1/4 x 1-1/4", #10-24)	1	1
9		1010398	Washer, Nylon (1/4 x 1/2 x 1/16")	1	1
10		40157X016-NLA	NLA - Washer (1/4 x 1/2 x 1/16")	1	2

NOTE: A - Left side assembly shown. Right side uses same hardware and is assembled opposite.
 B - Includes items 2-10.