

Battery Box for Group 22NF Batteries

NOTE: Gearless/ Brushless motors were made available on-chair as an option for Storm Arrow, Ranger X and Torque 11/2/98. On 7/1/99 Gearless/ Brushless motors became standard for Storm Arrow only.

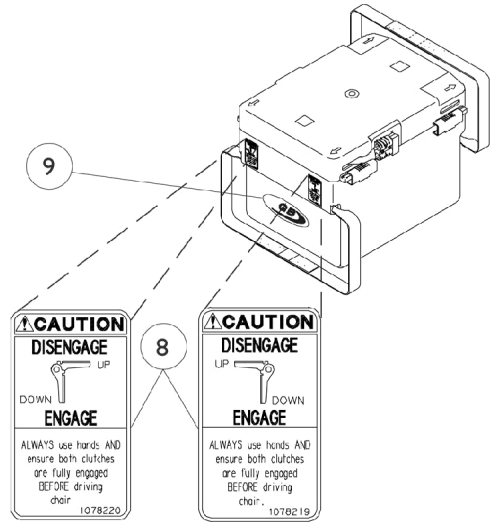
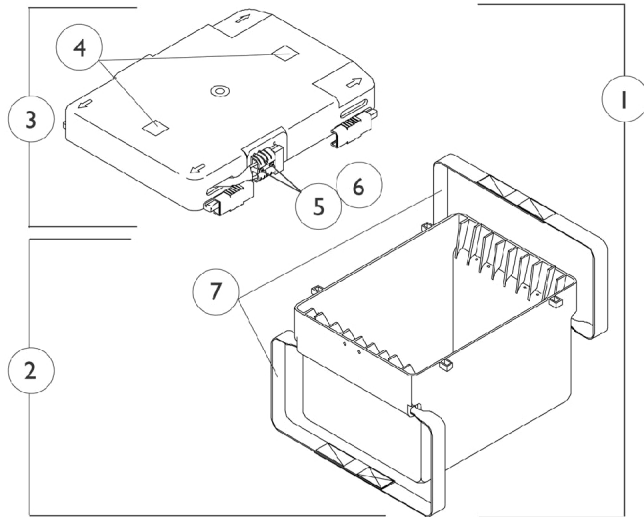

Left
Right
Free Wheel Caution Decal For Gearless/Brushless Only.

Battery Box for Group 22NF Batteries

NOTE: Gearless/ Brushless motors were made available on-chair as an option for Storm Arrow, Ranger X and Torque 11/2/98. On 7/1/99 Gearless/ Brushless motors became standard for Storm Arrow only.

Item Number	Note	Part Number	Description	Quantity Per	
				Package	Assembly
1		1050175	Battery Box Assembly	1	1
1		1083050-NLA	NLA - Battery Box Assembly with Decals, G/B	1	1
2		1049365	Battery Box Bottom with Straps	1	1
2		1083051-NLA	NLA - Battery Box Bottom with Straps and Decals, G/B	1	1
3		1049366	Battery Box Lid Assembly	1	1
3	A,C	1085410-NLA	NLA - Battery Box Lid Assembly	1	1
4		1070504-NLA	NLA - Fastener, Hook with Adhesive Back (1" W x 1" L)	1	2
5		1037901-NLA	NLA - Screw, Phillips Pan Head (#6-32 x 7/8")	1	1
6		P0870X050-NLA	NLA - Nut, Keps (#6-32)	1	1
7		50000X121	Strap, Battery Lift	1	2
8		1078219-NLA	NLA - Decal, Caution, Free Wheel - Right (G/B)	1	1
8		1078220-NLA	NLA - Decal, Caution, Free Wheel - Left (G/B)	1	1
9		1079259-NLA	NLA - Decal, Gearless/Brushless	1	1
	C	50000X123	Cable, Battery Jumper	1	1
	C,D	50000X166-NLA	NLA - Fuse - Buss 2-1/4" L (60 AMP)	1	1
	B,C,D	1085408-NLA	NLA - Fuse, G/B - Buss Automotive (30 AMP)	1	1
	C,E	1089385	Fuse, MIDI (Non-G/B & G/B) (80 AMP)	1	1

NOTE: A - After 12/7/99 Gearless/Brushless models use part number 1049366 battery box lid assembly and serves as a direct replacement for all chairs manufactured before 12/8/99 as well.
 B - Gearless/Brushless uses both 60 Amp and 30 Amp inline fuses.
 C - Not Shown.
 D - Before 12/8/99
 E - After 12/7/99