

Motor GB and Attaching Hardware Gearless/Brushless

NOTE: Gearless/ Brushless motors were made available on-chair as an option for Storm Arrow, Ranger X and Torque 11/2/98. On 7/1/99 Gearless/ Brushless motors became standard for Storm Arrow only.

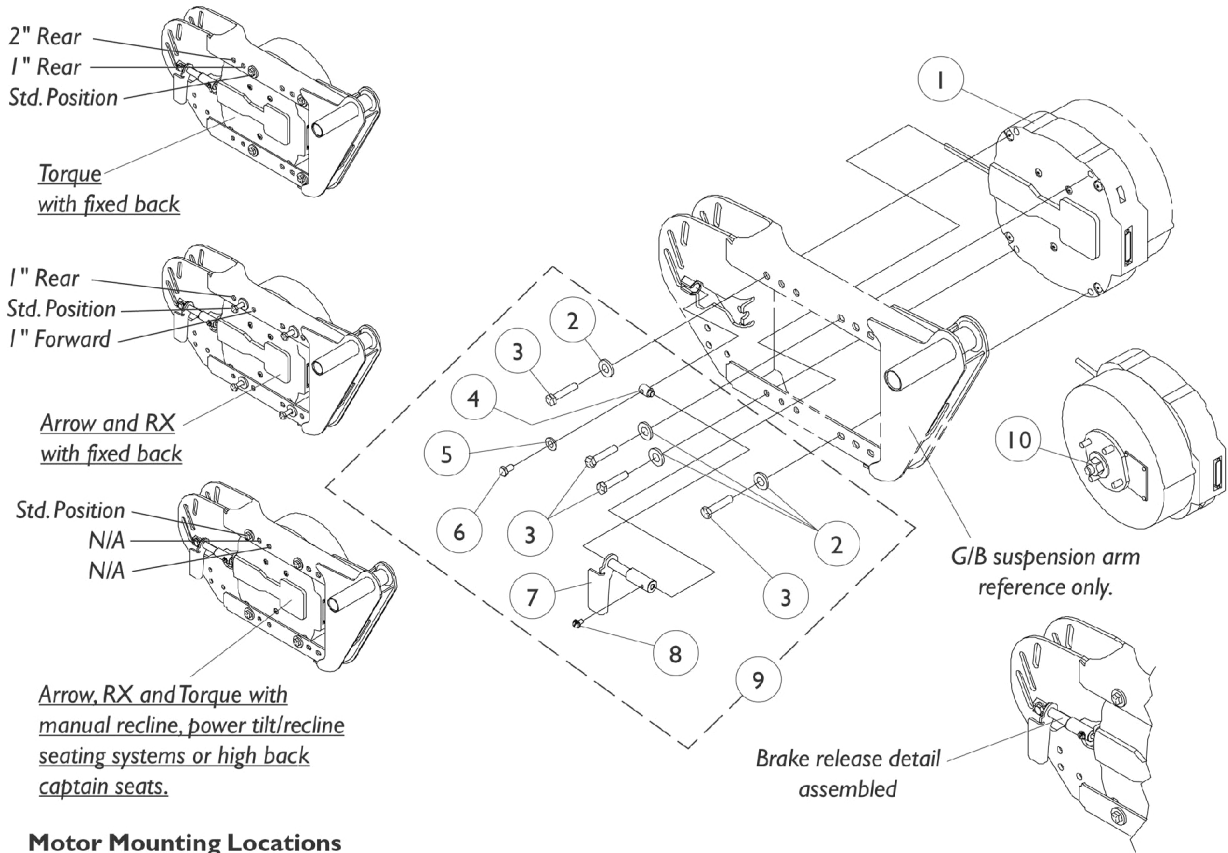

Motor Mounting Locations

Motor GB and Attaching Hardware Gearless/Brushless

NOTE: Gearless/ Brushless motors were made available on-chair as an option for Storm Arrow, Ranger X and Torque 11/2/98. On 7/1/99 Gearless/ Brushless motors became standard for Storm Arrow only.

Item Number	Note	Part Number	Description	Quantity Per	
				Package	Assembly
1	D	See Note	See Footnote	1	1
1	D	See Note	See Footnote	1	1
2		1079247	Washer, Flat (21/64 x 53/64 x 7/64")	1	4
3		1085633-NLA	NLA - Screw, Hex Head w/ Patch (M8 x 1.25 x 45mm)	1	4
4		1078213-NLA	NLA - Pin, Alignment, Black	1	1
5		1018739	Washer (1/4 x 5/8 x 3/32")	1	1
6		1078214	Screw, Hex Head w/ Patch (1/4-20 x 1/2")	1	1
7		1079242-NLA	NLA - Handle, Brake Release, Black (G/B) - Right	1	1
7		1079243-NLA	NLA - Handle, Brake Release, Black (G/B) - Left	1	1
8		1078228-NLA	NLA - Screw, Slotted Hex Head w/ Patch (#10-32 x 5/16")	1	1
9	A	1079264-NLA	NLA - Hardware, Motor Attaching (G/B) - Right	1	1
9	A	1079265-NLA	NLA - Hardware, Motor Attaching (G/B) - Left	1	1
10	B	1112955-NLA	NLA - Kit, Repair, GB Motor, Anti-Rattle with Instruction Sheet	2	1
	C	1112828	Instruction Sheet, GB Motor Anti-Rattle Repair Kit	1	1
	C	1110531	Instruction Sheet, GB Motor Replacement For 3G Storm	1	1

NOTE: A - Includes items 2-8
 B - Service Kit for two motors include 2 each hex head nuts, washers, hub keys and O-rings. Individual components are not available.
 C - Not shown
 D - Part is no longer available as a service part.