

# 30 and 40 Liter Reservoirs

## Final Assembly - Standard, Low, and High Flow

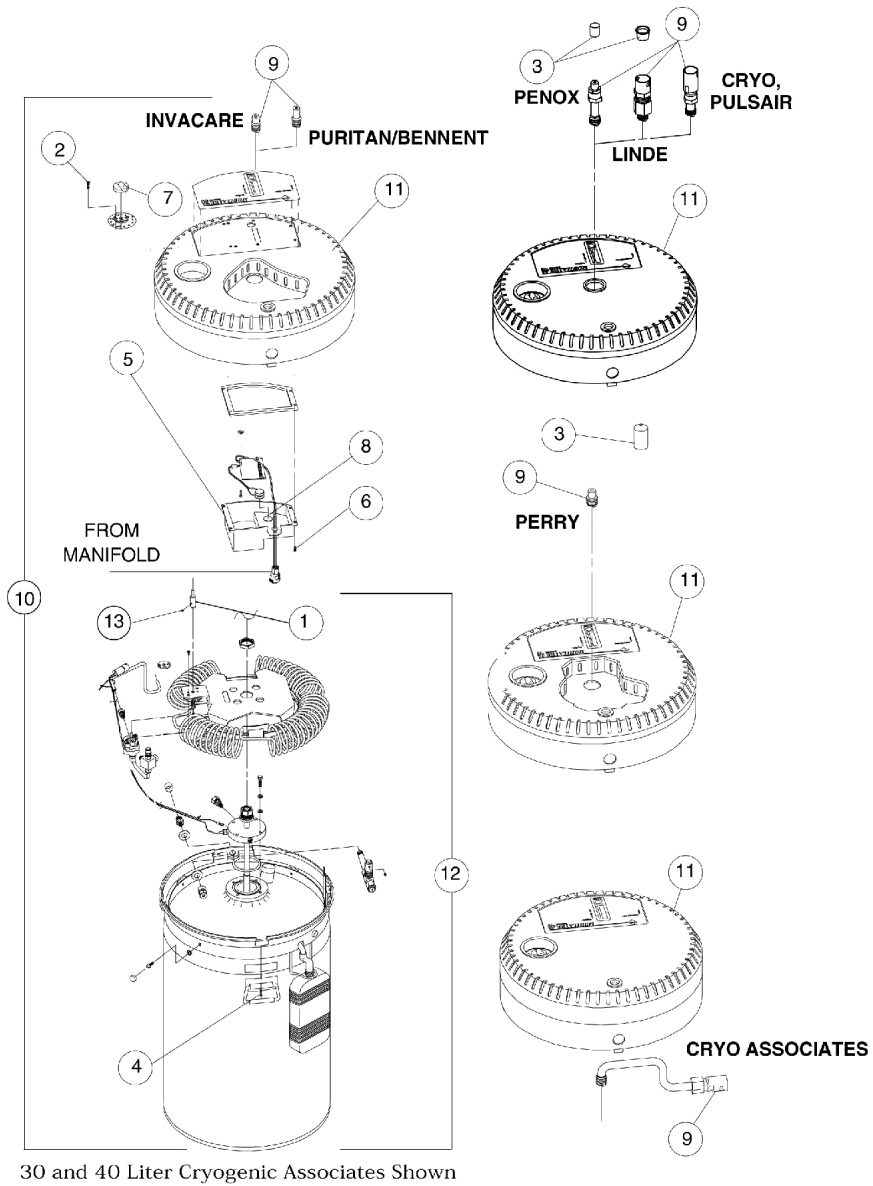

## 30 and 40 Liter Reservoirs

### Final Assembly - Standard, Low, and High Flow

Item Number	Note	Part Number	Description	Quantity Per	
				Package	Assembly
1	A	420038M-NLA	NLA - Extension, Select Shaft Cryogenic Associates {Caire Only}	1	1
2	B	424080M-NLA	NLA - Screw, Flat Head (#6-32 x 5/8") For all models EXCEPT Cryogenic Associates (Caire)	1	1
2	A	424108M-NLA	NLA - Screw, Flat Head (#6-32 x 1-1/2") For Cryogenic Associates (Caire) Models Only	1	1
3	C	2002683-NLA	NLA - Cap, Plug, Black	1	1
3	D	422041M-NLA	NLA - Cap, Plug	1	1
4		424105M-NLA	NLA - Screw, Truss Head (#6-32 x 3/4")	1	5
5		420044M-NLA	NLA - P.C. Board Enclosure	1	1
6		424030M-NLA	NLA - Screw, Phillips Pan Head (#6-32 x 5/16")	1	4
7		520049M-NLA	NLA - Knob, 12 Position	1	1
8	E	214004M-NLA	NLA - Ty-Wrap (4")	1	1
8	F	1054436-NLA	NLA - Loop Adhesive Back, 3/4" Round	1	1
	P	421097M-NLA	NLA - Coupling, 90 Degree DISS	1	1
9	G	425301M-NLA	NLA - Posi-Lok Quick Disconnect (QD) Coupler Invacare, Perry Oxygen Systems	1	1
9	H	2001917-NLA	NLA - Coupler, Posi-Lok Quick Disconnect (QD) Puritan-Bennett	1	1
9	H,I,J	2003055-NLA	NLA - Coupler, Posi-Lok Quick Disconnect (QD) Poppet Assembly, Puritan-Bennett - After 2/95	1	1
9	K	425303M-NLA	NLA - Posi-Lok Quick Disconnect (QD) Coupler Cryo2 / Pulsair	1	1
9	A	425305M-NLA	NLA - Posi-Lok Quick Disconnect (QD) Coupler Cryogenic Associates (Caire)	1	1
9	L	425302M-NLA	NLA - Posi-Lok Quick Disconnect (QD) Coupler Penox	1	1
9	M	425308M-NLA	NLA - Posi-Lok Quick Disconnect (QD) Coupler Linde {Mark}	1	1
10	N	See Chart	See Chart	1	1
11	O	See Chart	See Chart	1	1
12	P	See Chart	See Chart	1	1
13	A	1069419-NLA	NLA - Screw Set (#6-32) Used on CA models only	1	1

NOTE: A - For Cryogenic Associates (Caire) models only.  
 B - For all models except Cryogenic Associates (Caire)  
 C - For Invacare and Perry Oxygen Systems, Puritan Bennet, and Penox models. Models - 30/40  
 D - For CryO2/Pulsair, Cryogenic Associates (Caire) and Linde (Mark). Models - 30/40  
 E - Before 7/18/00  
 F - After 7/19/00  
 G - Invacare and Perry Oxygen Systems  
 H - Puritan-Bennett  
 I - Poppet Assembly  
 J - After 2/95  
 K - CryO2/Pulsair  
 L - Penox  
 M - Linde (Mark)  
 N - See Reservoir, Final Assembly Model Numbers - 30/40  
 O - See Top Shroud Assembly Model Numbers - 30/40  
 P - Reservoir, System Neutral Model Numbers - 30/40