

# Backrest Bracket Mounting Hardware, Sling Back Only for - DLX-IN200, DLX-IN500, DLX-OUT500, GLM-CONX4

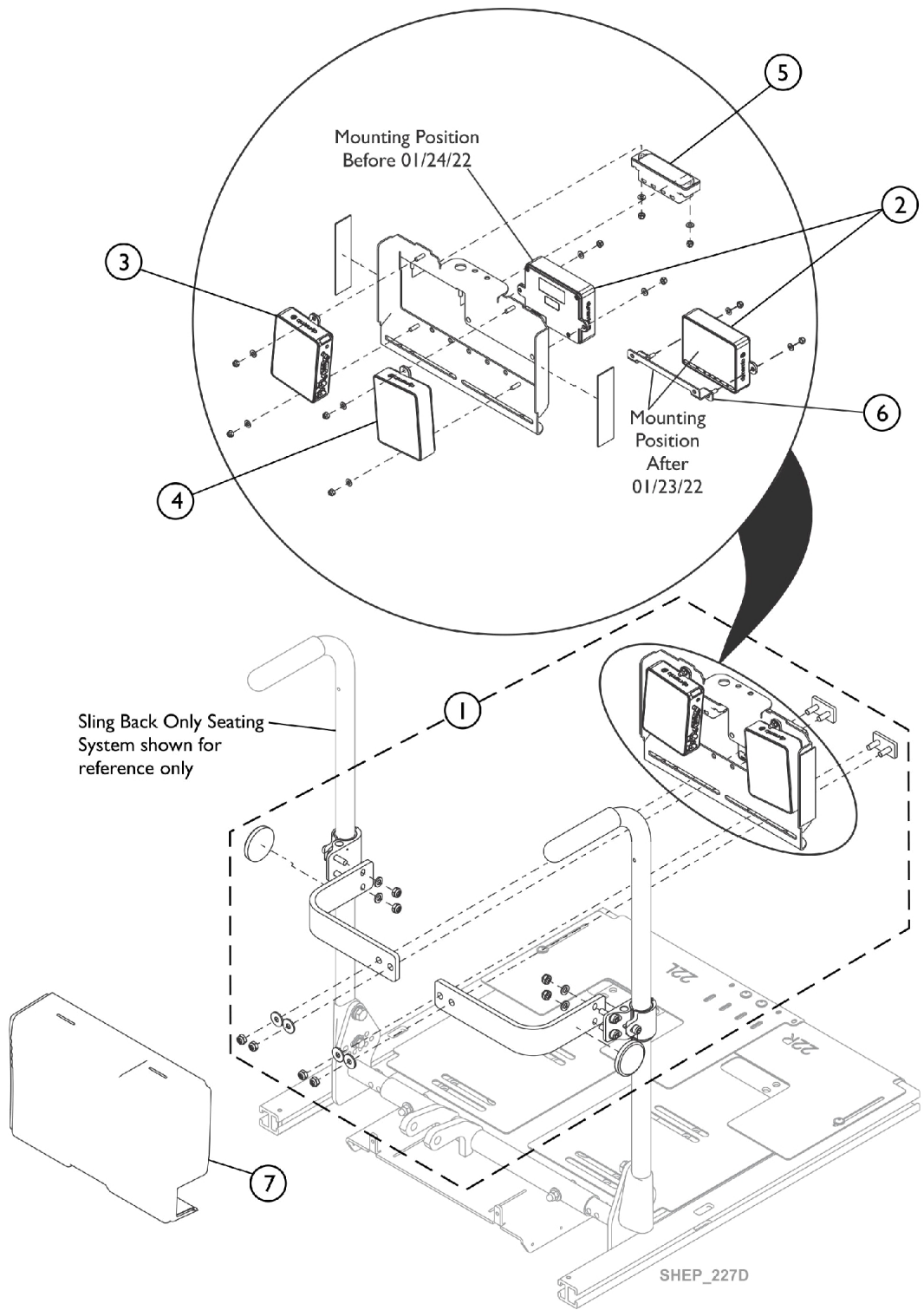

## Backrest Bracket Mounting Hardware, Sling Back Only for - DLX-IN200, DLX-IN500, DLX-OUT500, GLM-CONX4

Item Number	Note	Part Number	Description	Quantity Per	
				Package	Assembly
1		60102477	Kit, Backrest Bracket Mounting Hardware, Sling Back for - DLX-ACT400, DLX-IN500, GLM-CONX4	1	1
2		60124980	Kit, LiNX DLX-IN200 Input Module (INPUT)	1	1
3		60102474	Kit, LiNX DLX-IN500 Input Module (INPUT)	1	1
4	B,C	60108452	Kit, LiNX DLX-OUT500 Output Module (OUT500)	1	1
5		60102473	Kit, LiNX CONX4 4-way Expansion Block	1	1
6	D	60132728	Kit, Bracket Assembly, LiNX, Black	1	1
7		60102472	Kit, Shroud Cover, Module	1	1
	A	60102523	Kit, Sip-N-Puff, 16" Fixed (PKG32666) Includes: (3) Air Tube Straws, (2) Saliva Traps, Tubing, Pivot Shaft/Flexible Metal Gooseneck Assembly, and Extruded Figure "8" Clamp to fit 7/8" Wheelchair Frame Tubing. Extruded Back Cane Adapter Clamp.	1	1
<p>NOTE: A - Not Shown            B - Item #4 includes LiNX DLX-OUT500 Output Module, 2 ea. Washer (M4 4.3 x 9 x .8), 2 ea. Locknut (M4), 1 ea. LiNX Bus Cable (PWH) 300mm 11-13/16" (GLM-BUS030)            C - Item #3 LiNX DLX-IN500 Input Module does not include the LiNX Bus Cable (PWH) 300mm 11-13/16" (GLM-BUS030).            D - Item 6 used after 01/23/22</p>					