

BAR750

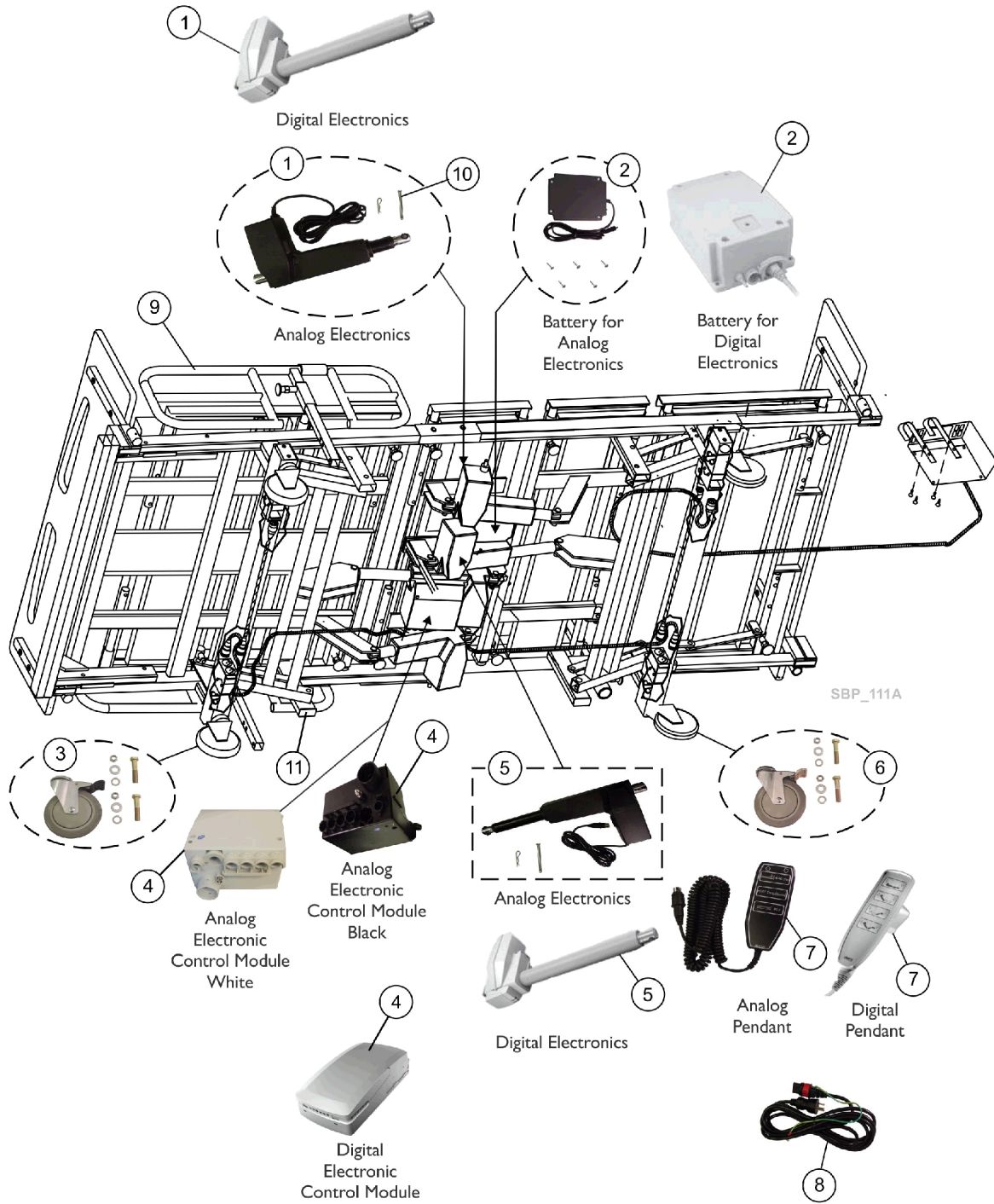

BAR750

Item Number	Note	Part Number	Description	Quantity Per	
				Package	Assembly
1	H	1147492	Actuator Motor, Back Rest/Leg Lift, Analog	1	2
1	J	60129095	Actuator Motor, Back Rest/Leg Lift, Digital	1	2
2	A,I	1147496-NLA	NLA - Battery (9V) with Hardware	1	1
2	J	60129096	Battery, KB19 Lead-Acid (For Digital)	1	1
3	B	1147497	Steering Caster with Hardware	1	1
4	K	1147490	Module, Electronic Control, White, Analog	1	1
4	J	60129093	Module, Electronic Control, White, Digital	1	1
5		1147491	Actuator Motor, High/Low, Analog	1	1
5	J	60129094	Actuator Motor, High/Low, Digital	1	1
6	C	1147498	Locking Caster with Hardware	2	1
7		1147488	Pendant Control, Three Function, Analog	1	1
7	J	60129092	Pendant Control, Three Function, Digital	1	1
8		1147489	Cord, Power	1	1
9	D	1147493	Rails, Side	2	1
10	E	1147495	Package, Clevis Pin w/ Rue Clip	10	1
11		1147494-NLA	NLA - Plug Button, Black	10	1
12	F	1165872-NLA	NLA - Package, Release Knobs, Bed Rails/Extensions	5	1
	G	1165871-NLA	NLA - Kit, Footboard Extensions - Right/Left	1	1

NOTE: A - Includes 1) Battery (9V) and 5) Screws.
 B - Includes 2) Steering Casters, 2) Locknuts, 2) Flat Washers, 2) Lock Washers and 2) Screws.
 C - Includes 2) Locking Casters, 2) Locknuts, 2) Flat Washers, 2) Lock Washers and 2) Screws.
 D - Includes 2) Side Rails.
 E - Includes 5) Clevis Pins and 5) Rue Clips.
 F - These are release knobs for the footboard and headboard extensions and the side bed rail. Sold in packages of five.
 G - Not shown in illustration.
 H - One Actuator is for the Head End (Back Rest) and the other for the Foot End (Leg Lift).
 I - Battery is No Longer Available from Invacare but can be purchased from Gendron Inc. 1-800-537-2521.
 J - Used for Digital components that replaced Analog starting with serial number 111016111.
 K - Part number 1147490 Electronic Analog Control Module was changed from Black color to white.