

Trapeze Floor Stand

Model 7714 (For use with 7740 and 7750 Trapeze)

Model 7714P (For use with 7740A and 7740P Trapeze)

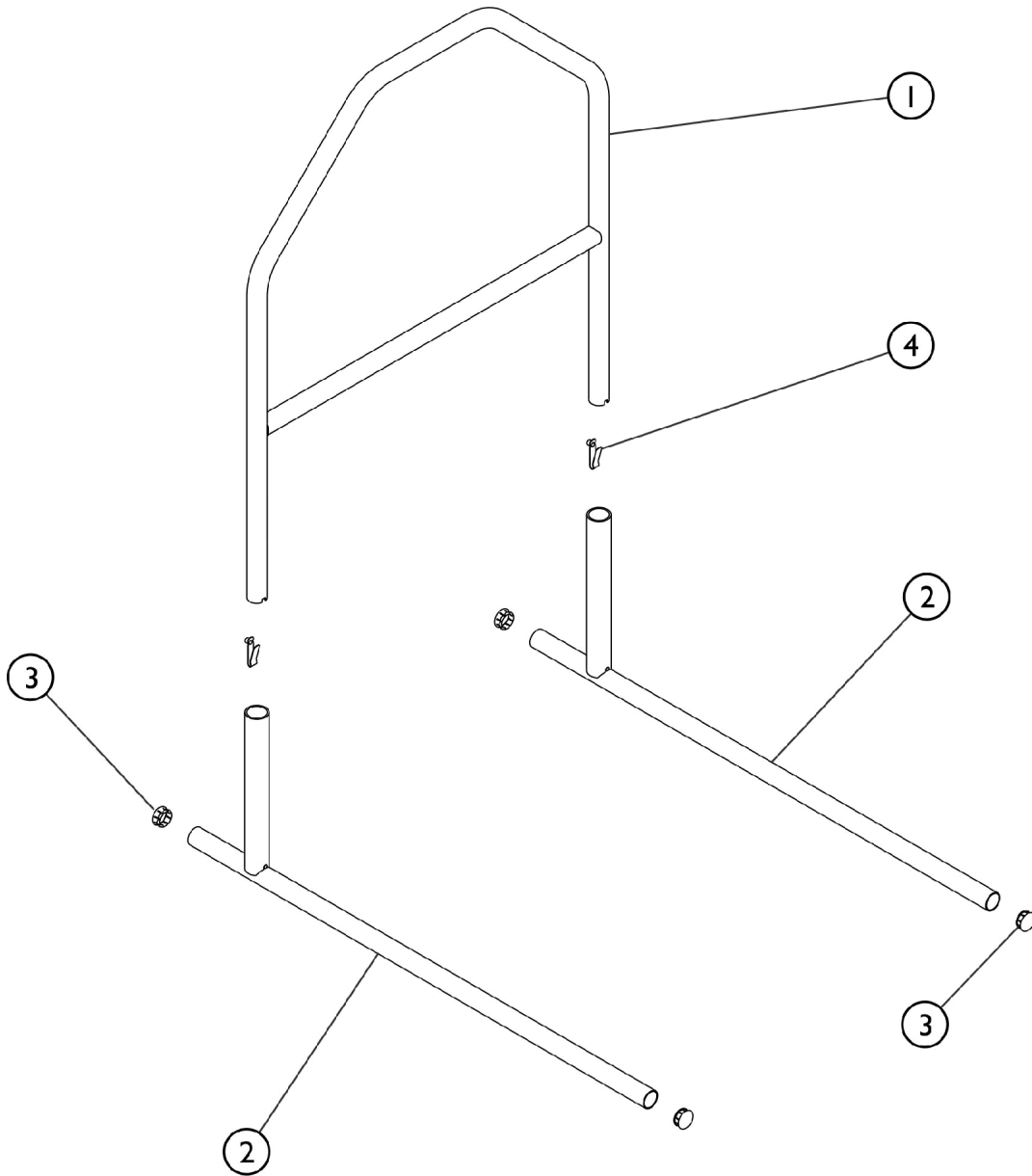

SBP_060A

Trapeze Floor Stand

| Item Number | Note | Part Number | Description | Quantity Per | |
|-------------|------|---------------|-----------------------------------|--------------|----------|
| | | | | Package | Assembly |
| 1 | B | 17140X000-NLA | NLA - Frame, "A", Chrome | 1 | 1 |
| 1 | C | 1135734-NLA | NLA - Frame, "A" , Grey | 1 | 1 |
| 2 | B | 17141X000-NLA | NLA - Leg, Chrome | 1 | 2 |
| 2 | C | 1135735-NLA | NLA - Leg, Grey | 1 | 2 |
| 3 | | 17290X000-NLA | NLA - Plug Button, Metal (1-1/4") | 1 | 4 |
| 4 | D,A | 48806X011-NLA | NLA - Button, Snap | 1 | 2 |
| 4 | | 1094945 | Button, Snap | 1 | 2 |

NOTE: A - No longer available, refer to Part #1094945 for replacement on 7714 and 7714P.
 B - Before 9/9/05.
 C - After 9/8/05.
 D - As of 3/8/01, spring no longer needed replace with 1094945.