

MicroAIR 1000 Mattress

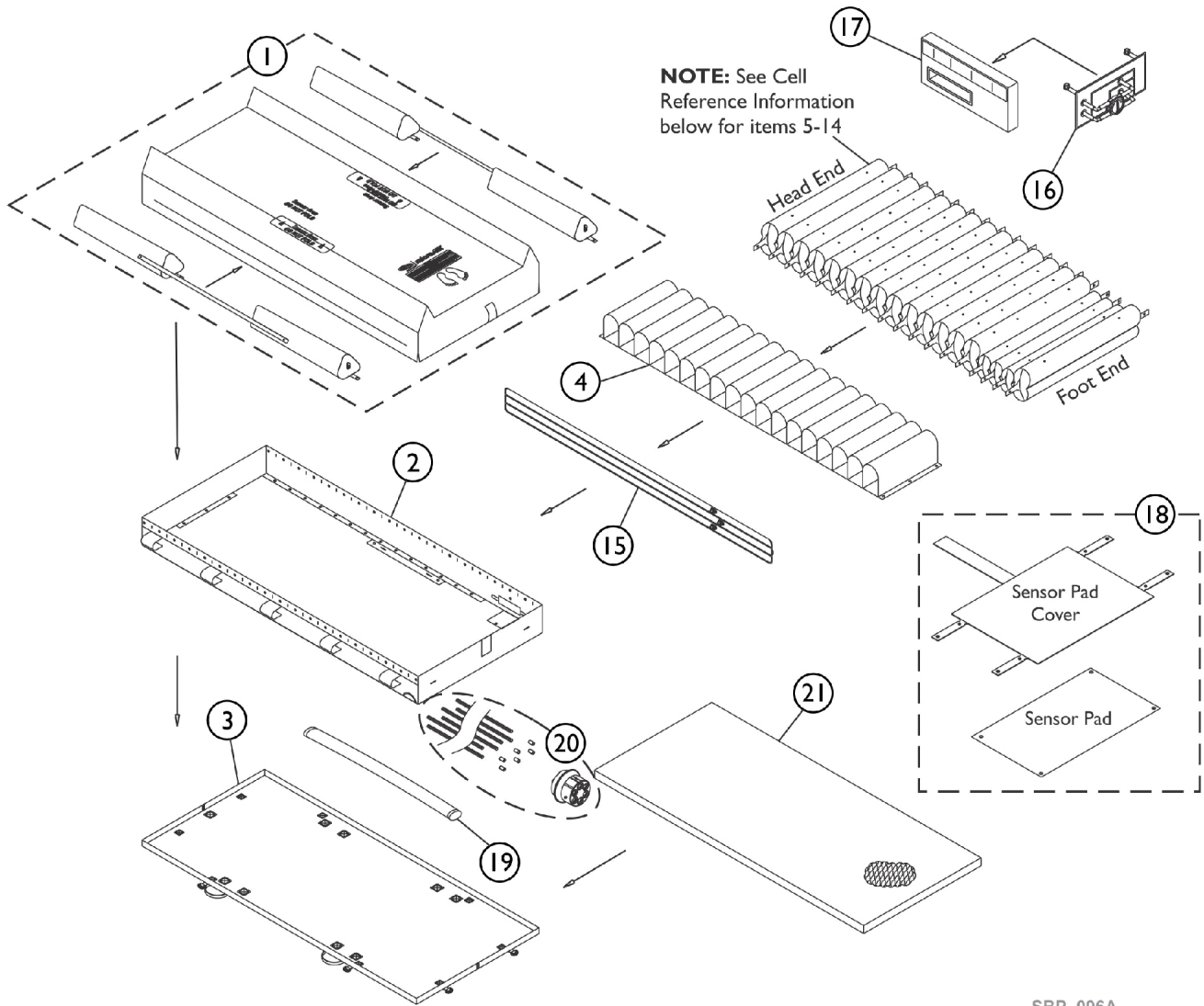

SBP_096A

Cell Position	1	2	3	4	5	6	7	8	9	10	11	12	13	14	15	16	17	18
Item Number	5	6	7	8	9	10	8	9	10	8	9	10	8	9	11	12	13	14

← Head End - Cell Reference Information - Foot End →

MicroAIR 1000 Mattress

Item Number	Note	Part Number	Description	Quantity Per	
				Package	Assembly
1		60124655	Top Cover w/ Right and Left Bolsters	1	1
2		60124656	Middle Cover	1	1
3		60124657	Bottom Cover	1	1
4		60124658	Belt Set	1	1
5,6,7		60124659	Head Vent Cell Set (3 Cells)	1	3
8		60124660	Vent Cell (Blue)	1	4
9		60124661	Vent Cell (White)	1	4
10		60124662	Vent Cell (Green)	1	3
11,12,13		60124663	Foot Cell Set (3 Cells)	1	3
14		60124664	Foot Cell (18th Single Cell)	1	1
18		60124667	Sensor Pad and Cover	1	1

Item #15 (Side Rail), #16 (Foot Side Rail 14-1/2" x 7"), #17 (Side Bolster Foam 17-3/4" x 8" x 2"), #19 (Hose Sleeve), #20 (Connecting Tube Set), and #21 (M1000 Foam Set 78" x 34" x 2") are not available to order