

MicroAIR 600 Mattress

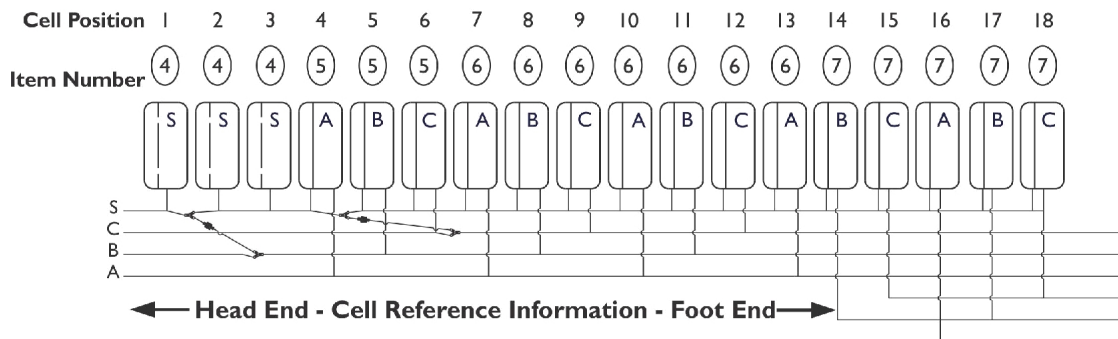
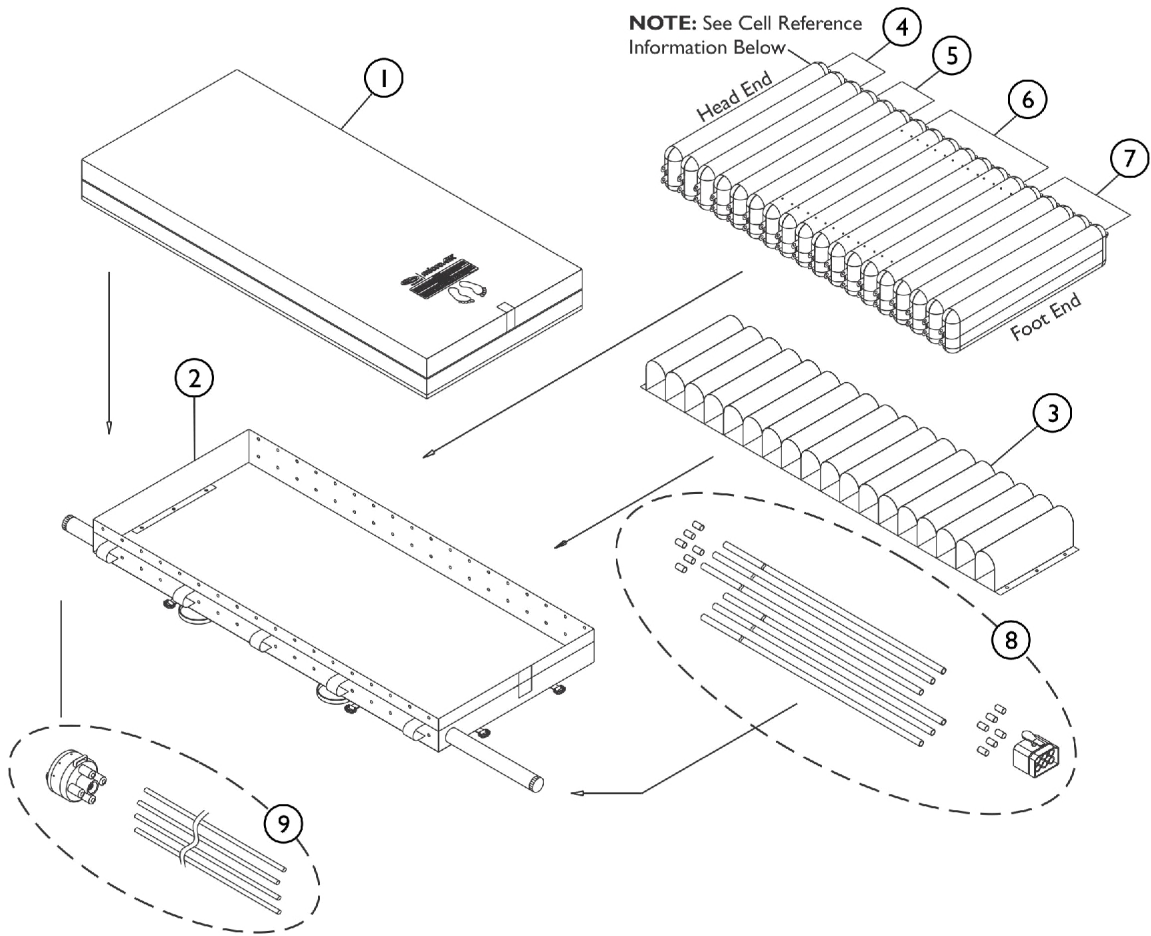

NOTE:

Letter S = Static Cells. Remain Inflated.

Letters A, B and C = Alternating Sequence of the Cells.

Example:

When mattress is in 3-I alternating mode, cells marked "A", "B", and "C" will be in deflation mode in rotation.

1st cycle = A and B cells inflate, C cells deflate.

2nd cycle = A and C cells inflate, B cells deflate.

MicroAIR 600 Mattress

Item Number	Note	Part Number	Description	Quantity Per	
				Package	Assembly
1		60124618	Top Cover	1	1
2		60124619	Bottom Cover	1	1
3		60124255	MA600 Belt Set	1	1
4		60124256	MA600 Head Cell	1	3
5		60124257	MA600 Non-Vented Air Cell	1	3
6		60124258	MA600 Vent Cells	1	7
7		60124259	MA600 Foot Cells	1	5
8		60124616	MA600 Connecting Tube Set	1	1
9		60124617	MA600 CPR Set	1	1
	A	60124614	Tee Connector, Barbed, for Tubing, (3/8"x3/8"x3/8")	1	1
	A	60124238	Tee Connector, Barbed, for Tubing, (1/2"x1/2"x1/2")	1	1
	A	60124240	Filter - MA500 / MA600	1	1
	A	60124175	Filter Cover - MA500 / MA600	1	1
	A	60124246	Rubber Foot Pad	1	1
	A	60124247	Fuse	1	1
	A	60124248	Spring Hook Set, M18 Series	1	1
	A	60124250	Connector to Pump, 6 Po	1	1
	A	60124615	Gray Tubing (Per Meter) (3/8")	1	1
	A	60124611	CPR Valve, High Sensitivity Quick Inflate (Shoer Version)	1	1

NOTE: A - Not Shown