

MicroAIR 500 Mattress

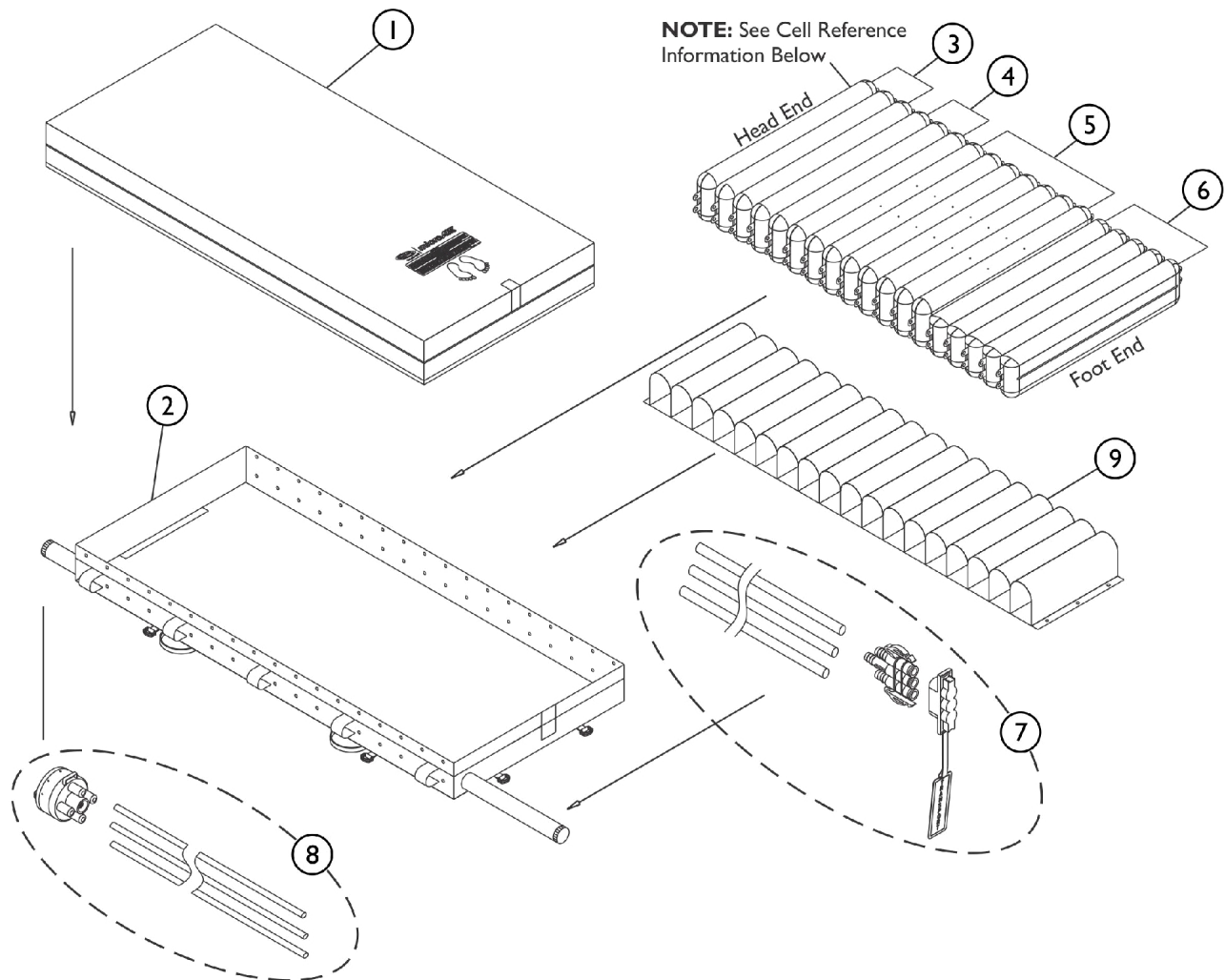

Cell Position	1	2	3	4	5	6	7	8	9	10	11	12	13	14	15	16	17	18
Item Number	3	3	3	4	4	4	5	5	5	5	5	5	5	6	6	6	6	6
Cell Type	S	S	S	A	B	A	B	A	B	A	B	A	B	A	B	A	B	A

S
A
B

10

SBP_093A

← Head End - Cell Reference Information - Foot End →

NOTE:
 Letter S = Static Cells. Remain Inflated
 Letters A and B = Alternating Sequence of the Cells.

MicroAIR 500 Mattress

Item Number	Note	Part Number	Description	Quantity Per	
				Package	Assembly
1		60124603	Top Cover	1	1
2		60124604	Bottom Cover	1	1
3		60124607	Head Cell for MA500 Mattress(No LAL)	1	3
4		60124608	Body Cell for MA500 Mattress(No LAL)	1	3
5		60124258	MA600 Vent Cells	1	7
6		60124609	Foot Cell for MA500(No LAL)	1	5
7		60124605	Connecting Tube Set for MA500	1	1
8		60124612	CPR Set for MA500	1	1
9		60124606	Belt Set for MA500 Mattress	1	1
10		60124610	Mattress Muffler for MA500	1	1
	A	60124173	Filter - MA500 / MA600	1	1
	A	60124175	Filter Cover - MA500 / MA600	1	1
	A	60124176	Hook Set, MA500	1	1
	A	60124611	CPR Valve, High Sensitivity Quick Inflate (Shoer Version)	1	1
	A	60124613	Trio Coupling Connector, MA500	1	1

NOTE: A - Not Shown