

# Tilt Angle Sensor Assembly w/ Hardware

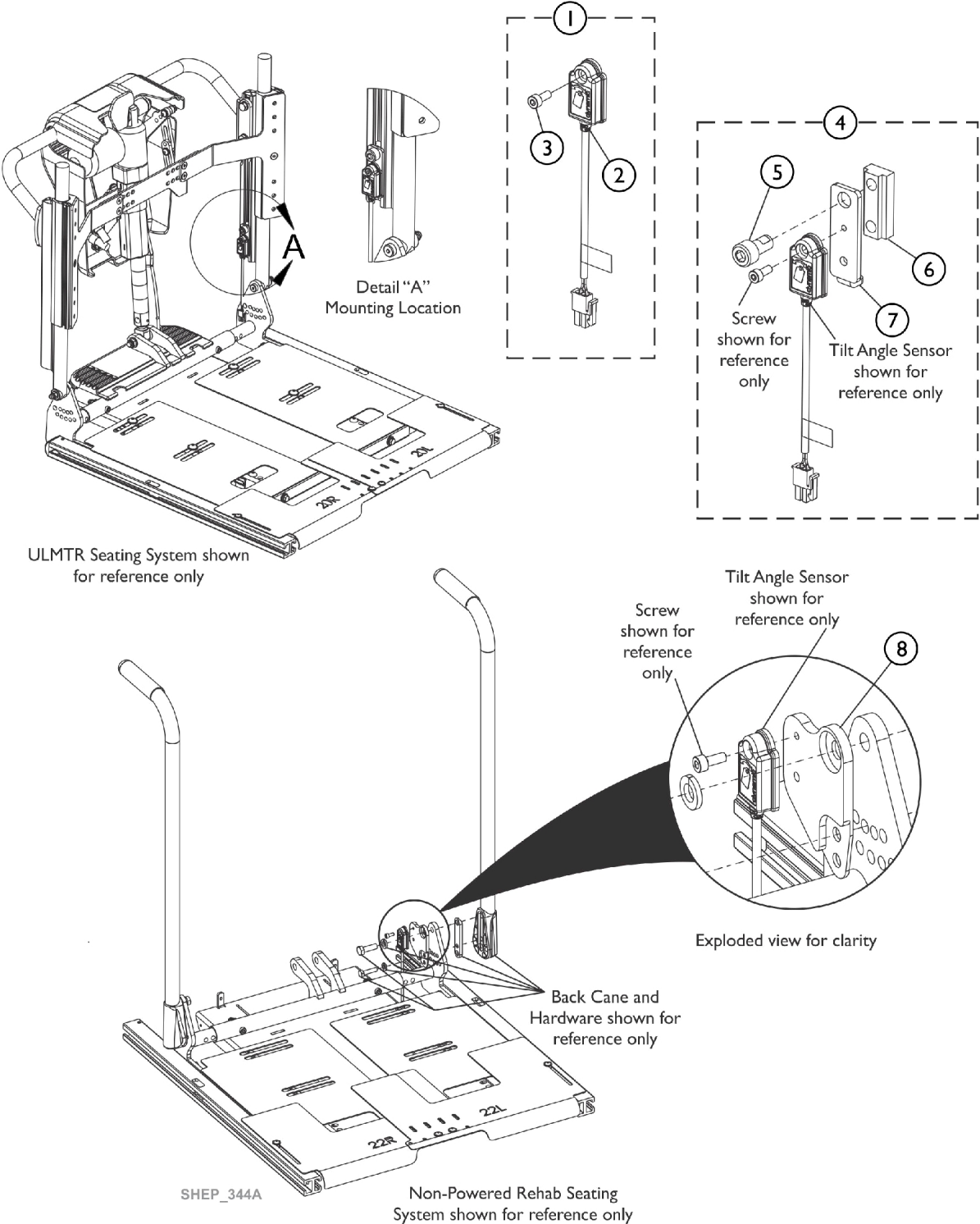

## Tilt Angle Sensor Assembly w/ Hardware

Item Number	Note	Part Number	Description	Quantity Per	
				Package	Assembly
1	A	60125835	Kit, Tilt Angle Sensor w/ Hardware	1	1
2			Tilt Angle Sensor w/ Connector Assembly	1	1
3			Screw, Socket Head Cap (M4 x 0.7 x 10mm)	1	1
			Sheet, Insert Parts Service	1	1
4	B	60124877	Kit, Tilt Angle Sensor Bracket w/ Hardware, ULMTR	1	1
5			Screw, Socket Head Cap w/ Patch (M8 x 1.25 x 16mm)	1	1
6			Nut, Tee (M8 x 1.25mm) 2 Hole	1	1
7			Plate, Tilt Sensor Mounting	1	1
	C	60124958	Sheet, Insert Parts Service	1	1
8			Kit, Tilt Angle Sensor Bracket, ULMT	1	1
			Bracket, Sensor Angle Non-Recline	1	1
			Sheet, Insert Parts Service	1	1
NOTE: A - Includes items 2 and 3 B - Used for ULMTR. Includes items 5-7 C - Used for Non-Recline Rehab Seating System.					