

# Pivot Slide Tube with Footplate

## GT94H and T94H Series Legrest

**NOTE:** Pivot Slide Tube and Footplate is attached to Footrest Support using the spring button or bolt thru hardware. See chart titled, "Pivot Slide Tube Attaching Hardware."

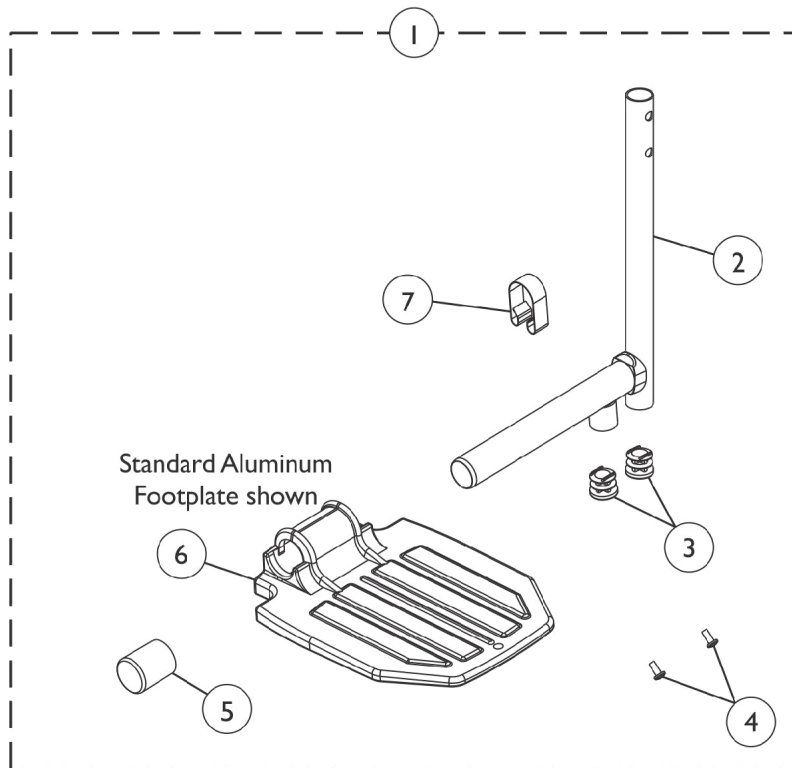
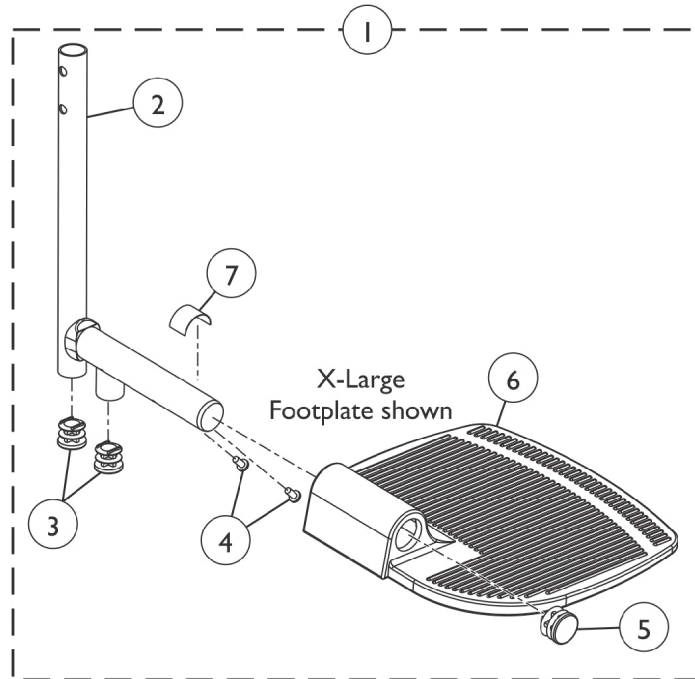

# Pivot Slide Tube with Footplate

## GT94H and T94H Series Legrest

**NOTE: Pivot Slide Tube and Footplate is attached to Footrest Support using the spring button or bolt thru hardware. See chart titled, "Pivot Slide Tube Attaching Hardware."**

Item Number	Note	Part Number	Description	Quantity Per	
				Package	Assembly
1	A	See Chart	Legrest Pivot Slide Tube with Footplate	1	1
2		1110301	Pivot/Slide Tube w/ Plug Button, Legrest, Black	1	1
2		1110300-NLA	NLA - Pivot/Slide Tube w/ Plug Button, Legrest, Chrome	1	1
3		1027097	Plug Button, Black (3/4")	2	2
4		40120X001	Screw, Phillips Pan Head (#8-32 x 3/8")	2	2
5		1016346	Cap, End, Tube, Black (7/8")	1	1
5	B	1027095	Plug Button, Black (7/8")	1	1
6		1015178	Footplate, Composite, Black (6" W x 7-53/64" L)	1	1
6	F	1192674	Footplate, Composite, Black (6" W x 7-53/64" L)	1	1
6		44200X059	Footplate, Aluminum, Small, Black (6-3/4" W x 6" L)	1	1
6		44200X027	Footplate, Aluminum, Medium, Black (7-3/4" W x 6" L)	1	1
6	B	44200X025	Footplate, Aluminum, Extra Large, Black - Right (8" W x 8-1/2" L)	1	1
6	B	44200X026	Footplate, Aluminum, Extra Large, Black - Left (8" W x 8-1/2" L)	1	1
7	D	1006981	Spring, Tension	1	1
7	B,E	1036123	Spring, Leaf	1	1
	C	See Chart	Bolt Through and Spring Button Kits	1	1

**NOTE:** A - Includes items 2-7.  
 B - For use on extra large footplate assembly.  
 C - Not Shown.  
 D - Use with Standard Footplates.  
 E - Use one or more leaf springs per assembly as required such that footplate may be moved by hand to the up-right position and remain in place.  
 F - Used for GT94HC model Front Riggings and T94HC model Front Riggings as of 5/16/19.

# Pivot Slide Tube with Footplate

## GT94H and T94H Series Legrest

**NOTE: Pivot Slide Tube and Footplate is attached to Footrest Support using the spring button or bolt thru hardware. See chart titled, "Pivot Slide Tube Attaching Hardware."**

### Legrest Pivot Slide Tube with Footplate

Current Model Number	Chair Width	Footplate Style	Frame Side	Part Number
GT94HA/T94HA/T94HAB - Black	16-22"	Aluminum	Right	1110315
GT94HA/T94HA/T94HAB - Black	16-22"	Aluminum	Left	1110316
T94HA/T94HAB - Chrome	16-22"	Aluminum	Right	1110317-NLA
T94HA/T94HAB - Chrome	16-22"	Aluminum	Left	1110318-NLA
GT94HA/T94HA/T94HAB - Black	16-22"	Extra Large	Right	1110348
GT94HA/T94HA/T94HAB - Black	16-22"	Extra Large	Left	1110349
T94HA - Chrome	16-22"	Extra Large	Right	1110350-NLA
T94HA - Chrome	16-22"	Extra Large	Left	1110351-NLA
T94HS/T94HSB - Black	14-15"	Aluminum	Right	1110365
T94HS/T94HSB - Black	14-15"	Aluminum	Left	1110366
T94HS/T94HSB - Chrome	14-15"	Aluminum	Right	1110367-NLA
T94HS/T94HSB - Chrome	14-15"	Aluminum	Left	1110368-NLA
GT94HC/T94HC/T94HCB - Black	16-22"	Composite	Right	1110311
GT94HC/T94HC/T94HCB - Black	16-22"	Composite	Left	1110312
T94HC/T94HCB - Chrome	16-22"	Composite	Right	1110313-NLA
T94HC/T94HCB - Chrome	16-22"	Composite	Left	1110314-NLA

NOTE: 2" and 4" Longer Pivot Slide Tube with Footplate Assembly is not available.

# **Pivot Slide Tube with Footplate**

## **GT94H and T94H Series Legrest**

**NOTE: Pivot Slide Tube and Footplate is attached to Footrest Support using the spring button or bolt thru hardware. See chart titled, "Pivot Slide Tube Attaching Hardware."**

### **Bolt Through and Spring Button Kits**

Style	Part Number	Quantity Per Package	Quantity Per Footrest	Quantity Per Legrest
Spring Button Hardware Kit	1188335 See Note(s) A	2	2	4
Bolt Through Hardware Kit	1101776 See Note(s) A	2	2	2
Tool Kit	1058407 See Note(s) B	1	N/A	N/A
NOTE: A - Kit includes 2 ea. Double Spring Buttons B - Kit includes allen wrench, key, and open end wrench. The Bolt Thru Hardware uses the Tool Kit for installation.				