

Pivot Slide Tube with Footplate

T93H Series and T94H Series

NOTE: If your chair was built with a serial # starting with "03H" or "03I", please contact an Invacare Parts Specialist for replacement parts at 1-800-333-6900 Ext. 3722.

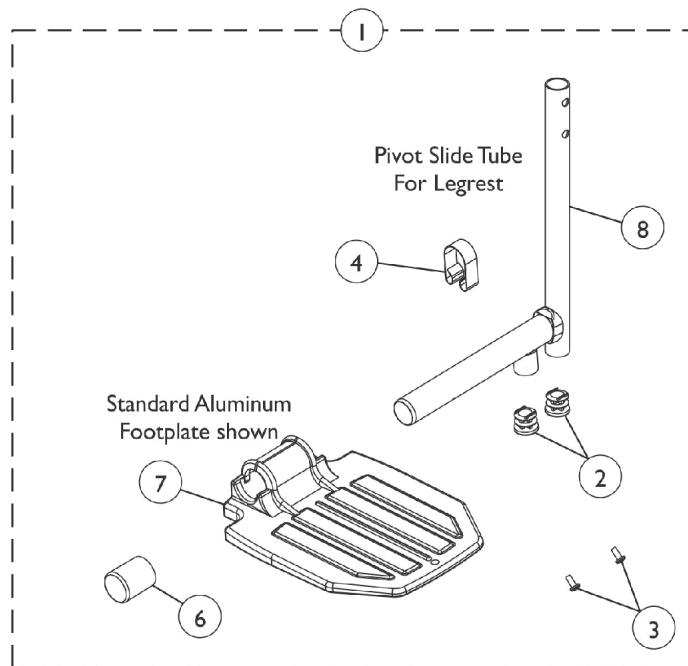
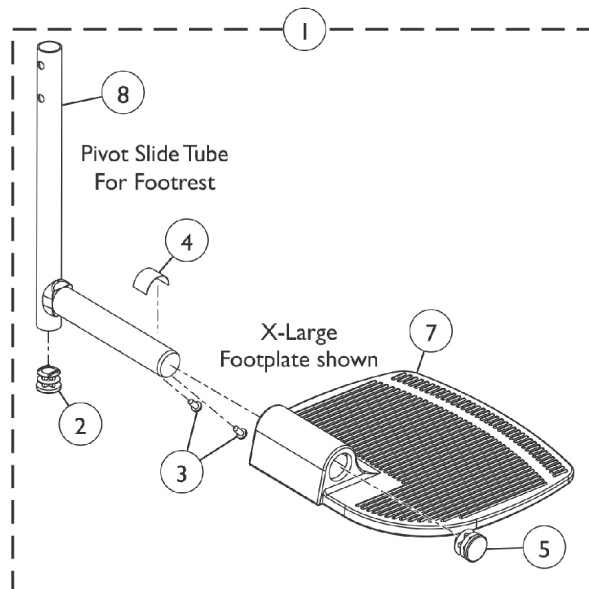

Pivot Slide Tube with Footplate

T93H Series and T94H Series

NOTE: If your chair was built with a serial # starting with "03H" or "03I", please contact an Invacare Parts Specialist for replacement parts at 1-800-333-6900 Ext. 3722.

Item Number	Note	Part Number	Description	Quantity Per	
				Package	Assembly
1		See Chart	Item #1 Pivot/Slide Tube with Footplate Assembly	1	1
2		1027097	Plug Button, Black (3/4")	1	2
3		40120X001	Screw, Phillips Pan Head (#8-32 x 3/8")	1	2
4	F	1006981	Spring, Tension	1	1
4	D,E	1036123	Spring, Leaf	1	1
5		1027095	Plug Button, Black (7/8")	1	1
6		1016346	Cap, End, Tube, Black (7/8")	1	1
7		44200X027	Footplate, Aluminum, Medium, Black (7-3/4" W x 6" L)	1	1
7		44200X025	Footplate, Aluminum, Extra Large, Black - Right (8" W x 8-1/2" L)	1	1
7		44200X026	Footplate, Aluminum, Extra Large, Black - Left (8" W x 8-1/2" L)	1	1
7		1015178	Footplate, Composite, Black (6" W x 7-53/64" L)	1	1
8		1110300-NLA	NLA - Pivot/Slide Tube w/ Plug Button, Legrest, Chrome	1	1
8		1110301	Pivot/Slide Tube w/ Plug Button, Legrest, Black	1	1
8		1111278-NLA	NLA - Pivot/Slide Tube w/ Plug Button, Footrest, Chrome	1	1
8		1111277	Pivot/Slide Tube w/ Plug Button, Footrest, Black	1	1

NOTE: D - Use one or more leaf springs per assembly as required such that footplate may be moved by hand to the up-right position and remain in place.
E - Use with Extra Large Footplates.
F - Use with Standard Footplates.

Item #1 Pivot/Slide Tube with Footplate Assembly

Front Rigging Model	Chair Width	Footplate Style	Frame Side	Part Number
T93HA-T93HAB Black	18 - 24" W	Aluminum	Right	1111285 See Note(s) A
T93HA-T93HAB Black	18 - 24" W	Aluminum	Left	1111286 See Note(s) A
T93HA-T93HAB Black	18 - 24" W	Extra Large Aluminum	Right	1110344
T93HA-T93HAB Black	18 - 24" W	Extra Large Aluminum	Left	1110345
T93HC-T93HAC Black	18 - 24" W	Composite	Right	1194329
T93HC-T93HAC Black	18 - 24" W	Composite	Left	1194330
T94HA-T94HAB Black	18 - 24" W	Aluminum	Right	1110315
T94HA-T94HAB Black	18 - 24" W	Aluminum	Left	1110316

Pivot Slide Tube with Footplate

T93H Series and T94H Series

NOTE: If your chair was built with a serial # starting with "03H" or "03I", please contact an Invacare Parts Specialist for replacement parts at 1-800-333-6900 Ext. 3722.

Item #1 Pivot/Slide Tube with Footplate Assembly

Front Rigging Model	Chair Width	Footplate Style	Frame Side	Part Number
T94HA-T94HAB Black	18 - 24" W	Extra Large Aluminum	Right	1110348
T94HA-T94HAB Black	18 - 24" W	Extra Large Aluminum	Left	1110349
T94HC-T94HCB Black	18 - 24" W	Composite	Right	1110311
T94HC-T94HCB Black	18 - 24" W	Composite	Left	1110312

NOTE: A - NOTE: Part numbers changed from Chrome Pivot/Slide Tube to Black as of 5/16/19