

Side Guards (SIDEGRDS)

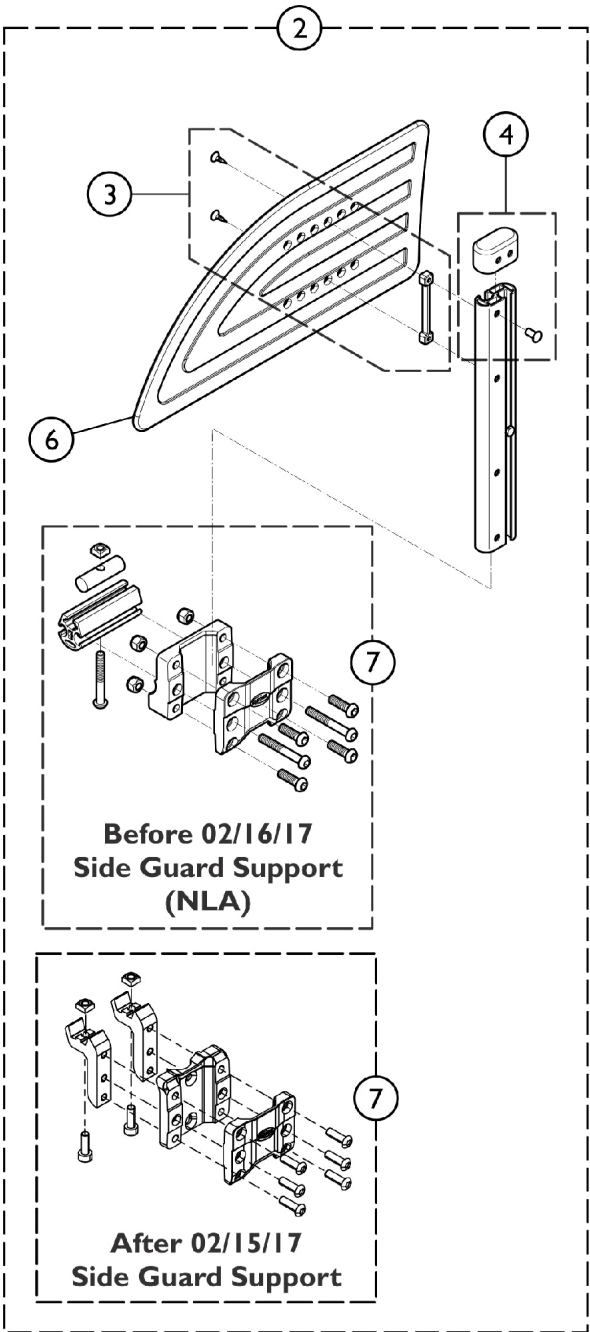
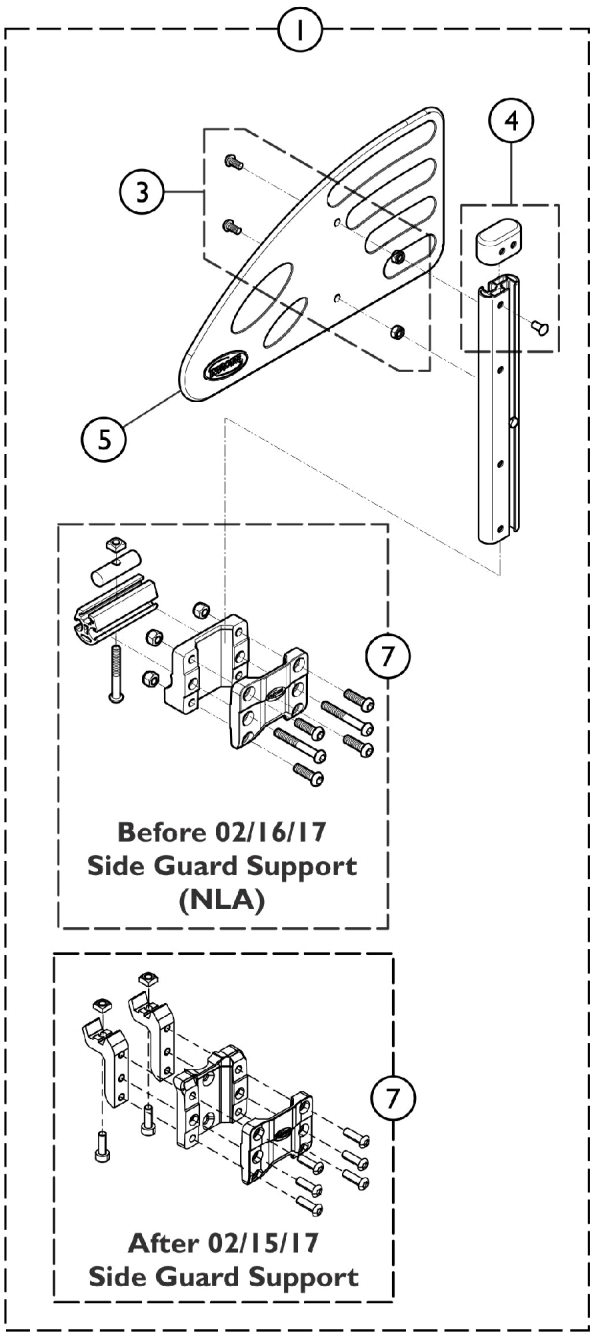

Side Guards (SIDEGRDS)

| Item Number | Note | Part Number | Description | Quantity Per | |
|---|------|-------------|--|--------------|----------|
| | | | | Package | Assembly |
| 1 | A | SP1639977 | Side Guard, Large - Left, (14-16" D) | 1 | 1 |
| 1 | A | SP1639978 | Side Guard, Large - Right, (14-16" D) | 1 | 1 |
| 2 | B | SP1640133 | Side Guard, Extra Large - Left (17-20" D) | 1 | 1 |
| 2 | B | SP1640134 | Side Guard, Extra Large - Right (17-20" D) | 1 | 1 |
| 3 | | SP1601494 | Kit, Hardware, Clothing Guard and Armpad | 1 | 1 |
| 4 | | SP1513515 | Kit, Clothing Guard Junior Cap | 1 | 1 |
| 5 | | SP1425601 | Clothing Guard, Black, T-Arm (HATD / HATF) | 1 | 1 |
| 6 | | SP1434725 | Clothing Guard, Height Adjustable | 1 | 1 |
| 7 | C | SP1640068 | Support, Side Guard | 1 | 1 |
| NOTE: A - Includes items 3, 4, 5, and 7. B - Includes itemd 3, 4, 6, and 7. C - Item #7 is backward compatible for wheelchairs manufactured Before 02/16/17 also. | | | | | |