

Dual (2PB)/ Quad (QPB) Push Button Switch w/ Multi-Mount Hardware After 10/23/18

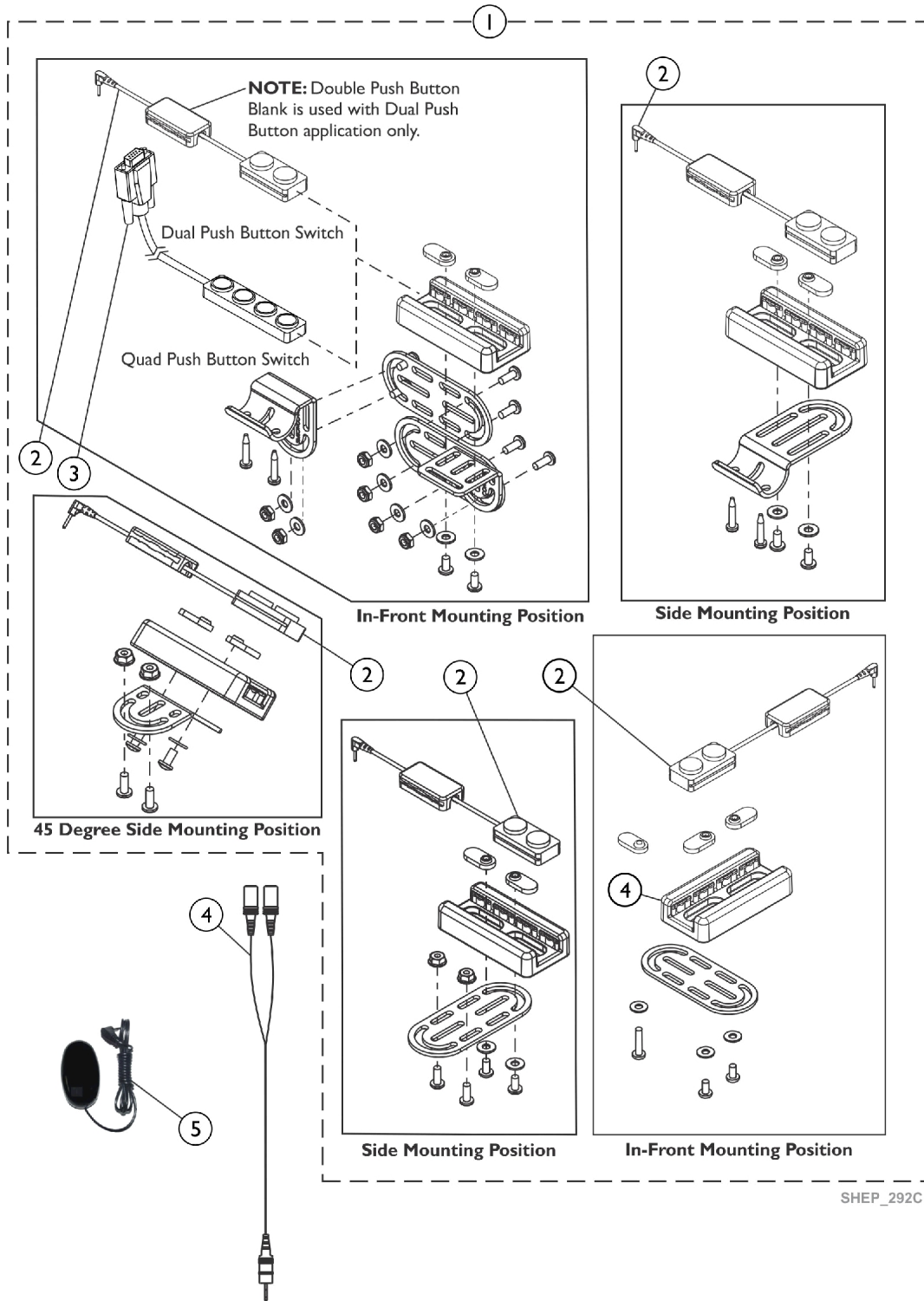

Dual (2PB)/ Quad (QPB) Push Button Switch w/ Multi-Mount Hardware After 10/23/18

Item Number	Note	Part Number	Description	Quantity Per	
				Package	Assembly
1	A	60105665	Kit, Dual Push Button Switch (2PB) and Multi-Mount Hardware	1	1
2			Kit, Switch, Dual Push Button (2PB)	1	1
			Hardware, Multi-Mount, Dual Push Button Switch (2PB)	1	1
			Tie Wrap (11-1/2" L)	1	10
			Manual, Push Button Switches Service	1	1
1	B	60105666	Kit, Quad Push Button Switch (QPB) and Multi-Mount Hardware	1	1
3			Kit, Switch, Quad Push Button (QPB)	1	1
			Hardware, Multi-Mount, Quad Push Button Switch (QPB)	1	1
			Tie Wrap (11-1/2" L)	1	10
			Manual, Push Button Switches Service	1	1
4		1140027	Cable, Monoport "Y" Phono (MPY)	1	1
5		60102517	Kit, Switch, Black Egg Reset w/ Hook/Loop Adhesive Back Fastener & Attaching Screws (EGSBLK)	1	1
<p>NOTE: A - Kit includes items 2, ALL Multi-Mount Bracketry and Hardware shown, Tie Wraps (not shown) and Service Manual (not shown).</p> <p>B - Kit includes items 3, ALL Multi-Mount Bracketry and Hardware shown, Tie Wraps (not shown) and Service Manual (not shown).</p> <p>NOTE: The Dual or Quad Push Button Switch can assemble to any Multi-Mount Bracketry combination shown. For additional information and installation instructions refer to part #60101883 located at www.invacare.com under Product Literature Search.</p>					