

Front Riggings - Adjustable Heel Loops

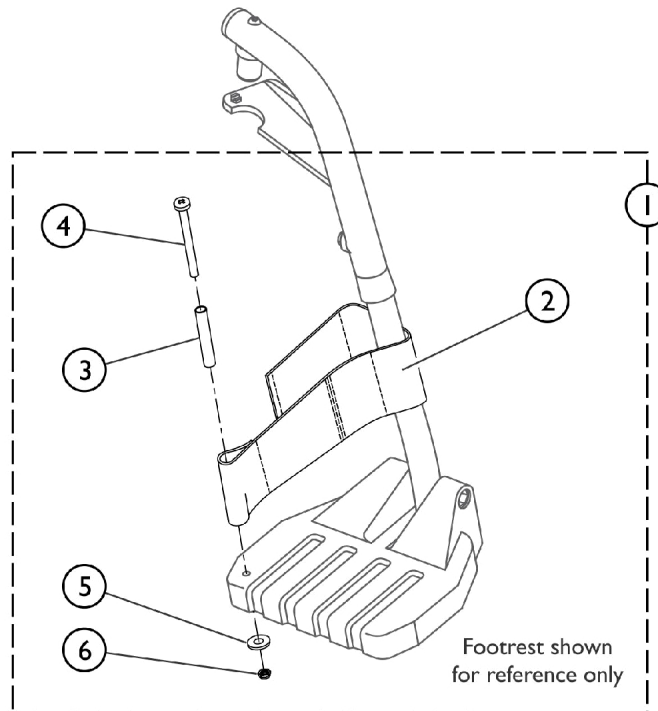

**Heel Loop and Hardware for
All Footplate Options with
Toe Loops (1345) being used (not shown).**

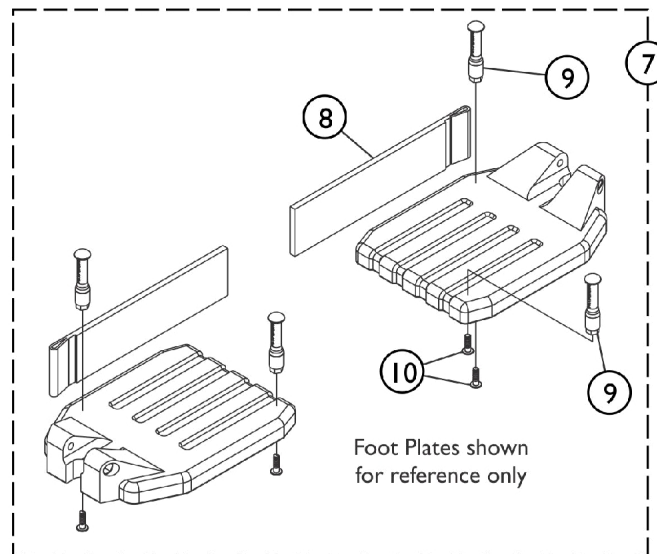

SCM_535A

**Heel Loop and Hardware for
All Footplate Options without
Toe Loops (1345) being used.**

Front Riggings - Adjustable Heel Loops

Item Number	Note	Part Number	Description	Quantity Per	
				Package	Assembly
1	A	1191117	Kit, Heel Loop, Adjustable w/ Hardware (Pair)	1	1
2			Heel Loop	1	2
3			NLA - Spacer (1/4 x 11/32 x 1-3/4")	1	2
4			NLA - Screw, Phillips Pan Head (1/4-20 x 2-1/4")	1	2
5			Washer, Flat (1/4 x 5/8 x 1/16")	1	2
6			Nut, Hex, Nylon Cap (1/4-20)	1	2
	B	5321579	Instruction Sheet, Adjustable Heel Loop	1	1
7			Heel Loop w/ Hardware (Pair)	2	1
NOTE: A - Kit includes items 2 - 6. Used with all Footplates that also have Toe Loops (1345) attached as well. B - Kit includes items 8-10. Used with all Footplates that do not have Toe Loops (1345) attached..					