

T.R.C.M. Upgrade Kit w/ Mercury Free Switches

Tilt Only or Tilt/Recline & Recline Only

As of 7/1/2009, switches are mercury free.

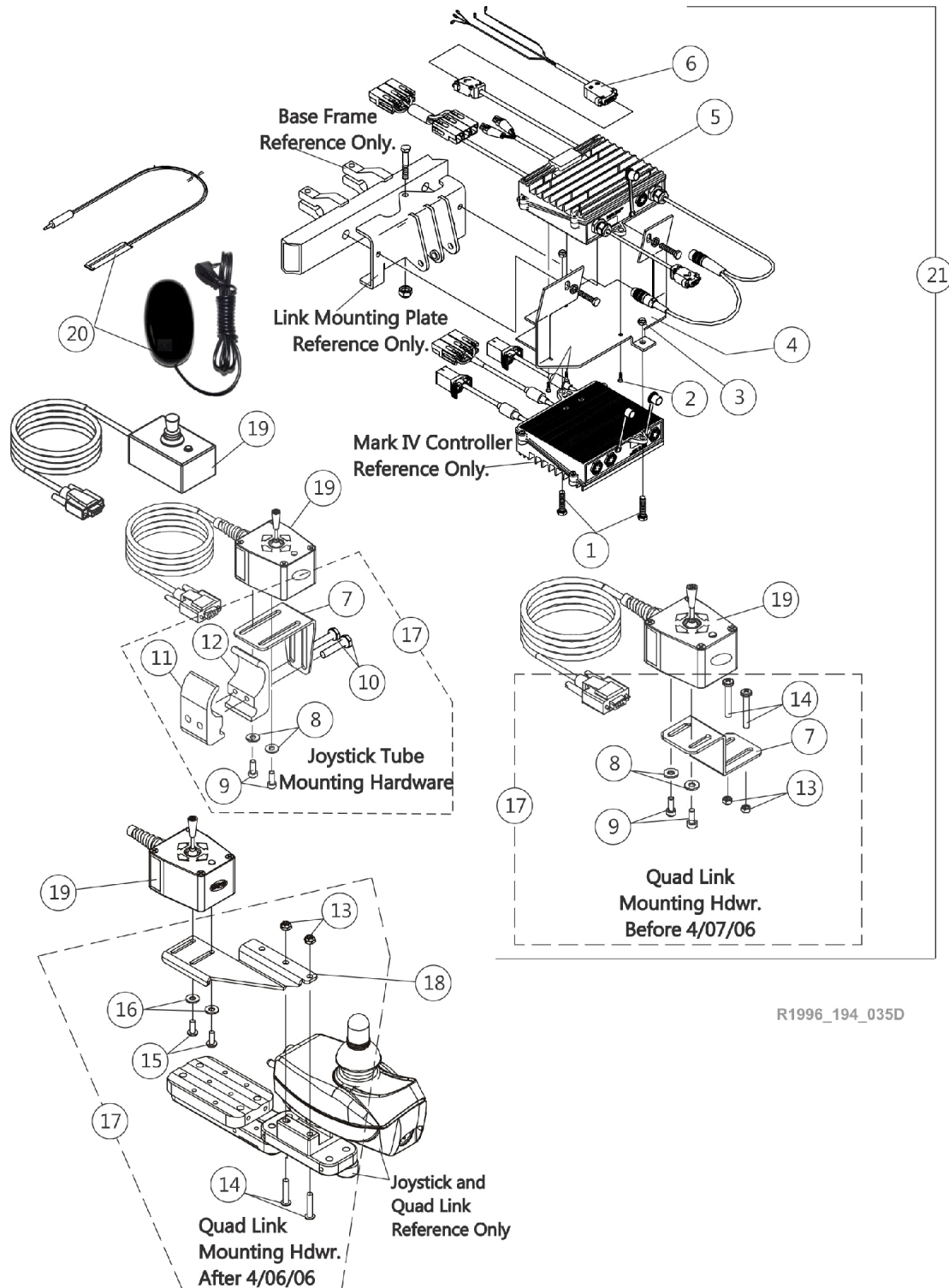

R1996_194_035D

T.R.C.M. Upgrade Kit w/ Mercury Free Switches

Tilt Only or Tilt/Recline & Recline Only

As of 7/1/2009, switches are mercury free.

Item Number	Note	Part Number	Description	Quantity Per	
				Package	Assembly
1		1025708-NLA	NLA - Bolt, Hex Head Cap (1/4-20 x 3/4")	1	2
2		1025729	Screw, Phillips Pan Head Tap (#8-32 x 3/8")	1	3
3		1025736	Locknut (1/4-20)	1	2
4		1079846-NLA	NLA - Bracket, T.R.C.M. Controller Mounting, Black	1	1
5		1079017-NLA	NLA - Controller, MKIV T.R.C.M.	1	1
6		1080133-NLA	NLA - Harness, Motor Actuator	1	1
17	D	1077519	Kit, 4-Way Switch Joystick Tube Mounting Hardware	1	1
7			NLA - Bracket, Joystick Mounting, Black	1	1
8			Washer (#10 Flat)	1	2
9			Screw, Phillips Pan Head (#10-32 x 1/2")	1	2
10			NLA - Screw, Hex Head (1/4-20 x 1-1/8")	1	2
11			Half Clamp, Non-Threaded Holes	1	1
12			NLA - Half Clamp, Threaded Holes	1	1
17	I,E	1077520-NLA	NLA - Kit, 4-Way Switch Quad Link Mounting Hardware	1	1
7			Screw, Phillips Pan Head (#10-32 x 1/2")	1	2
8			NLA - Bracket, Quad Link Mounting, Black	1	1
9			Washer (#10 Flat)	1	2
13			Locknut (#10-32)	1	2
14			Screw, Phillips Pan Head (#10-32 x 1-3/8")	1	2
17	G,I	1139418	Kit, 4-Way Switch Quad Link Mounting Hardware	1	1
13			Locknut (#10-32)	1	2
14			Screw, Phillips Pan Head w/Patch (#10-32 x 7/8")	1	2
15			Screw, Phillips Pan Head (#10-32 x 1/2")	1	2
16			NLA - Washer, Nylon (#10)	1	2
18		1134132	Bracket, 4-Way Switch Quad Link, Black - Right	1	1
18		1134133	Bracket, 4-Way Switch Quad Link, Black - Left	1	1
19	H	1080116-NLA	NLA - Switch, 4-Way (FWT)	1	1
19		60105577	Kit, Switch, 4-Way (FWT)	1	1
20		1020818	Switch, Red Flex Ribbon (Tape) Reset	1	1
20	F	1123276	Kit, Switch, Black Egg Reset w/ Hook/Loop Adhesive Back Fastener & Attaching Screws (EGSBLK)	1	1
21	A,A1,A2,C	1081400-NLA	NLA - Kit, T.R.C.M. Upgrade with Mercury Switches	1	1
	B	1080635-NLA	NLA - Harness, Recline/Tilt Limit Mercury Free Ball Switch	1	1
	B	1080634-NLA	NLA - Harness, Drive Lockout Mercury Free Ball Switch	1	1
	B	0309019-NLA	NLA - Cover, Controller	1	1
	B	0152400-NLA	NLA - Tie Wrap, Black (8" L)	1	10
	B	0154500-NLA	NLA - Cable Tie, Black (4")	1	10
	B	1081366-NLA	NLA - Instruction Sheet, MKIV T.R.C.M. Upgrade	1	1
	B	1043576-NLA	NLA - Service Manual, MKIV Electronics	1	1

T.R.C.M. Upgrade Kit w/ Mercury Free Switches

Tilt Only or Tilt/Recline & Recline Only

As of 7/1/2009, switches are mercury free.

NOTE: A - To fully utilize the T.R.C.M. upgrade kit, it is required to have a MKIV controller part number (1105707) with 2.15 version software or higher. "Through the joystick operation" is not available for 2.0 through 2.14 version software.

A1 - Call technical service at 1-800-832-4707 for assistance on upgrading controller. Software version can be verified by using a remote programmer part number (1109091).

A2 - MKIV controller part numbers (1061958) and (1086240) were replaced with MKIV controller part number (1105707) and is applicable to use with all T.R.C.M. upgrade kits.

B - Not shown.

C - Include items 1-17 and all items below

D - Includes items 7-12

E - Before 4/07/06 and includes items 7-9, 13 and 14

F - After 5/23/04 the Egg Reset Switch became available as a service part and can be used as a direct replacement for the tape reset switch part # 1020818.

G - After 4/06/06. Includes items 13-16

H - Part # 1080116 is No Longer Available. Order item #19 part number 60105577 as a replacement. New design is rectangular in shape. It is recommended to order new Hardware 1077519 as well.

I - 4-Way Toggle Switch 60105577 is not compatible with this hardware.