

T.R.C.M. & 4-Way Switch

Tilt Only or Tilt/Recline & Recline Only

NOTE: MKIV T.R.C.M. replaced the 5.7 MAX controller 6/15/98 and became standard On-Chair for the seating systems listed above.

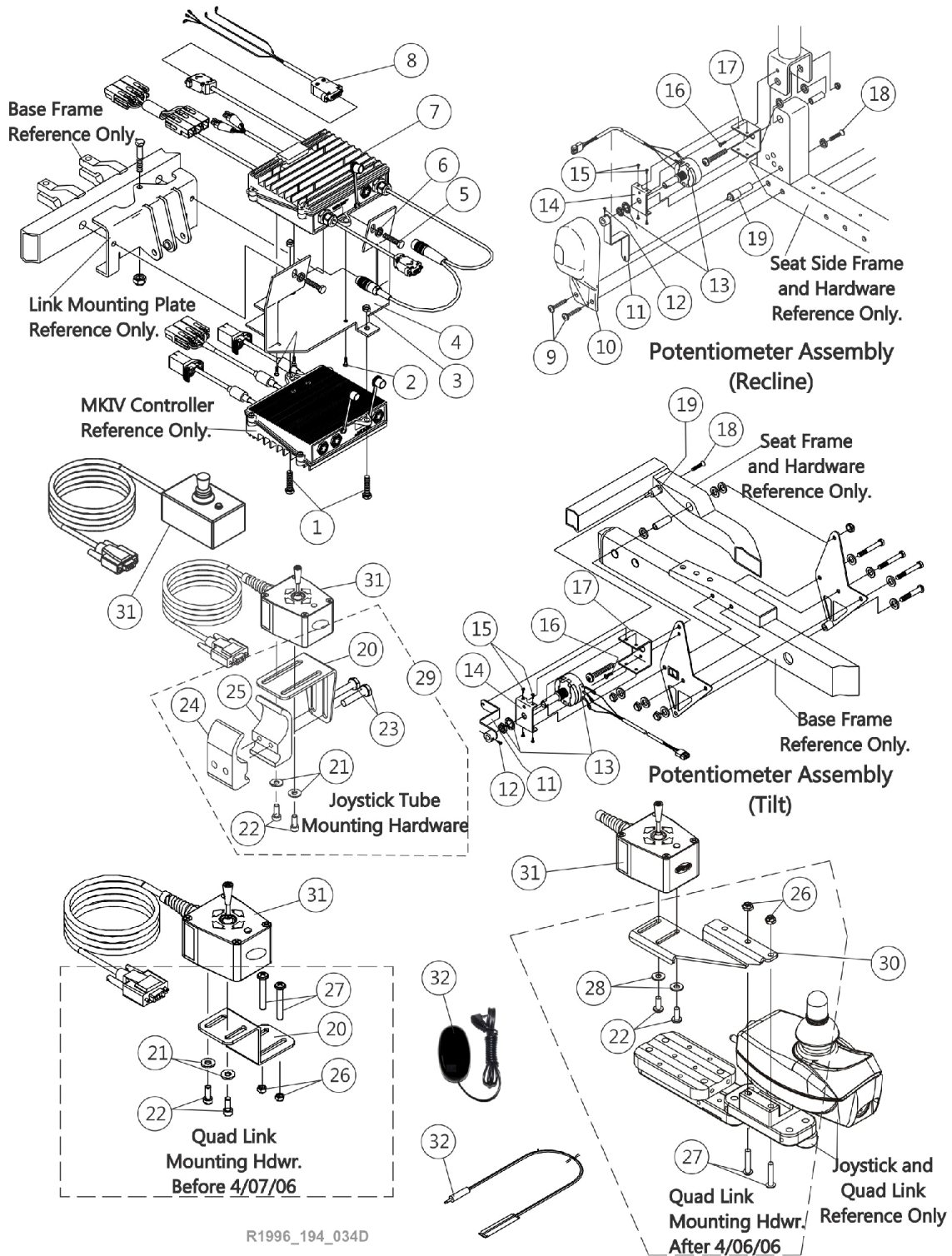

T.R.C.M. & 4-Way Switch

Tilt Only or Tilt/Recline & Recline Only

Item Number	Note	Part Number	Description	Quantity Per	
				Package	Assembly
1		1025708-NLA	NLA - Bolt, Hex Head Cap (1/4-20 x 3/4")	1	2
2		1025729	Screw, Phillips Pan Head Tap (#8-32 x 3/8")	1	3
3		1025736	Locknut (1/4-20)	1	2
4		1079846-NLA	NLA - Bracket, T.R.C.M. Controller Mounting, Black	1	1
5		0139606-NLA	NLA - Screw, Hex Head (5/16-18 x 1")	1	2
6		1072692-NLA	NLA - Lockwasher, Split (5/16")	1	2
7		1079017-NLA	NLA - Controller, MKIV T.R.C.M.	1	1
8		1080133-NLA	NLA - Harness, Motor Actuator	1	1
9		0065706	Screw, Phillips Pan Head Tap (#10-16 x 3/4")	1	2
10		1077764-NLA	NLA - Cover, Potentiometer Mounting Bracket	1	1
11		1079272-NLA	NLA - Lever, Arm, Black	1	1
12		1025275-NLA	NLA - Screw, Set w/ Patch (#8-32 x 1/4")	1	1
13		1079991-NLA	NLA - Recline Potentiometer w/ Harness, Nut and Washer	1	1
13		1079992-NLA	NLA - Potentiometer, Tilt w/ Harness, Nut and Washer	1	1
14		1079278	Plate, Back	1	1
15		1017766-NLA	NLA - Screw, Phillips Pan Head (4-40 x 1/4")	1	4
16		1017766-NLA	NLA - Screw, Phillips Pan Head (4-40 x 1/4")	1	1
17		1079276	Plate, Front	1	1
18		1017423	Screw, Slotted Hex Washer Head w/ Patch (#10-32 x 1/2")	1	1
19		1079274	Stud, Mounting	1	1
29	A	1077519	Kit, 4-Way Switch Joystick Tube Mounting Hardware	1	1
20			NLA - Bracket, Joystick Mounting, Black	1	1
21			Washer (#10 Flat)	1	2
22			Screw, Phillips Pan Head (#10-32 x 1/2")	1	2
23			NLA - Screw, Hex Head (1/4-20 x 1-1/8")	1	2
24			Half Clamp, Non-Threaded Holes	1	1
25			NLA - Half Clamp, Threaded Holes	1	1
29	B,F	1077520-NLA	NLA - Kit, 4-Way Switch Quad Link Mounting Hardware	1	1
20			NLA - Bracket, Quad Link Mounting, Black	1	1
21			Washer (#10 Flat)	1	2
22			Screw, Phillips Pan Head (#10-32 x 1/2")	1	2
26			Locknut (#10-32)	1	2
27			Screw, Phillips Pan Head (#10-32 x 1-3/8")	1	2
29	D,F	1139418	Kit, 4-Way Switch Quad Link Mounting Hardware	1	1
22			Screw, Phillips Pan Head (#10-32 x 1/2")	1	2
26			Locknut (#10-32)	1	2
27			Screw, Phillips Pan Head w/Patch (#10-32 x 7/8")	1	2
28			NLA - Washer, Nylon (#10)	1	2
30		1134132	Bracket, 4-Way Switch Quad Link, Black - Right	1	1
30		1134133	Bracket, 4-Way Switch Quad Link, Black - Left	1	1
31	E	1080116-NLA	NLA - Switch, 4-Way (FWT)	1	1
31		60105577	Kit, Switch, 4-Way (FWT)	1	1

T.R.C.M. & 4-Way Switch

Tilt Only or Tilt/Recline & Recline Only

Item Number	Note	Part Number	Description	Quantity Per	
				Package	Assembly
32		1020818	Switch, Red Flex Ribbon (Tape) Reset	1	1
32	C	1123276	Kit, Switch, Black Egg Reset w/ Hook/Loop Adhesive Back Fastener & Attaching Screws (EGSBLK)	1	1
<p>NOTE: A - Includes items 20-25 B - Before 4/07/06 and includes items 20-22, 26 and 27 C - After 5/23/04 the Egg Reset Switch became available as a service part and can be used as a direct replacement for the tape reset switch part # 1020818. D - After 4/06/06 and includes items 22, 26-28 E - Part # 1080116 is No Longer Available. Order item #31 part number 60105577 as a replacement. New design is rectangular in shape. It is recommended to order new Hardware 1077519 as well. F - 4-Way Toggle Switch 60105577 is not compatible with this hardware.</p>					