

Wheel Lock - Hublock Replacement Kits (After 10/31/07)

Seat Rail Mount Shown. For Cane Mount, Item 12
To Be Mounted In Highest Hole On Right Cane And Item 11
To Be Secured By The Forward Bolt Securing The Back
Angle Plates To The Right Seat Rail.

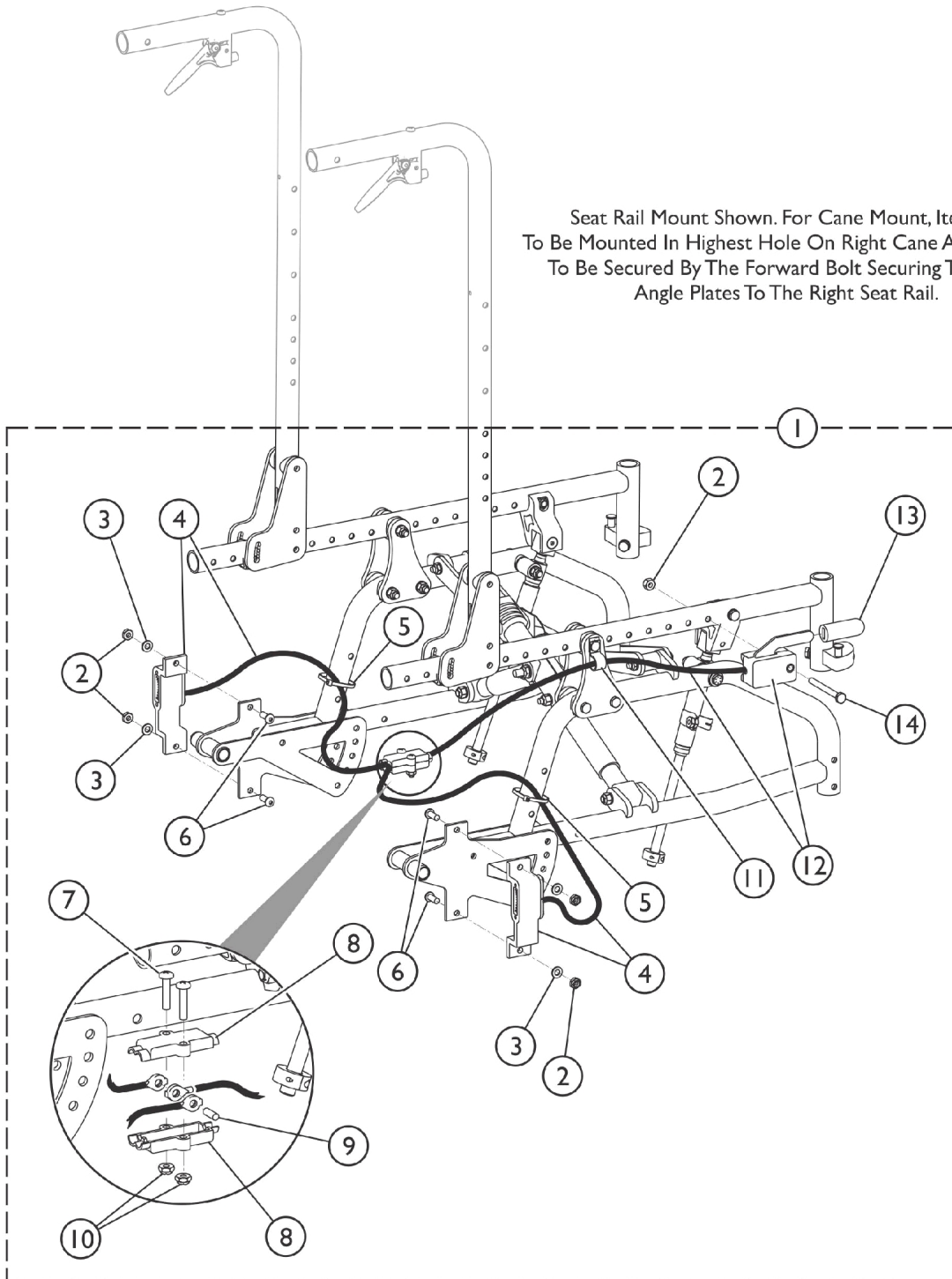

Wheel Lock - Hublock Replacement Kits (After 10/31/07)

Item Number	Note	Part Number	Description	Quantity Per	
				Package	Assembly
1	A,B	1132606	Kit, Hublock Cables and Hardware	1	1
2			Locknut (1/4-28)	1	5
3			Washer (1/4 x 1/2 x 1/16")	1	4
4			Latch with Cable Assembly, Hublock - Right	1	1
4			Latch with Cable Assembly, Hublock - Left	1	1
5			Tie Wrap (5-5/8" L)	1	2
6			NLA - Screw, Socket Button Head (1/4-28 x 3/4")	1	4
7			Screw, Socket Button Head (#10-32 x 1")	1	2
8			Box, Junction Cable	1	2
9			Pin, Dowel (3/16 x 1/2")	1	1
10			Locknut (#10-32)	1	2
11			NLA - Bracket, Cable/Wire Mounting, Black	1	1
12			Actuator w/ Cable Assembly, Hand Operated	1	1
13			Tip, Plastic, Black	1	1
14			Screw, Socket Head (1/4-20 x 2-1/4")	1	1
4	C,D	1132357	Latch with Cable Assembly, Hublock - Right	1	1
4	C,D	1132358	Latch with Cable Assembly, Hublock - Left	1	1
8		1132375	Box, Junction Cable	1	1
12		1132359	Actuator w/ Cable Assembly, Hand Operated	1	1
13		1127688	Package, Plastic Tip, Black	10	1

NOTE: A - Includes items 2-14
 B - Item 4 (Cable Assembly), item 8 (Junction Box), and item 14 (Plastic Tip) are sold separately as service parts.
 C - For chairs manufactured before 2/2/09, it is recommended to order the Hublock Latch with Cable Assembly part numbers 1132357 and 1132358 together.
 D - For chairs manufactured after 2/1/09, it is also recommended to order both Hublock Latch with Cable Assembly part numbers 1132357 and 1132358 together to allow even wear on the components.