

Axle Plates w/ Hardware (Permanent Axle - All Wheels)

The camber is built into the axle plate. If the flat side is out it is 3 degree. If the round surface is outside it is 0 degree.

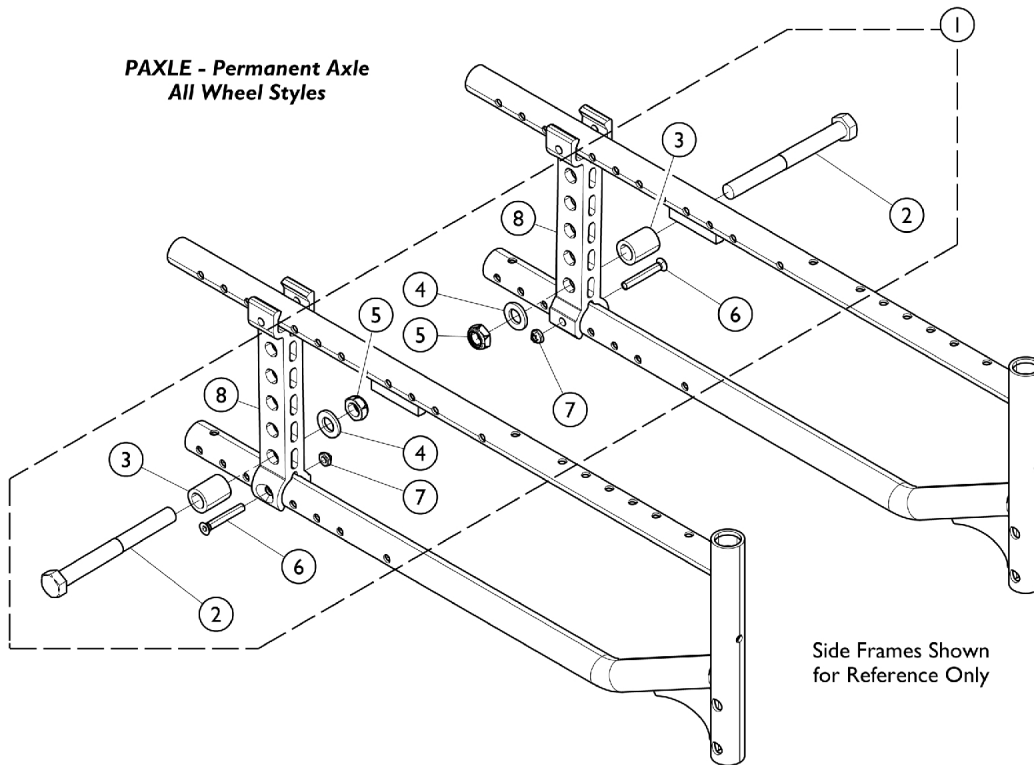

Item Number	Note	Part Number	Description	Quantity Per	
				Package	Assembly
1	A	1169078	Kit, Hardware, Fixed Axle Plate (Pair)	1	1
2			Screw, Cap, Hex Head (M12 x 1.75 x 115mm)	1	2
3			Spacer, Axle	1	2
4			Washer (M22 x 12mm x 2.5mm)	1	2
5			Nut, Hex (M12 X 1.75)	1	2
6			Screw, C-Sunk Head (M6 x 1 x 40mm)	1	2
7			NLA - Locknut (M6 x 1)	1	2
8			Plate, Axle, Fixed	1	2

NOTE: A - Kit includes items 2 - 8.