

# Adjustable Angle Footplate Assemblies - AT5543

## 9000XT/XDT/Recliner

**NOTE:** Slide Tube with Adjustable Footplate is attached to Legrest/Footrest support using the spring button or bolt thru hardware. See chart titled, "Pivot Slide Tube Attaching Hardware."

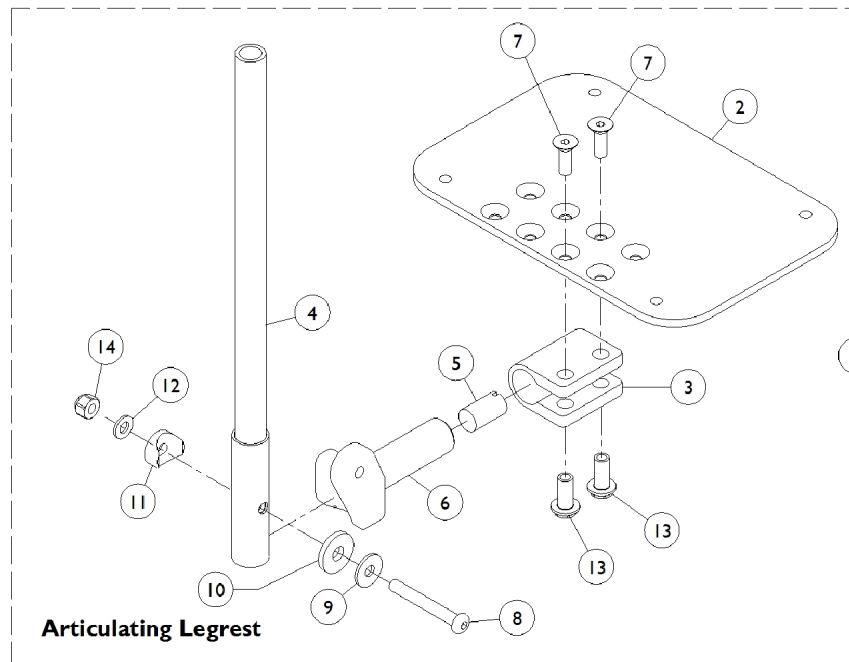
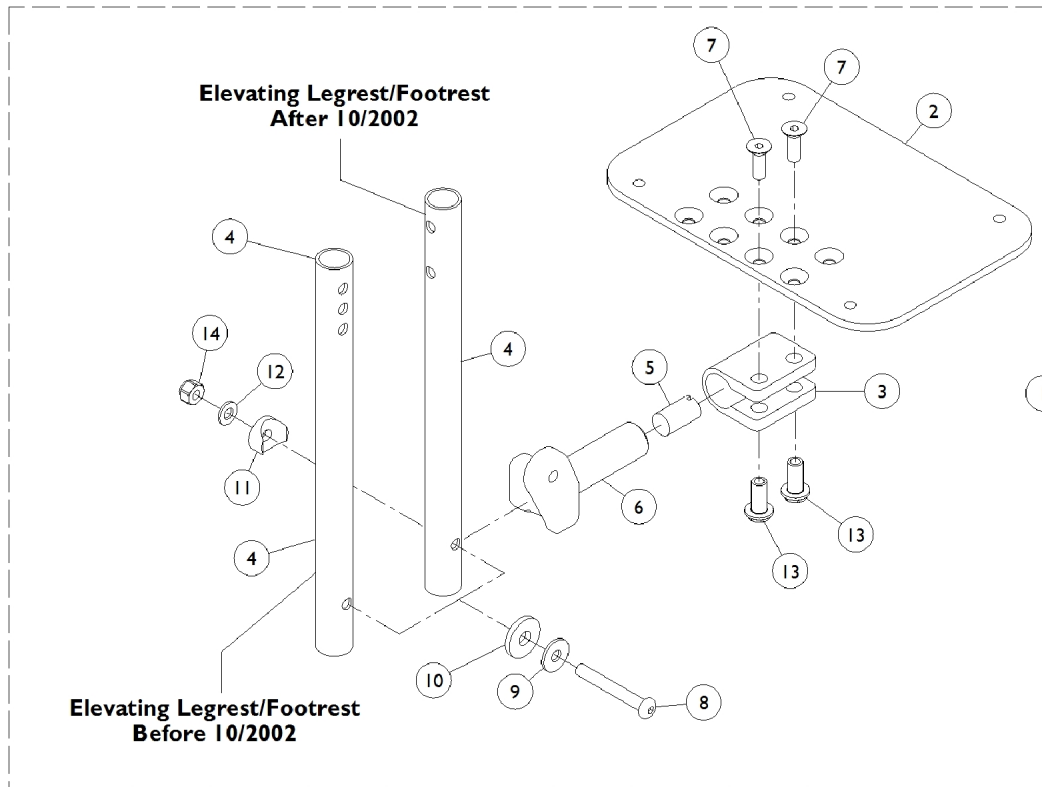

# Adjustable Angle Footplate Assemblies - AT5543

## 9000XT/XDT/Recliner

**NOTE: Slide Tube with Adjustable Footplate is attached to Legrest/Footrest support using the spring button or bolt thru hardware. See chart titled, "Pivot Slide Tube Attaching Hardware."**

### 9000XT/9000XDT/9000XT Recliner

Item Number	Note	Part Number	Description	Quantity Per	
				Package	Assembly
1	G	See Chart	Adjustable Angle Footplate Assembly - AHS4 - AHL4 Articulating Legrests only	1	1
1	G	See Chart	Adjustable Angle Footplate Assembly - Elevating Legrest/Footrest	1	1
2	A,H	1113573	Footplate, Adjustable Angle, Large, Black (5-1/4" W x 8" L)	1	1
2	B,H	1113574	Footplate, Adjustable Angle, Extra Large, Black (6-1/4" W x 8" L)	1	1
2	C,H	1113575	Footplate, Adjustable Angle, XX- Large, Black (7-1/4" W x 8" L)	1	1
3		1058517	Clamp, Footplate	1	1
4	D	1057855	Tube, Pivot and Slide, Straight, Steel, Black (9-7/8" L)	1	1
4	D,I	1110352-NLA	NLA - Pivot/Slide Tube, Straight, Black	1	1
4	E	1091745-NLA	NLA - Tube, Pivot/Slide, Straight, Steel, Chrome (13-7/8" L)	1	1
5		1048816	Screw, Nylon Adjustment (1/2-13 x 7/8")	1	1
6		1052103	Hinge, Footplate - Left	1	1
6		1052102	Hinge, Footplate - Right	1	1
7		1029545	Screw, Socket Flat Head (1/4-20 x 3/4")	1	2
8		1022831	Screw, Socket Button Head (1/4-20 x 1-7/8")	1	1
9		1026900	Washer (1/4 x 23/32 x 1/16")	1	1
10		1016301	Washer, Nylon (5/16 x 7/8 x 1/8")	1	1
11		1025457	Spacer, Coved (1/4 x 3/4 x 11/32")	1	1
12		1026907	Washer (1/4 x 1/2 x 1/16")	1	1
13		1082686	Nut, Barrel, Hex Head (1/4-20 x 11/16")	1	2
14		1025736	Locknut (1/4-20)	1	1
	F	See Chart	Bolt Through and Spring Button Kits	1	1

**NOTE:** A - For 14 - 15" wide chairs.  
 B - For 16 - 19" wide chairs.  
 C - For 20 - 22" wide chairs.  
 D - For Elevating Legrest/Footrest.  
 E - For Articulating Legrest.  
 F - Not Shown.  
 G - Includes items 2 thru 14.  
 H - This footplate was revised 9/2/2008 with rounder corners and accessory holes changed from 8 to 4. Recommended to replace footplate in pairs to match sides.  
 I - After 10/2002, no longer available use item #1 as a replacement.

## #1 Adjustable Angle Footplate Assembly

### AHS4 - AHL4 Articulating Legrests only

Straight Sliding Tube (13-7/8") Steel	Side	Part Number
14" - 15" Wide (5-1/4" Footplate)	Right	1091775-NLA
14" - 15" Wide (5-1/4" Footplate)	Left	1091776-NLA
16" - 19" Wide (6-1/4" Footplate)	Right	1091777-NLA

# Adjustable Angle Footplate Assemblies - AT5543

## 9000XT/XDT/Recliner

**NOTE: Slide Tube with Adjustable Footplate is attached to Legrest/Footrest support using the spring button or bolt thru hardware. See chart titled, "Pivot Slide Tube Attaching Hardware."**

### #1 Adjustable Angle Footplate Assembly

**AHS4 - AHL4 Articulating Legrests only**

Straight Sliding Tube (13-7/8") Steel	Side	Part Number
16" - 19" Wide (6-1/4" Footplate)	Left	1091778-NLA
20" - 22" Wide (7-1/4" Footplate)	Right	1091779-NLA
20" - 22" Wide (7-1/4" Footplate)	Left	1091780-NLA

NOTE: Heel Loops for Adjustable Angle Footplates can be found in the category titled, "Footrest and Legrest Accessories."

### #1 Adjustable Angle Footplate Assembly

**Elevating Legrest/Footrest**

Straight Slide Tube (9-7/8") Steel	Side	Part Number
14" - 15" Wide (5-1/4" Footplate)	Right	1060444
14" - 15" Wide (5-1/4" Footplate)	Left	1060445
16" - 19" Wide (6-1/4" Footplate)	Right	1062756
16" - 19" Wide (6-1/4" Footplate)	Left	1062757
20" - 22" Wide (7-1/4" Footplate)	Right	1091789-NLA
20" - 22" Wide (7-1/4" Footplate)	Left	1091790-NLA
14" - 15" Wide (5-1/4" Footplate)	Right	1110355
		See Note(s) A
14" - 15" Wide (5-1/4" Footplate)	Left	1110356
		See Note(s) A
16" - 19" Wide (6-1/4" Footplate)	Right	1110357
		See Note(s) A
16" - 19" Wide (6-1/4" Footplate)	Left	1110358
		See Note(s) A
20" - 22" Wide (7-1/4" Footplate)	Right	1110359
		See Note(s) A
20" - 22" Wide (7-1/4" Footplate)	Left	1110360
		See Note(s) A

NOTE: A - After 10/02

NOTE: Heel Loops for Adjustable Angle Footplates can be found in the category titled, "Footrest and Legrest Accessories."

# Adjustable Angle Footplate Assemblies - AT5543

## 9000XT/XDT/Recliner

**NOTE:** Slide Tube with Adjustable Footplate is attached to Legrest/Footrest support using the spring button or bolt thru hardware. See chart titled, "Pivot Slide Tube Attaching Hardware."

### Bolt Through and Spring Button Kits

**Not Used for AHS4 - AHL4 Articulating Legrests**

Style	Part Number	Quantity Per Package	Quantity Per Footrest	Quantity Per Legrest
Spring Button Hardware Kit	1188335 See Note(s) A	2	2	4
Bolt Through Hardware Kit	1101776 See Note(s) A	2	2	2
Tool Kit	1058407 See Note(s) B	1	N/A	N/A

NOTE: A - Kit includes 2 ea. Double Spring Buttons.  
B - Kit includes allen wrench, key, and open end wrench. The Bolt Thru Hardware uses the Tool Kit for installation.