

Forks & Hardware

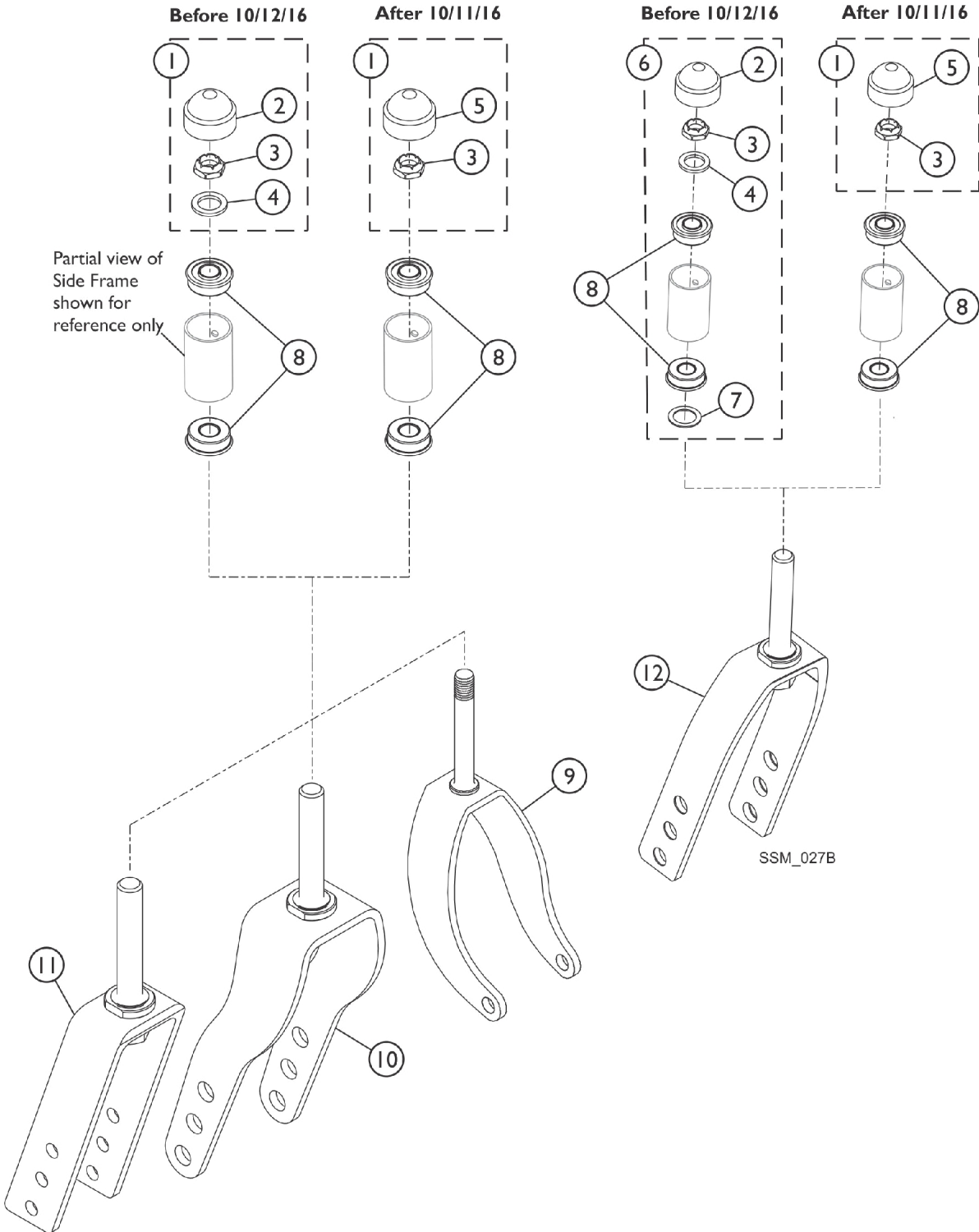

Forks & Hardware

Item Number	Note	Part Number	Description	Quantity Per	
				Package	Assembly
1	A,H	1033202	Kit, Fork Hardware (Pair)	1	1
2			Cap, Head Tube, Black	1	2
3			Locknut (1/2-20)	1	2
4			Washer, Nylon (5/8 x 1 x 3/32")	1	2
1	I,J	1194269	Kit, Fork Hardware (Pair)	1	1
3			Locknut (1/2-20)	1	2
5			Cap, Head Tube, Black	1	2
6	H,K	1089104	Kit, Fork Hardware (Pair)	1	1
2			Cap, Head Tube, Black	1	2
3			Locknut (1/2-20)	1	2
4			Washer, Nylon (5/8 x 1 x 3/32")	1	2
7			Washer, Steel (17/32 x 3/4 x 1/32")	1	2
7	B	1089102	Washer, Steel (17/32 x 3/4 x 1/32")	1	1
8	F,H	1001801	Bearing, Flange (1/2")	1	2
8	F,I	1192848	Bearing, Flange (5/8")	1	2
9	C	1075529	Fork and Stem, Steel, Black (8" Caster)	1	1
10	D	1111305	Fork and Stem Assembly, Steel, Black (8")	1	1
10	M	1195805	Fork and Stem Assembly, Steel, Black (8")	1	1
11	H	1037420	Fork and Stem Assembly, Black (6 x 1" Caster)	1	1
11	I	1194267	Fork and Stem Assembly, Black (6 x 1" Caster)	1	1
12	B,H	1089103	Fork and Stem, Aluminum, Black (8" Caster)	1	1
12	I	1194266	Fork and Stem, Aluminum, Black (8" Caster)	1	1
12	E,H	1056640	Fork and Stem Assembly, Black (8" & 6 x 2" Caster)	1	1
12	E,I	1192855	Fork and Stem Assembly, Black (8" & 6 x 2" Caster)	1	1
	G,H	1131189	Package, Head Tube Cap	10	1
	I	1192854	Cap, Head Tube, Black	1	1

NOTE: A - Includes items 2-4.
 B - This part is required on all Tracer SX5 Recliner Chairs and 20-22" Wide Non-Reclining Tracer SX5 Chairs.
 C - Tracer EX2 Chairs with Fixed Front Frames.
 D - Tracer EX2 Chairs with Swingaway Frames Before 03/20/17.
 E - Tracer SX5 Chairs, Non-Reclining, 14-18" Wide.
 F - Flanged bearings are not included in the side frame assemblies and (2) each are needed per side.
 G - Not Shown.
 H - Before 10/12/16
 I - After 10/11/16.
 J - Includes items 3 and 5. Washers are not required After 10/11/16.
 K - Includes items 2, 3, 4 and 7.
 M - Tracer EX2 Chairs with Swingaway Frames After 03/19/17.