

Side Frames & Hardware - EX1 & EX2

Side Frames include the Flange Bearings (2 per side)

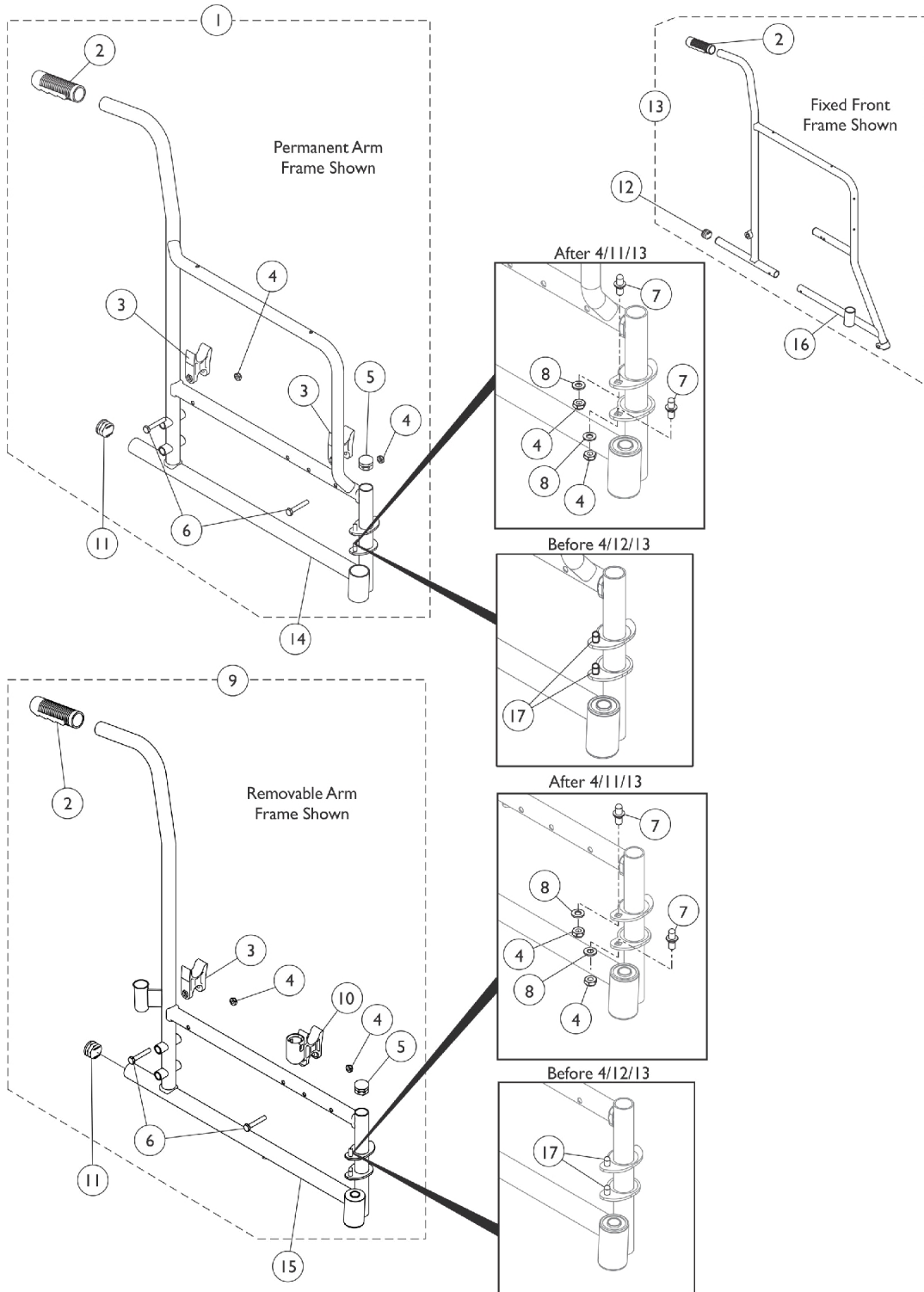

Side Frames & Hardware - EX1 & EX2

Side Frames include the Flange Bearings (2 per side)

Item Number	Note	Part Number	Description	Quantity Per	
				Package	Assembly
1	A	1193617	Kit, Side Frame Hardware, Permanent Arm (Pair)	1	1
2			Grip, Hand (6")	1	2
3			H-Block	1	4
4			Locknut (1/4-20)	1	8
5			Plug Button, Black (7/8")	1	2
6			Screw, Hex Head (1/4-20 x 1-1/2")	1	4
7			Pin, Hinge	1	4
8			Washer, Plain (1/4 x 1/2 x 9/16")	1	4
			NLA - Bag, Poly Zip-Lip (8-3/4" L x 6" W)	1	1
			Instruction Sheet, Hand Grip Service	1	1
9	B	1193618	Kit, Side Frame Hardware, Removable Arm (Pair)	1	1
2			Grip, Hand (6")	1	2
3			H-Block	1	2
4			Locknut (1/4-20)	1	8
5			Plug Button, Black (7/8")	1	2
6			Screw, Hex Head (1/4-20 x 1-1/2")	1	4
7			Pin, Hinge	1	4
8			Washer, Plain (1/4 x 1/2 x 9/16")	1	4
10			H-Block with Socket Cup	1	2
			NLA - Bag, Poly Zip-Lip (8-3/4" L x 6" W)	1	1
			Instruction Sheet, Hand Grip Service	1	1
11	C	1029501	Plug Button, Black (1")	1	2
	E,F	15680X013	Anti-Rattle (1")	1	2
12		1027095	Plug Button, Black (7/8")	1	2
13	D	1193616	Kit, Side Frame Hardware, Fixed Frame (Pair)	1	1
2			Grip, Hand (6")	1	2
			NLA - Bag, Poly Zip-Lip (8-3/4" L x 6" W)	1	1
			Instruction Sheet, Hand Grip Service	1	1
14	G,G1	1110034-NLA	NLA - Frame, Side, Permanent Arm, Chrome - Right	1	1
14	G,G1	1110035-NLA	NLA - Frame, Side, Permanent Arm, Chrome - Left	1	1
14	G,G1,I, K	8881117018	Frame, Side, Permanent Arm, Color - Right	1	1
14	G,G1,I, K	8881117019	Frame, Side, Permanent Arm, Color - Left	1	1
14	L	8881195772	Frame, Side, Permanent Arm, Color - Right	1	1
14	L	8881195773	Frame, Side, Permanent Arm, Color - Left	1	1
15	G,G1	1110043-NLA	NLA - Frame, Side, Removable Arm, Chrome - Right	1	1
15	G,G1	1110044-NLA	NLA - Frame, Side, Removable Arm, Chrome - Left	1	1
15	G,G1,I, K	8881181857	Frame, Side, Removable Arm, Color - Right	1	1
15	G,G1,I, K	8881181858	Frame, Side, Removable Arm, Color - Left	1	1
15	L	8881195778	Frame, Side, Removable Arm, Color - Right	1	1
15	L	8881195779	Frame, Side, Removable Arm, Color - Left	1	1
16	J	1092392	Frame, Side, Fixed Front, Black - Right	1	1
16	J	1092393	Frame, Side, Fixed Front, Black - Left	1	1

Side Frames & Hardware - EX1 & EX2

Side Frames include the Flange Bearings (2 per side)

Item Number	Note	Part Number	Description	Quantity Per	
				Package	Assembly
16	H,I	8881117022	Frame, Side, Fixed Front, Color - Right	1	1
16	H,I	8881117023	Frame, Side, Fixed Front, Color - Left	1	1
17	G,G1	1096781	Kit, Hinge Pin Replacement Hardware (Pair)	1	1
			NLA - Wrench, Allen (3/32")	1	1
			Cap, Threaded	1	4
			Washer, Locking Split (#10)	1	4
			Screw, Socket Button Head Cap, Regulator (8-32 x 3/8")	1	4
			F,K	1001801	Bearing, Flange (1/2")
	F,L	1192848	Bearing, Flange (5/8")	1	4

NOTE:

- A - Includes items 2-8.
- B - Includes items 2-8 and 10
- C - For use on chairs without anti-tippers.
- D - Includes item 2.
- E - Used in place of plug buttons when anti-tippers are used.
- F - Not shown.
- G - Hinge Pin Replacement Hardware Kit is only used on Side Frames w/ welded-on Hinge Pins manufactured before 4/12/13. Side Frames after 4/11/13 have Hinge Pin Saddle Plates w/ square holes to attach REMOVABLE Non-Welded Hinge Pins.
- G1 - All Side Frames ordered after 4/11/13 require new Side Frame Hardware that will include the removable Hinge Pins also. Removable Hinge Pins are not sold separately.
- H - Uses Bolt Thru hardware to connect footrest to frame.
- I - Specify 71P Silver Vein frame finish when ordering.
- J - After 10/14/14 color changed from Chrome to Black. It is recommended to order both the right and left side to match.
- K - Used Before 03/20/17.
- L - Used After 03/19/17.