

Tray and Side Panel Kits - IH6065 Series

Models 6065A, 6065DA, 6065PT & 6065WD

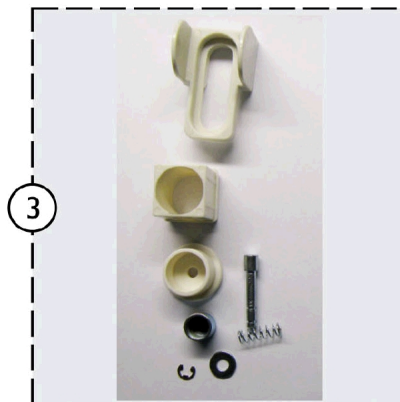
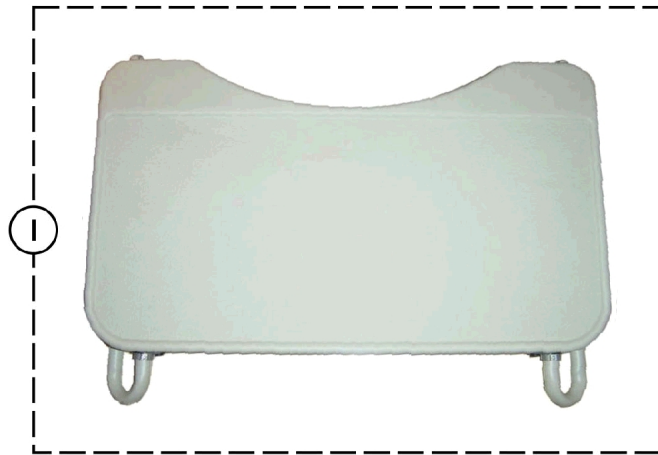

SPT_031A

Tray and Side Panel Kits - IH6065 Series

Models 6065A, 6065DA, 6065PT & 6065WD

Item Number	Note	Part Number	Description	Quantity Per	
				Package	Assembly
1	A	1126611-NLA	NLA - Kit, Side Panels - Plastic (31.8" x 16.8")	1	1
			Panel, Side - Vacuum Formed - Right	1	1
			Panel, Side - Vacuum Formed - Left	1	1
1	A	1164310	Kit, Side Panels - Plastic (32.33" x 17.24")	1	1
			Panel, Side - Vacuum Formed - Right	1	1
			Panel, Side - Vacuum Formed - Left	1	1
2	B,C	1126610	Tray Assembly (For Model IH6065A ONLY)	1	1
3		1134780	Kit, Tray Maintenance	1	1
4	D,E	See Chart	Side Panel Kit	1	1

NOTE: A - To determine which part number to use, measure the outside dimension (length and width) to match part number to order.
 B - Tray Assembly is only available on Model IH6065A.
 C - Includes: Tray, (2) Mounting Tubes and Socket Screws (M5 x 15).
 D - Includes: (2) Upholstery Side Panels and (6) Phillips Head Screws (M5 x 40). Available for Model IH6065DA only. See Chart for colors.
 E - Not Shown.

Side Panel Kits

Model - IH6065DA Only

Model Number/ Upholstery Color	IH60 Rosewood	IH61 Blue Ridge	IH68 Jade
Kit Number	1126628-NLA	1126629-NLA	1126630-NLA