

Mechanical Hardware Kits - IH6065 Series

Models 6065A, 6065DA, 6065PT & 6065WD

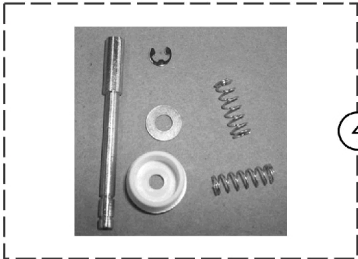
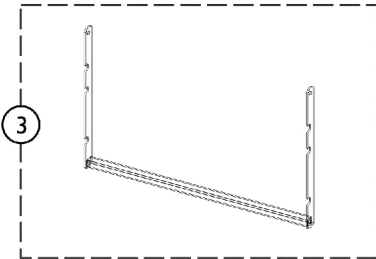
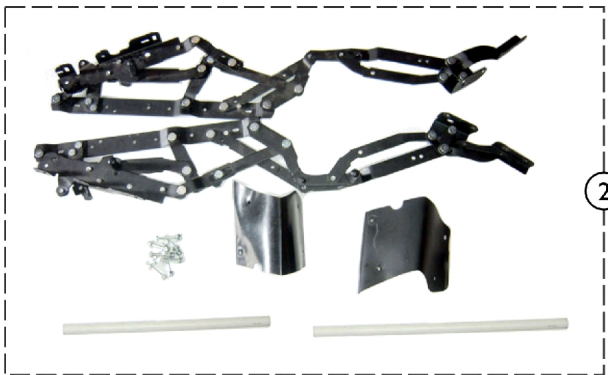

SPT_029A

Mechanical Hardware Kits - IH6065 Series

Models 6065A, 6065DA, 6065PT & 6065WD

Item Number	Note	Part Number	Description	Quantity Per	
				Package	Assembly
1	A,J	1126608	Bar, Push, Back	1	1
2	B	1126609	Reclining Mechanism Assembly w/ Hardware	1	1
3	E	1163960	Ratchet Assembly, Grey - 6065A, 6074A	1	1
3	F	1162517	Ratchet Assembly, Grey - 6065WD	1	1
4	G	1163840	Pin, Plunger w/ Hardware	1	1
5	C	1126607-NLA	NLA - Kit, Hardware	1	1
	F,H	1165494	Bar, Push w/ Attaching Hardware	1	1

NOTE: A - Includes (2) Hex Head Screws (M6 x 55).
 B - Kit includes: (2) Reclining Mechanisms, (2) Finger Guards, (10) Phillips Head Screws (1/4-20 X 1) and (2) Hex Nuts (6mm).
 C - Kit includes: (2) Phillips Head Screws (M6 x 35) with (2) Washers (6mm) and (2) Hex Head Bolts (M6.35 x 50) with (2) Washers (6.35mm).
 E - Use only with IH6065A model.
 F - Use only with IH6065WD model.
 G - Kit includes Plunger Pin (1), Plunger Cap (1), Spring (2) and Washer (1).
 H - Kit includes Hex Head Screw (2), Washers (2) and Handle.
 J - Used with the IH6065A and IH6065DA only.

The Hardware Kit (Item 5) is used to attach the Plastic Skirt to the Chair Frame.