

# Chassis - Camber Hardware

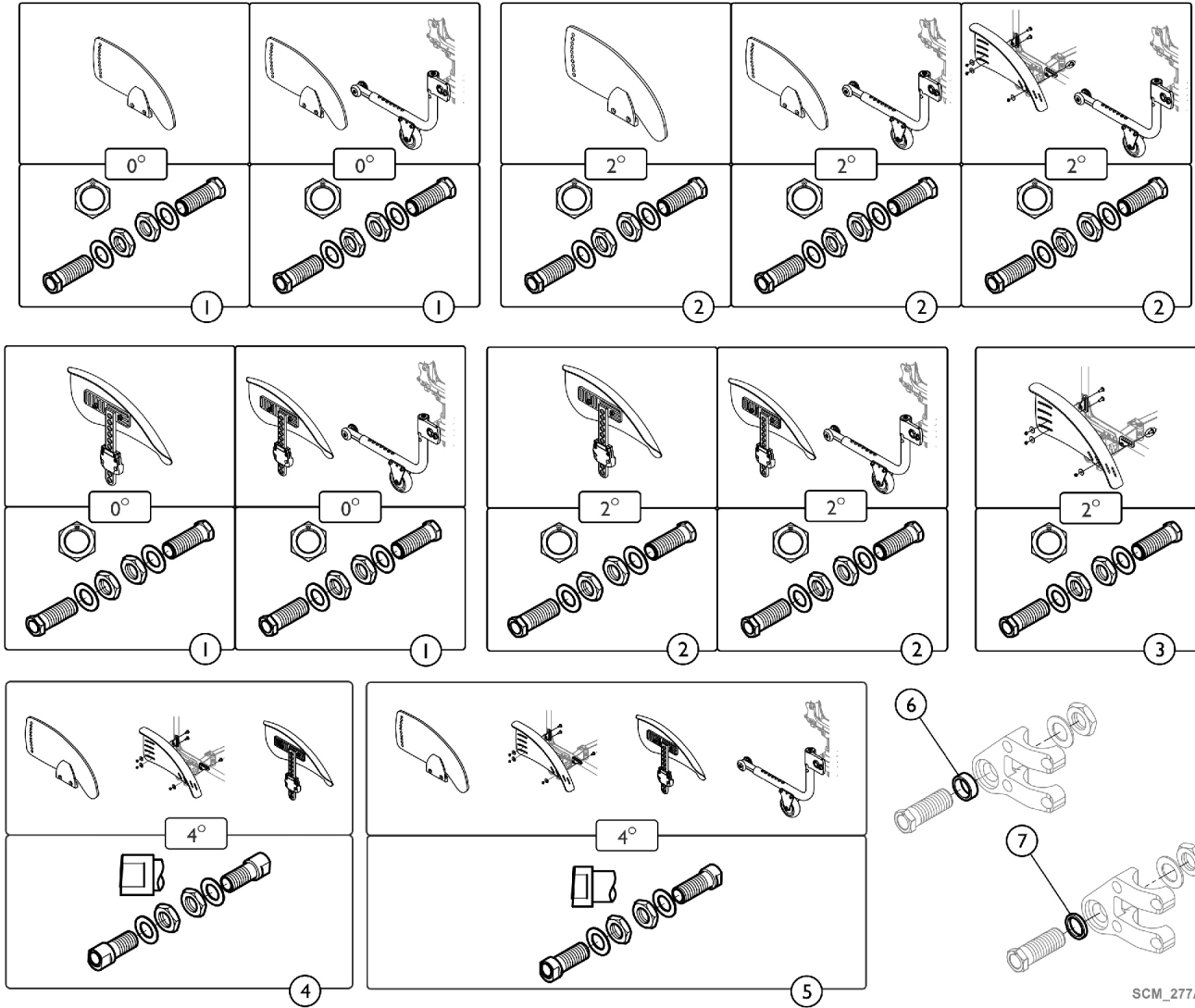

## Chassis - Camber Hardware

Item Number	Note	Part Number	Description	Quantity Per	
				Package	Assembly
1	A,C	SP1589278	Kit, 0° Adapter Sleeve, Head, Short (Pair)	2	1
2	B,D	SP1589279	Kit, 2° Adapter Sleeve, Head, Short (Pair)	2	1
3	E	SP1589280	Kit, 2° Adapter Sleeve, Head, Long (Pair)	2	1
4	F	SP1589281	Kit, 4° Adapter Sleeve, Head, Long (Pair)	2	1
5	G	SP1589282	Kit, 4° Adapter Sleeve, Head, Short (Pair)	2	1
6		SP1589284	Spacer, Adapter Sleeve (7mm) (Pair)	2	1
7		SP1589285	Spacer, Adapter Sleeve (3mm) (Pair)	2	1

NOTE: A - With Clothes Guard or Clothes Guard and Transit Wheel.  
 B - With Clothes Guard, Clothes Guard and Transit Wheel, or Fixed Mudguard and Transit Wheel.  
 C - With Removable Mudguard, Removable Mudguard and Transit Wheel.  
 D - With Removable Mudguard, and Removable Mudguard and Transit Wheel.  
 E - With Fixed Mudguard.  
 F - With Clothes Guard, Removable Mudguard, and Fixed Mudguard.  
 G - With Clothes Guard, Removable Mudguard, Fixed Mudguard, and Transit Wheel.