

# Side Frame and Hardware

**NOTE:** If your chair was built with a serial # starting with "03H" or "03I", please contact an Invacare Parts Specialist for replacement parts at 1-800-333-6900 Ext. 3722.

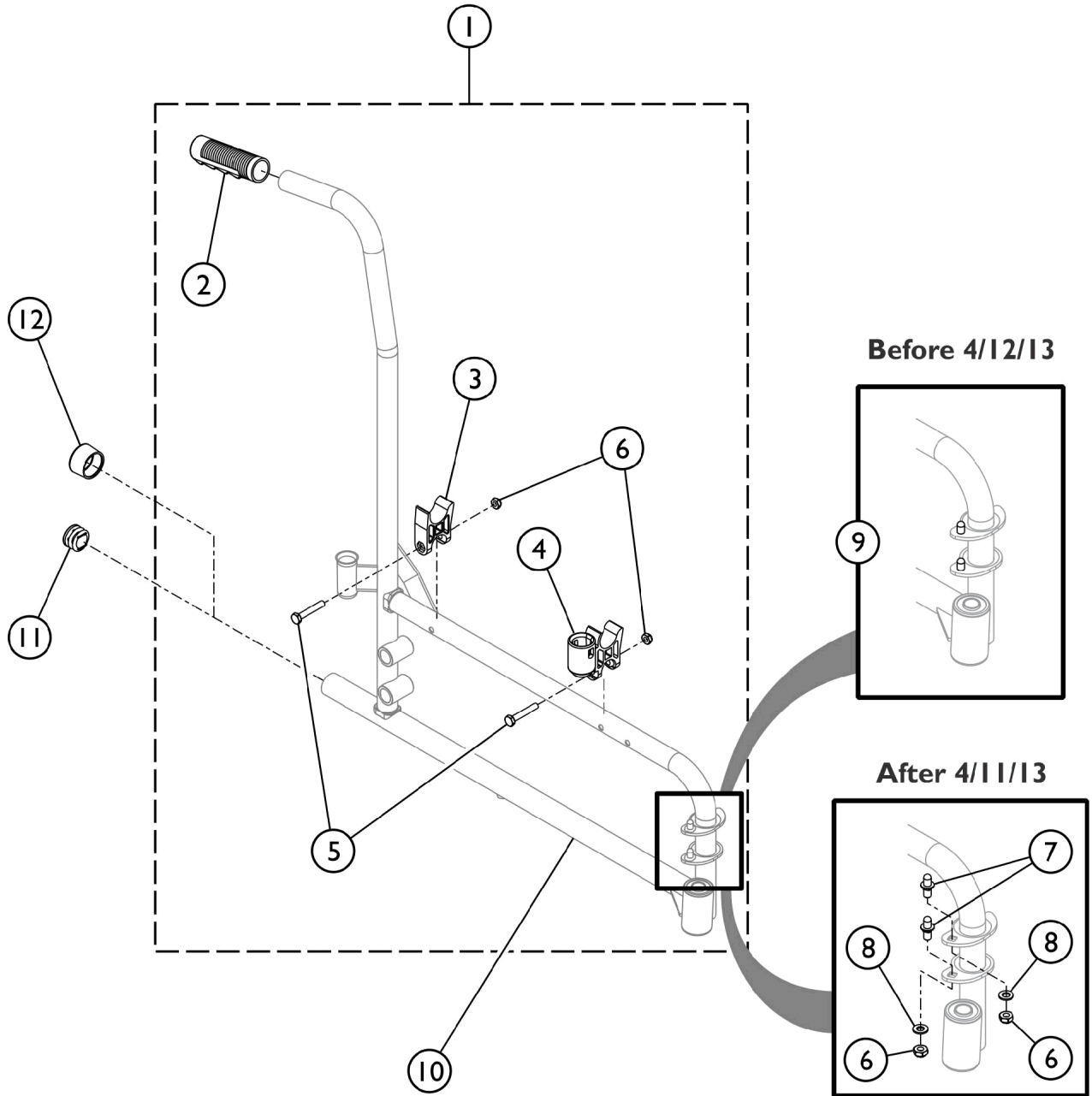

## Side Frame and Hardware

**NOTE: If your chair was built with a serial # starting with "03H" or "03I", please contact an Invacare Parts Specialist for replacement parts at 1-800-333-6900 Ext. 3722.**

Item Number	Note	Part Number	Description	Quantity Per	
				Package	Assembly
1	A	1193615	Kit, Side Frame Hardware (Pair)	1	1
2			Grip, Hand (6")	1	2
3			H-Block	1	2
4			H-Block with Socket Cup	1	2
5			Screw, Hex Head (1/4-20 x 1-1/2")	1	4
6			Locknut (1/4-20)	1	8
7			Pin, Hinge	1	4
8			Washer, Plain (1/4 x 1/2 x 9/16")	1	4
			NLA - Bag, Poly Zip-Lip (8-3/4" L x 6" W)	1	1
			Instruction Sheet, Hand Grip Service	1	1
3		1107805	H-Block	1	2
4		1109938	H-Block with Socket Cup	1	2
5		16720X004	Screw, Hex Head (1/4-20 x 1-1/2")	1	4
6		60275X000	Locknut (1/4-20)	1	4
9	B,C	1096781	Kit, Hinge Pin Replacement Hardware (Pair)	1	1
			NLA - Wrench, Allen (3/32")	1	1
			Cap, Threaded	1	4
			Washer, Locking Split (#10)	1	4
			Screw, Socket Button Head Cap, Regulator (8-32 x 3/8")	1	4
10	B,C,G	1118225	Frame, Side, Black- Right	1	1
10	B,C,G	1118226-NLA	NLA - Frame, Side, Black- Left	1	1
10	H,I	1194252	Frame, Side, Black - Right	1	1
10	H,I	1194245	Frame, Side, Black - Left	1	1
10	B,C,D, G	8881122748	Frame, Side, Color - Right	1	1
10	B,C,D, G	8881122749	Frame, Side, Color - Left	1	1
10	D,H	8881194239	Frame, Side, Color - Right	1	1
10	D,H	8881194354	Frame, Side, Color - Left	1	1
11	E	1029501	Plug Button, Black (1")	1	2
12	F	15680X013	Anti-Rattle (1")	1	2

**NOTE:** A - Kit includes items 2 - 8.  
 B - 1096781, Hinge Pin Replacement Kit is only used on Side Frames (Item 10) w/ welded on Hinge Pins manufactured before (04/01/13).  
 C - Side Frames manufactured after (04/11/13) have Hinge Pin Saddles w/ Square Holes to attach Removable, Non-Welded Hinge Pins.  
 D - All Side Frames ordered after (04/11/13) require new Side Frame Hardware that will include the Removable Hinge Pins also and the removable Hinge Pins cannot be sold separately. Specify 71P Silver Vein when ordering.  
 E - Chairs without Anti-Tippers require Plug Buttons.  
 F - Anti-Rattle used in place of Plug Buttons for Chairs w/ Anti-Tippers.  
 G - Before 10/12/16 bearing size was 1/2" (Before 02/21/17 applies to stock models T4\_WCB22 and T4\_WCB24 only).  
 H - After 10/11/16 bearing size changed to 5/8" (After 02/20/17 applies to stock models T4\_WCB22 and T4\_WCB24 only).  
 I - All Side Frames ordered after (04/11/13) require new Side Frame Hardware that will include the Removable Hinge Pins also and the removable Hinge Pins cannot be sold separately.