

Joystick and Joystick Cables

MPJ+ (MPJM6) and CMPJ+ (CMPJM6) Before S/N D16213304 and Between S/N D16213602-H16146144

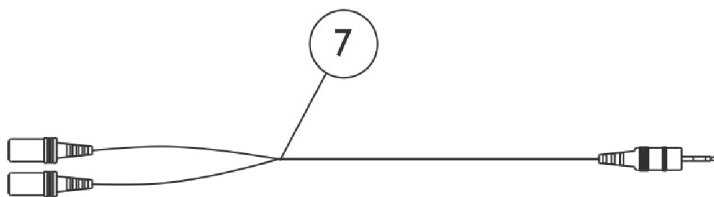

Monoport "Y" Phono Cable (MPY)

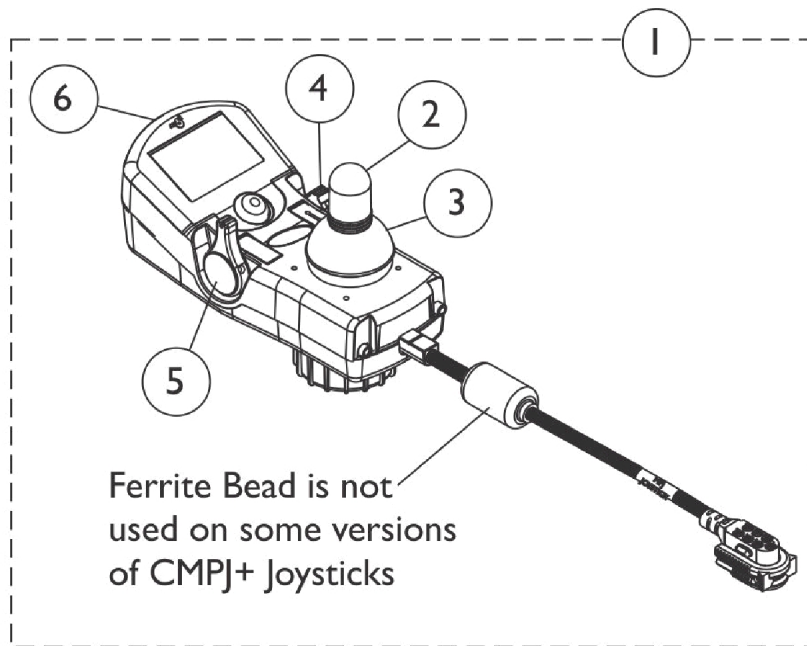
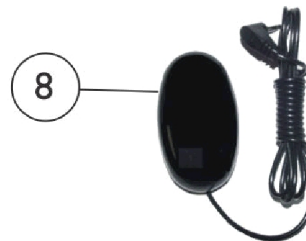

Egg Switch (EGSBLK)

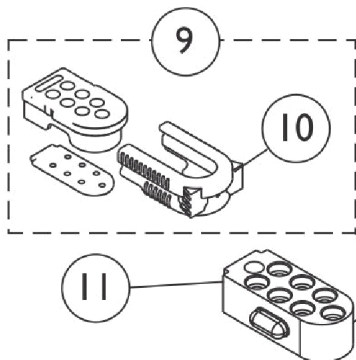

to MPJ+/CMPJ+, Display, or PSR/PSF Joysticks

to Controller

Joystick Extension Cable (MPJ+/CMPJ+ Joysticks)

Joystick and Joystick Cables

**MPJ+ (MPJM6) and CMPJ+ (CMPJM6) Before S/N D16213304 and Between
S/N D16213602-H16146144**

Item Number	Note	Part Number	Description	Quantity Per	
				Package	Assembly
1	A,D	See Note	See Footnote	1	1
1	A,E	1136885E-NLA	NLA - Reconditioned - Joystick, MPJ+ (MPJM6)	1	1
1	A	1164361	Joystick, Color Display, CMPJ+ (CMPJM6)	1	1
1	A	1164361E-NLA	NLA - WARR RPLMT - Joystick, Color Display, CMPJ+ (CMPJM6)	1	1
2		1188691	Knob, Joystick Rubber, Black	1	1
3		1188692	Skirt, Joystick Rubber, Black	1	1
4		1186444	Knob, Speed Adjustment, Black	1	1
5		1186439	Knob, Power/Drive Select, Black	1	1
6		1145074	Package, Cover Slot SD (For MPJM6/CMPJM6 & PSFM6/PSRM6 Joysticks)	10	1
7		1140027	Cable, Monoport "Y" Phono (MPY)	1	1
8		1123276	Kit, Switch, Black Egg Reset w/ Hook/Loop Adhesive Back Fastener & Attaching Screws (EGSBLK)	1	1
9	B	1133182	Cap, Top Connector, 7 Pin, Black	1	1
10	J	1145408-NLA	NLA - Latch, Top Connector, Black	1	1
11		1133183-NLA	NLA - Cap, Bottom Connector, 7 Pin	1	1
12	F	1140038-NLA	NLA - Cable, MK6i Joystick Extension, (PWH) (34" L)	1	1
12	G	1133180	Cable, MK6i Joystick Extension, (PWH) (16" L)	1	1
12	H,H1,I	1140039-NLA	NLA - Cable, MK6i Joystick Extension, (PWH) (58" L)	1	1
	C	1006270	Extension, Joystick, "T" Style (1560) (4" W x 5-1/2" L)	1	1
	C	1006271	Extension, Joystick, Straight Style (1561) (1/2" W x 5" L)	1	1

NOTE: A - Includes items 2-6 also.
 B - Includes Main Body, Gasket, and Latch.
 C - Not Shown
 D - MPJ+ Joystick is no longer available as a service part. See part number 1164361 or 1164361E as a replacement.
 E - Part is no longer available as a service part. See part number 1164361E as a replacement.
 F - Used on Non-Elevate 3G Storm Series wheelchairs Before 12/10/07.
 G - Used on all wheelchairs with multi-purpose joystick (MPJ/CMPJ) (excluding Note F) and WithOut any of the following: Any power seating; LNX/ELRPW power leg options; or any of the electronics in H1. It is used with MPCTMT and conventional actuators.
 H - Used on all wheelchairs with multi-purpose joystick (MPJ/CMPJ) and With any of the following: Any power seating option; LNX/ELRPW power leg options; or With any of the electronics in H1
 H1 - SNPM6, 5018M6, 5020M6, 1558M6, PACM6, 4WSB, S4WSB, AUX12M6, AUX34M6, RFM, IR, SANODE, ELRPW, ELRPW22, LNX, LNX-L. Also used on all Formula seating SMTACT and MPCTMT.
 I - Ferrite Bead added to the CMPJM6 Joystick Cable 3/15/12. CMPJM6 Joystick is compatible to all wheelchairs manufactured before 3/15/12 as well.
 J - Item 10 part #1145408 is No Longer Available separately, order item 9 part #1133182