

# Side Frame Hardware

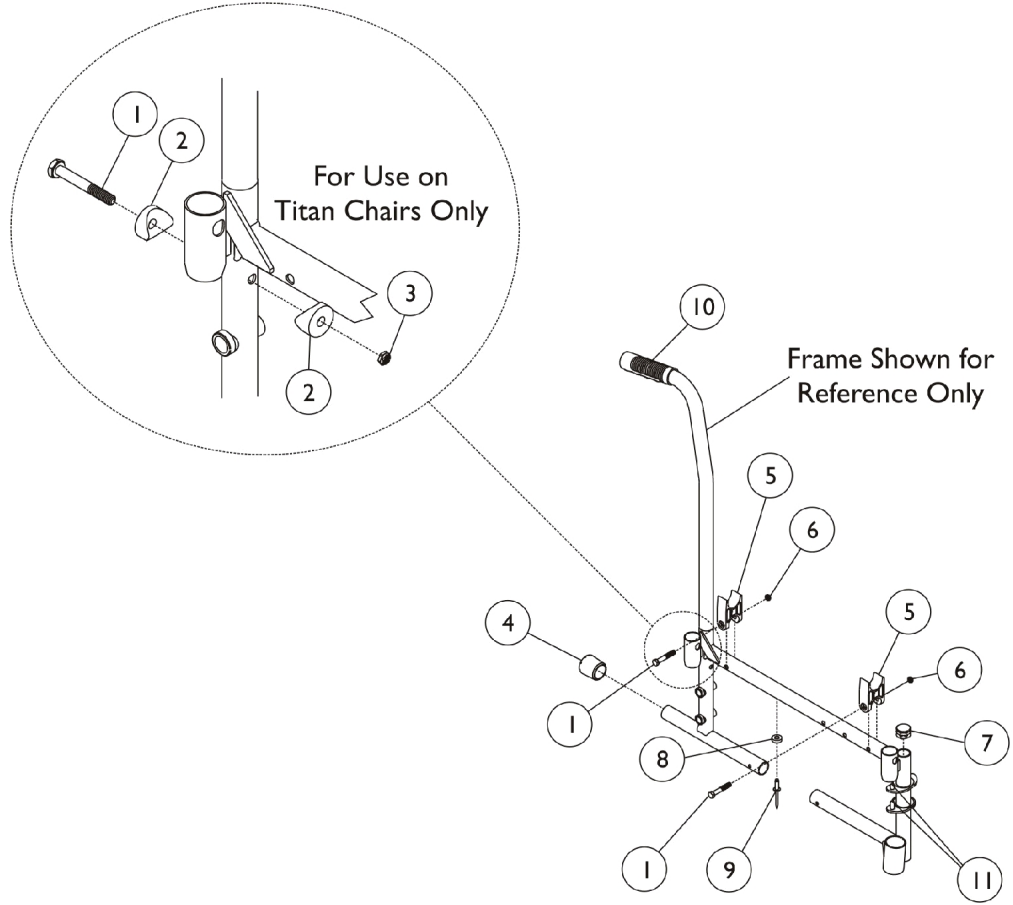

## Side Frame Hardware

Item Number	Note	Part Number	Description	Quantity Per	
				Package	Assembly
1		7930350-NLA	NLA - Package, Hex Head Screw (1/4-20 x 1-1/2")	25	2
2		1026099	Spacer, Coved (1/4 x 11/16 x 1/2")	1	2
3		7930364-NLA	NLA - Package, Locknut (1/4-20)	25	2
4		1016346	Cap, End, Tube, Black (7/8")	1	1
5	A	1107805	H-Block	1	2
6		7930307-NLA	NLA - Locknut (1/4-20")	25	1
7		1027095	Plug Button, Black (7/8")	1	1
8		16347X000-NLA	NLA - Washer, Nylon (3/16 x 7/16 x 1/8")	1	1
9		16348X000-NLA	NLA - Rivet (3/16 x 7/16")	1	1
11		1096781	Kit, Hinge Pin Replacement Hardware (Pair)	1	1
			NLA - Wrench, Allen (3/32")	1	1
			Cap, Threaded	1	4
			Washer, Locking Split (#10)	1	4
			Screw, Socket Button Head Cap, Regulator (8-32 x 3/8")	1	4
	C,J,K	1074067	Hardware, Frame, Side	2	1
	D,J,K	1074599	Hardware, Frame, Side	2	1
	E,J,K	1041812	Hardware, Frame, Side	2	1
	F,J,K	1041814	Hardware, Frame, Side	2	1
	G,J,K	1074615-NLA	NLA - Hardware, Frame, Side	2	1
	H,J,K	1193616	Kit, Side Frame Hardware, Fixed Frame (Pair)	1	1
10			Grip, Hand (6")	1	2
			NLA - Bag, Poly Zip-Lip (8-3/4" L x 6" W)	1	1
			Instruction Sheet, Hand Grip Service	1	1
	I,J,K	1062227	Hardware, Frame, Side	2	1
		See Chart	Back Canes - Titan and CareGuard Titan Only	1	2

NOTE: A - Used on Tracer Series only - See Crossbrace Hardware for MG Seat guides.  
C - Used for Tracer DLX (After 3/13/00) and Tracer SX. Includes Items 1, 3, 4, 5, 7, 8, and 9.  
D - Used for Tracer and CareGuard Titan, and Tracer SX Recliner. Includes Items 1-9.  
E - Used for Tracer EX with Removable Arms. Includes Items 4, 7 and 10.  
F - Used for Tracer EX with Permanent Arms. Includes Items 4 and 10.  
G - Used for Tracer DLX (Before 3/12/00). Includes Items 1, 3, 4, 5 and 7.  
H - Used for Invacare MG and MGI, and for CareGuard Fixed Frame and Permanent Arm Chairs. Includes Item 10.  
I - Used for Invacare MG and MGI, and for CareGuard Removable Arm Chairs. Includes Items 7 and 10.  
J - Includes hardware for both right and left sides.  
K - Not Shown

### Back Canes - Titan and CareGuard Titan Only

Part Number	Back Height
1076624-NLA	15"
1076627-NLA	16"
1076630-NLA	17"
1076633-NLA See Note(s) A	18"
1076636-NLA See Note(s) A	19"

# Side Frame Hardware

NOTE: A - Titan Only