

Conventional Back without Mounting Hardware CGTR/CGTRE (16" - 22" Wide)

NOTE: Extruded back canes come in one back height only. Back cane material height for extruded back canes measure approximately 20-1/2". Overall back height from the seat pan to top of the extruded back cane is approximately 22-1/2". Only the Back Assembly needs to be replaced when changing back heights.

NOTE: Hook Fastener Adhesive Kit must be ordered when a Back Pan or Back Assembly is requested. This will allow the Loop Fastener Adhesive on the Back Cover to attach properly.

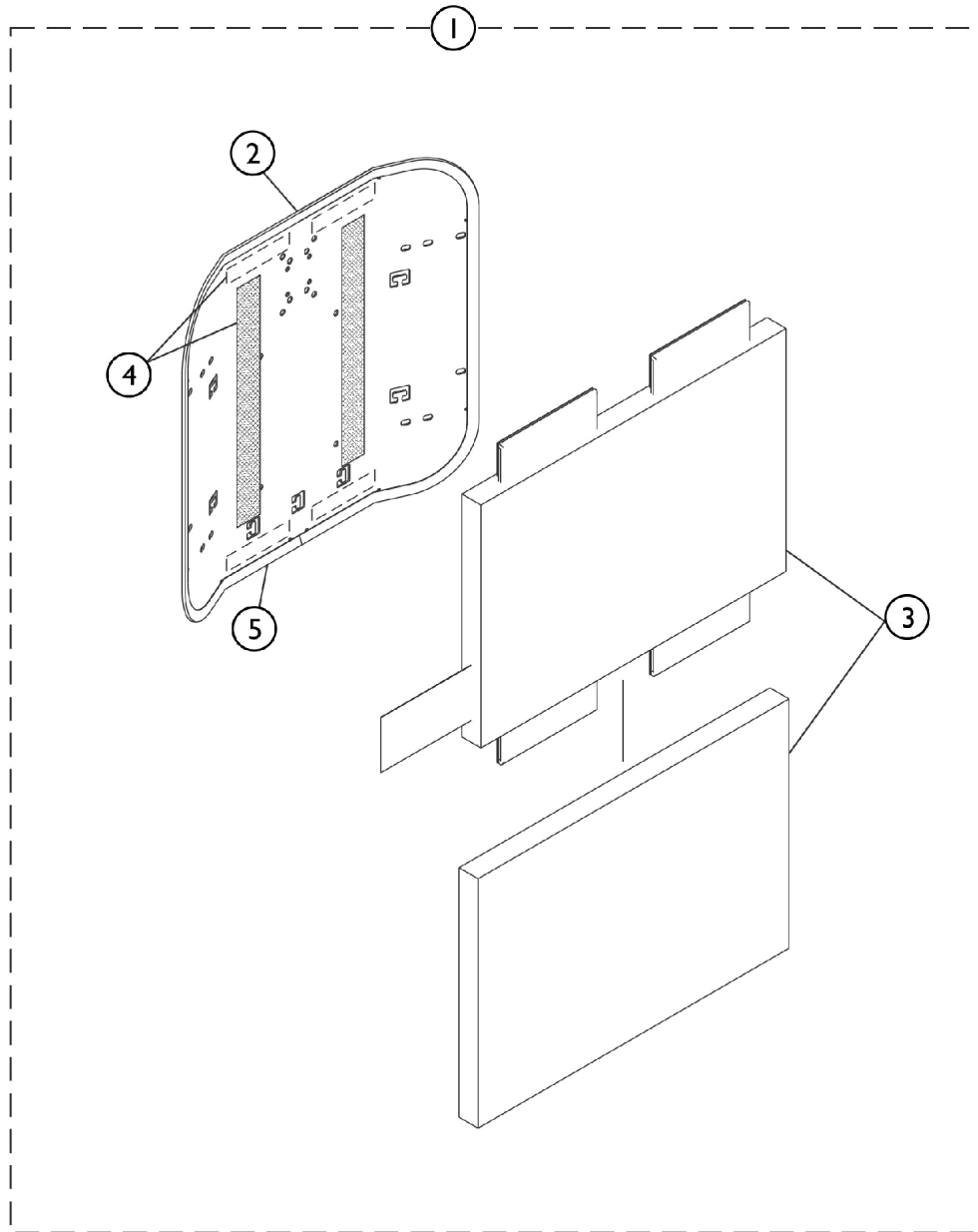

SHEP_100A

Conventional Back without Mounting Hardware CGTR/CGTRE (16" - 22" Wide)

NOTE: Extruded back canes come in one back height only. Back cane material height for extruded back canes measure approximately 20-1/2". Overall back height from the seat pan to top of the extruded back cane is approximately 22-1/2". Only the Back Assembly needs to be replaced when changing back heights.

NOTE: Hook Fastener Adhesive Kit must be ordered when a Back Pan or Back Assembly is requested. This will allow the Loop Fastener Adhesive on the Back Cover to attach properly.

Hook Fastener Adhesive Kit and Trim Edge

Item Number	Note	Part Number	Description	Quantity Per	
				Package	Assembly
1		See Chart	#1 Back Assembly without Hardware 16" - 20" Wide	1	1
1		See Chart	#1 Back Assembly without Hardware 21" - 22" Wide	1	1
2		See Chart	#2 Back Pan with Vinyl Edge Trim 16" - 20" Wide	1	1
2		See Chart	#2 Back Pan with Vinyl Edge Trim 21" - 22" Wide	1	1
3		See Chart	#3 Back Cushion Assembly 16" - 20" Wide	1	1
3		See Chart	#3 Back Cushion Assembly 21" - 22" Wide	1	1
4	A	1125723	Kit, Hook Fastener w/ Adhesive Back	1	1
5		1125724-NLA	NLA - Trim, Edge, Cut-To-Length, Vinyl Black (96" L)	1	1
NOTE: A - Hook Fastener Adhesive kit is used to attach the Back Cover to the Back Pan and must be ordered when a new Back Pan or Back Assembly is requested.					

#1 Back Assembly without Hardware 16" - 20" Wide

Overall Back Height	Material Back Height	16" Wide	17" Wide	18" Wide	19" Wide	20" Wide
20"	15"	1125564	1125565	1125566	1125567	1125568
21"	16"	1125573	1125574	1125575	1125576	1125577
22"	17"	1125582	1125583	1125584	1125585	1125586
23"	18"	1125591	1125592	1125593	1125594	1125595
24"	19"	1125600	1125601	1125602	1125603	1125604
25"	20"	1125609	1125610	1125611	1125612	1125613
26"	21"	1125618	1125619	1125620	1125621	1125622

#1 Back Assembly without Hardware 21" - 22" Wide

Overall Back Height	Material Back Height	21" Wide	22" Wide
20"	15"	1125569	1125570
21"	16"	1125578	1125579
22"	17"	1125587	1125588

Conventional Back without Mounting Hardware CGTR/CGTRE (16" - 22" Wide)

NOTE: Extruded back canes come in one back height only. Back cane material height for extruded back canes measure approximately 20-1/2". Overall back height from the seat pan to top of the extruded back cane is approximately 22-1/2". Only the Back Assembly needs to be replaced when changing back heights.

NOTE: Hook Fastener Adhesive Kit must be ordered when a Back Pan or Back Assembly is requested. This will allow the Loop Fastener Adhesive on the Back Cover to attach properly.

#1 Back Assembly without Hardware 21" - 22" Wide

Overall Back Height	Material Back Height	21" Wide	22" Wide
23"	18"	1125596	1125597
24"	19"	1125605	1125606
25"	20"	1125614	1125615
26"	21"	1125623	1125624

Conventional Back without Mounting Hardware CGTR/CGTRE (16" - 22" Wide)

NOTE: Extruded back canes come in one back height only. Back cane material height for extruded back canes measure approximately 20-1/2". Overall back height from the seat pan to top of the extruded back cane is approximately 22-1/2". Only the Back Assembly needs to be replaced when changing back heights.

NOTE: Hook Fastener Adhesive Kit must be ordered when a Back Pan or Back Assembly is requested. This will allow the Loop Fastener Adhesive on the Back Cover to attach properly.

#2 Back Pan with Vinyl Edge Trim 16" - 20" Wide

Overall Back Height	Material Back Height	16" Wide	17" Wide	18" Wide	19" Wide	20" Wide
20"	15"	1124578	1124585	1124592	1124599	1124606
21"	16"	1124579	1124586	1124593	1124600	1124607
22"	17"	1124580	1124587	1124594	1124601	1124608
23"	18"	1124581	1124588	1124595	1124602	1124609
24"	19"	1124582	1124589	1124596	1124603	1124610
25"	20"	1124583	1124590	1124597	1124604	1124611
26"	21"	1124584	1124591	1124598	1124605	1124612

#2 Back Pan with Vinyl Edge Trim 21" - 22" Wide

Overall Back Height	Material Back Height	21" Wide	22" Wide
20"	15"	1124613	1124620
21"	16"	1124614	1124621
22"	17"	1124615	1124622
23"	18"	1124616	1124623
24"	19"	1124617	1124624
25"	20"	1124618	1124625
26"	21"	1124619	1124626

Hook Adhesive is not included with the Back Pan

Conventional Back without Mounting Hardware CGTR/CGTRE (16" - 22" Wide)

NOTE: Extruded back canes come in one back height only. Back cane material height for extruded back canes measure approximately 20-1/2". Overall back height from the seat pan to top of the extruded back cane is approximately 22-1/2". Only the Back Assembly needs to be replaced when changing back heights.

NOTE: Hook Fastener Adhesive Kit must be ordered when a Back Pan or Back Assembly is requested. This will allow the Loop Fastener Adhesive on the Back Cover to attach properly.

#3 Back Cushion Assembly 16" - 20" Wide

Overall Back Height	Material Back Height	16" Wide	17" Wide	18" Wide	19" Wide	20" Wide
20"	15"	1097397	1097398	1097399	1097400	1097401
21"	16"	1097404	1097405	1097406	1097407	1097408
22"	17"	1097411	1097412	1097413	1097414	1097415
23"	18"	1097418	1097419	1097420	1097421	1097422
24"	19"	1097425	1097426	1097427	1097428	1097429
25"	20"	1097432	1097433	1097434	1097435	1097436
26"	21"	1097439	1097440	1097441	1097442	1097443

Back cover and foam are sold as a back cushion assembly only. Chart reflects chair width and the actual back cushion width will be 1" wider than the chair width.

#3 Back Cushion Assembly 21" - 22" Wide

Overall Back Height	Material Back Height	21" Wide	22" Wide
20"	15"	1097402	1125543
21"	16"	1097409	1125546
22"	17"	1097416	1125549
23"	18"	1097423	1125552
24"	19"	1097430	1125555
25"	20"	1097437	1125558
26"	21"	1097444	1125561

Back cover and foam are sold as a back cushion assembly only. Chart reflects chair width and the actual back cushion width will be 1" wider than the chair width.