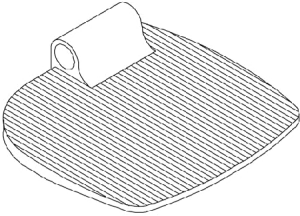
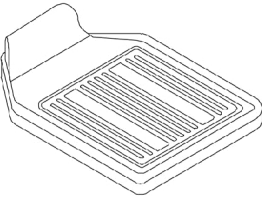
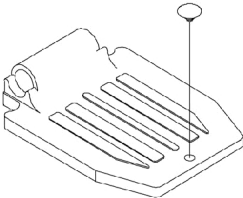

Pivot/Slide Tube and Footplate

P904, PH904A, PAL4A, PHAL4A

NOTE: Heel Loops are not included. See footrest and legrest accessories.

NOTE: For complete pivot slide tube and footplate assemblies, see front riggings reference chart.

		
1350 Extra large	1450 Deluxe	1650 Standard Aluminum

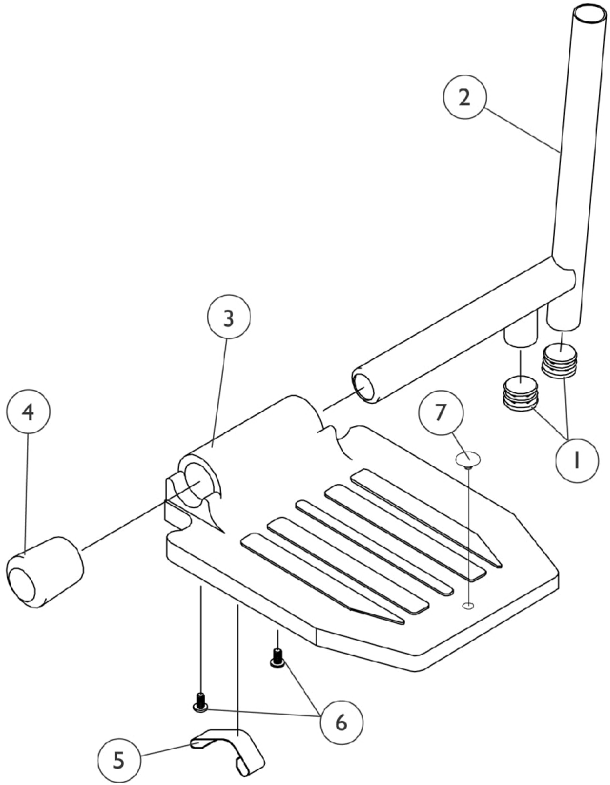

Pivot/Slide Tube and Footplate

P904, PH904A, PAL4A, PHAL4A

NOTE: Heel Loops are not included. See footrest and legrest accessories.

NOTE: For complete pivot slide tube and footplate assemblies, see front riggings reference chart.

Item Number	Note	Part Number	Description	Quantity Per	
				Package	Assembly
1		1027097	Plug Button, Black (3/4")	1	2
2	A,C	1100568-NLA	NLA - Pivot/Slide Tube w/ Plug Button, Black	1	1
2	A,D	1041526	Pivot/Slide Tube w/ Plug Button Assembly, Chrome	1	1
2	B,C	1100571-NLA	NLA - Pivot/Slide Tube w/ Plug Button, Deluxe, Black	1	1
2	B,D,J	1023804-NLA	NLA - Pivot/Slide Tube w/ Plug Button, Deluxe, Chrome	1	1
3		44200X027	Footplate, Aluminum, Medium, Black (7-3/4" W x 6" L)	1	1
3		1043659-NLA	NLA - Footplate, Aluminum, Deluxe, Black - Right (8" W x 5-3/4" L)	1	1
3		1043660-NLA	NLA - Footplate, Aluminum, Deluxe, Black - Left (8" W x 5-3/4" L)	1	1
3		44200X025	Footplate, Aluminum, Extra Large, Black - Right (8" W x 8-1/2" L)	1	1
3		44200X026	Footplate, Aluminum, Extra Large, Black - Left (8" W x 8-1/2" L)	1	1
4	G	1016346	Cap, End, Tube, Black (7/8")	1	1
4	I	1027095	Plug Button, Black (7/8")	1	1
5	G	1006981	Spring, Tension	1	1
5	E,H	1036120-NLA	NLA - Spring	1	1
5	I,K	1036123	Spring, Leaf	1	1
6		40120X001	Screw, Phillips Pan Head (#8-32 x 3/8")	1	2
7		1070168	Plug, Push, Footplate	1	1

NOTE: A - Standard Aluminum (1650) and Extra Large Aluminum (1350)
 B - Deluxe Aluminum (1450)
 C - P904A and PH904A
 D - PAL4A and PHAL4A
 E - Two per side
 G - Standard Aluminum Footplate
 H - Deluxe Aluminum Footplate
 I - Extra Large Aluminum Footplate
 J - Part #1023804 is no longer available as a service part individually. See category titled "Front Rigging Reference Chart" and order part #1023924 or 1023925 Pivot/Slide Tube and Footplate Assembly (Deluxe Aluminum - 1450) as a replacement.
 K - Use one or more leaf springs per assembly as required such that footplate may be moved by hand to the up-right position and remain in place.