

# 3" Suction Cup Option

## Model 6314

### FITS ON MODELS

6451, 6451S, 6461  
6461S, 6431, 6481  
6484, 9670's, 9871's  
9872's, 9873's, 98070

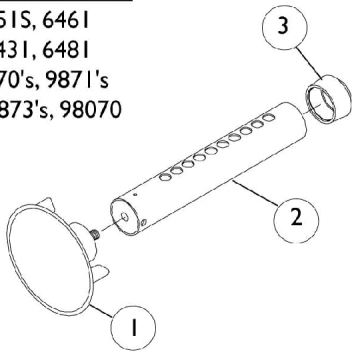

## Model 6316

### FITS ON MODELS

1362, 1363, 9680's,  
9681's, 9690P, 9691P,  
97080, 97081, 97090,  
97091, 50's, 60's, 75's,  
85's

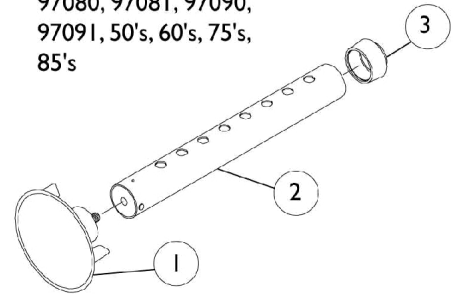

## 3" Suction Cup Option

Item Number	Note	Part Number	Description	Quantity Per	
				Package	Assembly
1	A,B	12711X001-NLA	NLA - Cup, Suction	1	2
2	A,C	1022927-NLA	NLA - Tube, Leg Extension	1	2
2	B,D	1064509-NLA	NLA - Tube, Leg Extension	1	2
3	A,B	1063124	Anti-Rattle, Grey (1-1/8")	1	2
<p>NOTE: A - To be used with Model 6314.            B - To be used with Model 6316.            C - Anti-Rattle Included.            D - Anti-Rattle Not Included.</p> <p>NOTE: It is Recommended when replacing the Suction Cup Option for Models 6541, 6451S, 6461, 6461S, 6481, and 6484, after 3/2/98, also replace the Snap Buttons and Release Springs.            Model 6314 FITS ON MODELS: 6451, 6451S, 6461, 6461S, 6431, 6481, 6484, 9670's, 9871's, 9872's, 9873's and 98070.            Model 6316 FITS ON MODELS: 1362, 1363, 9680's, 9681's, 9690P, 9691P, 97080, 97081, 97090, 97091, 50's, 60's, 75's, and 85's.</p>					