

Conventional Fixed Height - Black Finish

NOTE: If your chair was built with a serial # starting with "03H" or "03I", please contact an Invacare Parts Specialist for replacement parts at 1-800-333-6900 Ext. 3722.

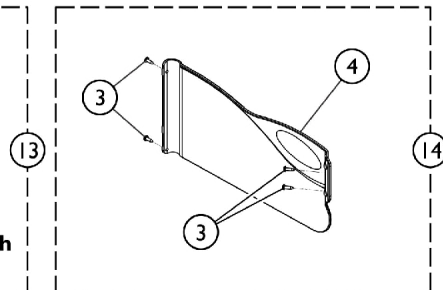
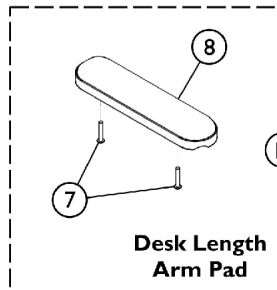
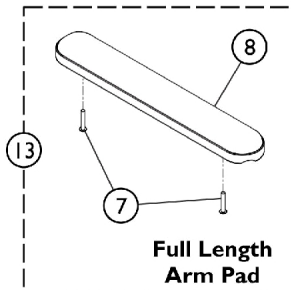
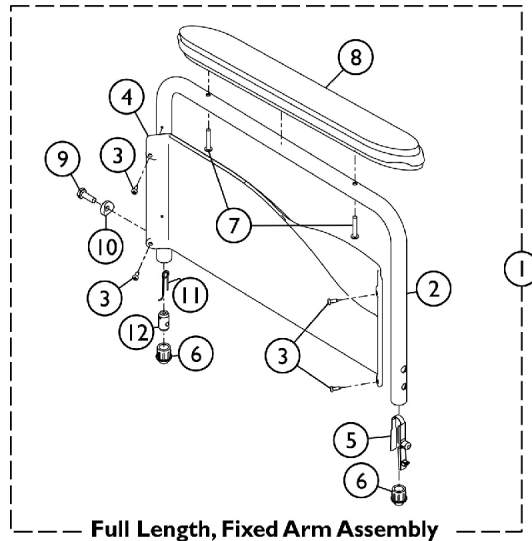
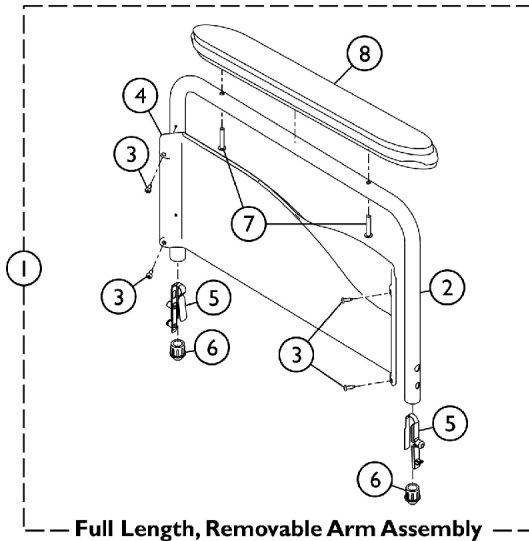
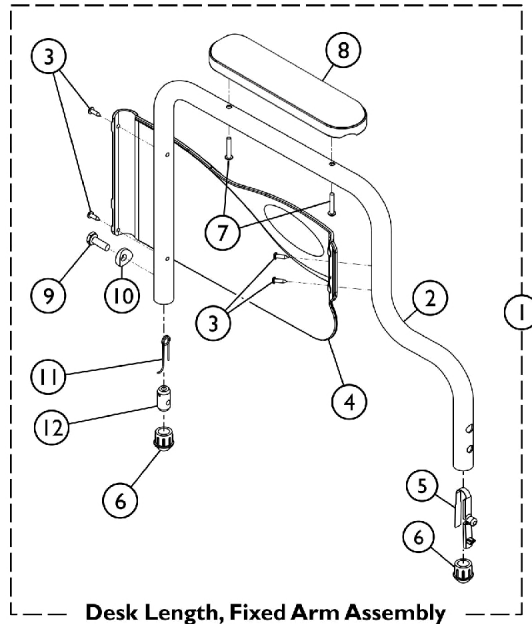
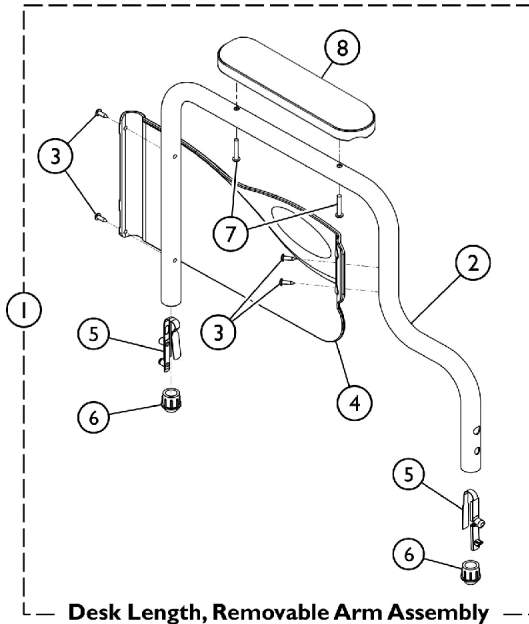

SSM_010B

Conventional Fixed Height - Black Finish

NOTE: If your chair was built with a serial # starting with "03H" or "03I", please contact an Invacare Parts Specialist for replacement parts at 1-800-333-6900 Ext. 3722.

Item Number	Note	Part Number	Description	Quantity Per	
				Package	Assembly
1	A,B	8881127565	Kit, Armrest, Desk Length, Black - Right (Style 28)	1	1
2			Armrest, Desk Length, Black - Right	1	1
3			Screw, Self Tapping (#6-20 x 1/2")	1	4
4			NLA - Guard, Clothing, Desk Length - Right	1	1
5			Spring, Torsion w/ Button Lock	1	2
6			Plug, Armrest, Black (3/4") (18GA)	1	2
7			Package, Screw Phillips Pan Head (#10-32 x 1-1/8")	1	2
8			Arm Pad, Desk Length w/ Law Label	1	1
1	A,B	8881127563	Kit, Armrest, Desk Length, Black - Left (Style 28)	1	1
2			Armrest, Desk Length, Black- Left	1	1
3			Screw, Self Tapping (#6-20 x 1/2")	1	4
4			NLA - Guard, Clothing, Desk Length - Left	1	1
5			Spring, Torsion w/ Button Lock	1	2
6			Plug, Armrest, Black (3/4") (18GA)	1	2
7			Package, Screw Phillips Pan Head (#10-32 x 1-1/8")	1	2
8			Arm Pad, Desk Length w/ Law Label	1	1
1	C,D	8881127566	Kit, Armrest, Desk Length, Black - Right (Style 28)	1	1
2			Armrest, Desk Length, Black - Right	1	1
3			Screw, Self Tapping (#6-20 x 1/2")	1	4
4			NLA - Guard, Clothing, Desk Length - Right	1	1
5			Spring, Torsion w/ Button Lock	1	1
6			Plug, Armrest, Black (3/4") (18GA)	1	2
7			Package, Screw Phillips Pan Head (#10-32 x 1-1/8")	1	2
8			Arm Pad, Desk Length w/ Law Label	1	1
9			NLA - Bolt, Hex Head Cap (1/4-20 x 3/4")	1	1
10			Spacer, Coved (1/4 x 11/16 x 1/2")	1	1
11			Spring, Release	1	1
12			Insert, Threaded	1	1
1	C,D	8881127564	Kit, Armrest, Desk Length, Black - Left (Style 28)	1	1
2			Armrest, Desk Length, Black- Left	1	1
3			Screw, Self Tapping (#6-20 x 1/2")	1	4
4			NLA - Guard, Clothing, Desk Length - Left	1	1
5			Spring, Torsion w/ Button Lock	1	1
6			Plug, Armrest, Black (3/4") (18GA)	1	2
7			Package, Screw Phillips Pan Head (#10-32 x 1-1/8")	1	2
8			Arm Pad, Desk Length w/ Law Label	1	1
9			NLA - Bolt, Hex Head Cap (1/4-20 x 3/4")	1	1
10			Spacer, Coved (1/4 x 11/16 x 1/2")	1	1
11			Spring, Release	1	1
12			Insert, Threaded	1	1
1	A,B	8881127569	Kit, Armrest, Full Length, Black - Right (Style 18)	1	1
2			Armrest, Full Length, Black - Right	1	1
3			Guard, Clothing, Full Length - Right	1	1
4			Screw, Self Tapping (#6-20 x 1/2")	1	4
5			Spring, Torsion w/ Button Lock	1	2

Conventional Fixed Height - Black Finish

NOTE: If your chair was built with a serial # starting with "03H" or "03I", please contact an Invacare Parts Specialist for replacement parts at 1-800-333-6900 Ext. 3722.

Item Number	Note	Part Number	Description	Quantity Per	
				Package	Assembly
6	A,B	8881127567	Plug, Armrest, Black (3/4") (18GA)	1	2
7			Package, Screw Phillips Pan Head (#10-32 x 1-1/8")	1	2
8			NLA - Pad, Arm, Full Length w/ Law Label	1	1
1			Kit, Armrest, Full Length, Black - Left (Style 18)	1	1
2			Armrest, Full Length, Black - Left	1	1
3			Guard, Clothing, Full Length - Left	1	1
4			Screw, Self Tapping (#6-20 x 1/2")	1	4
5			Spring, Torsion w/ Button Lock	1	2
6	C,D	8881127570	Plug, Armrest, Black (3/4") (18GA)	1	2
7			Package, Screw Phillips Pan Head (#10-32 x 1-1/8")	1	2
8			NLA - Pad, Arm, Full Length w/ Law Label	1	1
1			Kit, Armrest, Full Length, Black - Right (Style 18)	1	1
2			Armrest, Full Length, Black - Right	1	1
3			Screw, Self Tapping (#6-20 x 1/2")	1	4
4			Guard, Clothing, Full Length - Right	1	1
5			Spring, Torsion w/ Button Lock	1	1
6			Plug, Armrest, Black (3/4") (18GA)	1	2
7			Package, Screw Phillips Pan Head (#10-32 x 1-1/8")	1	2
8			NLA - Pad, Arm, Full Length w/ Law Label	1	1
9			NLA - Bolt, Hex Head Cap (1/4-20 x 3/4")	1	1
10	C,D	8881127568	Spacer, Coved (1/4 x 11/16 x 1/2")	1	1
11			Spring, Release	1	1
12			Insert, Threaded	1	1
1			Kit, Armrest, Full Length, Black - Left (Style 18)	1	1
2			Armrest, Full Length, Black - Left	1	1
3			Screw, Self Tapping (#6-20 x 1/2")	1	4
4			Guard, Clothing, Full Length - Left	1	1
5			Spring, Torsion w/ Button Lock	1	1
6			Plug, Armrest, Black (3/4") (18GA)	1	2
7			Package, Screw Phillips Pan Head (#10-32 x 1-1/8")	1	2
8			NLA - Pad, Arm, Full Length w/ Law Label	1	1
9			NLA - Bolt, Hex Head Cap (1/4-20 x 3/4")	1	1
10	E	8881127509	Spacer, Coved (1/4 x 11/16 x 1/2")	1	1
11			Spring, Release	1	1
12			Insert, Threaded	1	1
13	E	8881127510	Kit, Arm Pad w/Screws - Full Length	1	1
7			Package, Screw Phillips Pan Head (#10-32 x 1-1/8")	2	1
8			NLA - Pad, Arm, Full Length w/ Law Label	1	1
13	E	8881127510	Kit, Arm Pad w/Screws - Desk Length	1	1
7			Package, Screw Phillips Pan Head (#10-32 x 1-1/8")	2	1
8			Arm Pad, Desk Length w/ Law Label	1	1
14	F	1117365	Kit, Clothing Guard, Conventional, Desk Length w/ Screws and Decals (Pair)	1	1
14	F	1117366	Kit, Clothing Guards - Conventional, Full Length w/ Screws & Decals	1	1

Conventional Fixed Height - Black Finish

NOTE: If your chair was built with a serial # starting with "03H" or "03I", please contact an Invacare Parts Specialist for replacement parts at 1-800-333-6900 Ext. 3722.

NOTE:	A - Removable Arm. B - Includes items 2-8. C - Non-Removable Arm. D - Includes items 2-12. E - Includes items 7 and 8. F - Includes (1) each right and left clothing guard and attaching hardware.
-------	---