

# Conventional Adjustable Height Arms - Chrome and Black Finish

NOTE: If your chair was built with a serial number starting with "03H" or "03I", please contact an Invacare Parts Specialist for replacement parts at 1-800-333-6900 Ext. 3722.

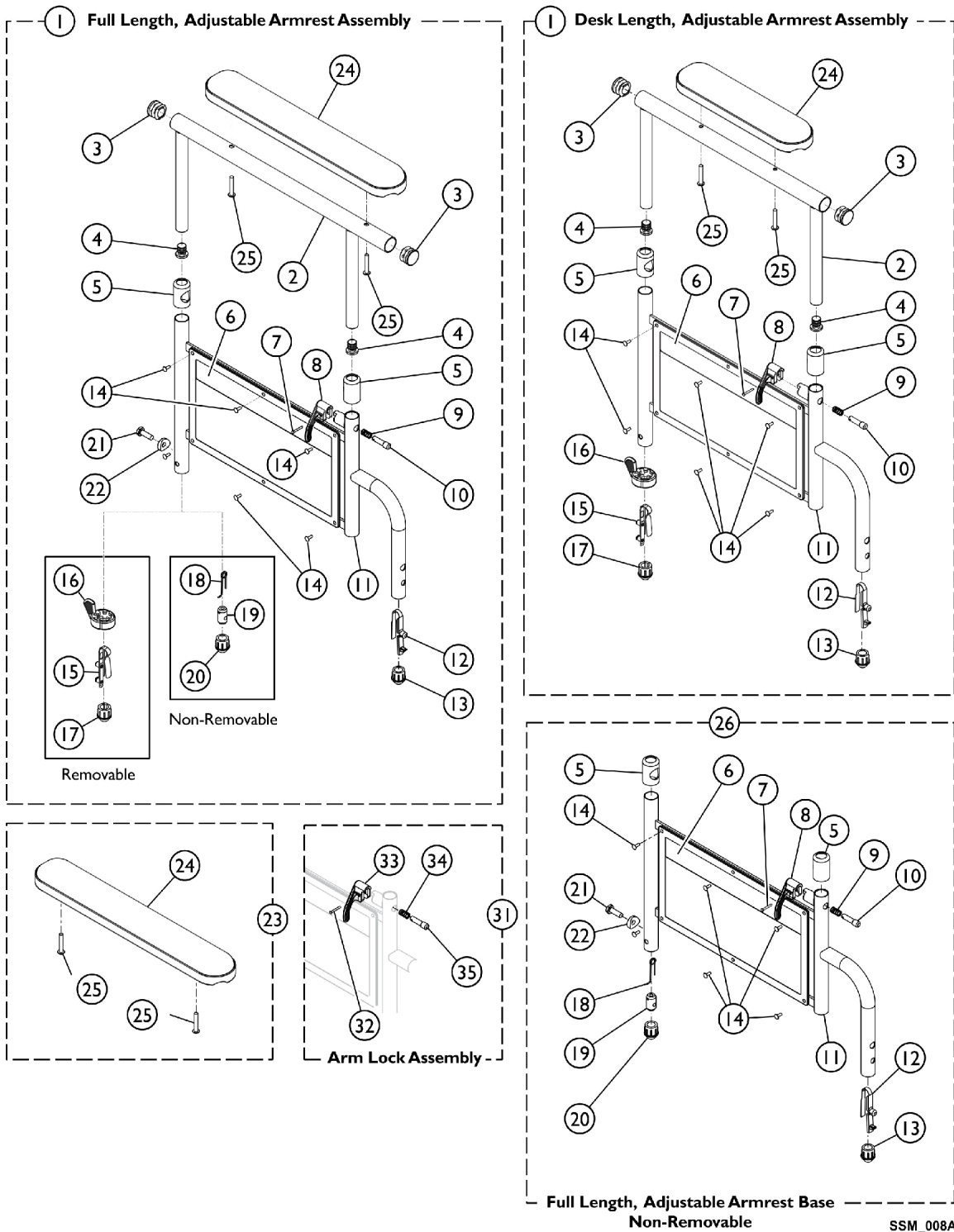

# Conventional Adjustable Height Arms - Chrome and Black Finish

**NOTE: If your chair was built with a serial number starting with "03H" or "03I", please contact an Invacare Parts Specialist for replacement parts at 1-800-333-6900 Ext. 3722.**

Item Number	Note	Part Number	Description	Quantity Per			
				Package	Assembly		
1	A,B,J	8881127561	Kit, Armrest, Full Length, Black - Right (Style 19)	1	1		
2			Tube, Arm, Full Length, Black	1	1		
3			Plug Button, Black (7/8")	2	1		
4			Plug Button, Black (5/8")	2	1		
5			Anti-Rattle	2	1		
6			Guard, Clothing	1	1		
7			Rivet, Tubular	1	1		
8			Handle, Lock, Black - Right	1	1		
9			Spring, Arm Lock	1	1		
10			Pin, Locking	1	1		
11			Armrest, Adjustable Height, Black	1	1		
12			Spring, Torsion w/ Button Lock	1	1		
13			Plug, Armrest, Black (3/4") (18GA)	1	1		
14			Rivet	6	1		
15			Spring, Torsion with Button Lock	1	1		
16			Handle, Quad Release	1	1		
17			Plug Button, Arm Tube, Black (3/4")	1	1		
24			NLA - Pad, Arm, Full Length w/ Law Label	1	1		
25			Package, Screw Phillips Pan Head (#10-32 x 1-1/8")	2	1		
1			A,B,J	8881127456	Kit, Armrest, Full Length, Black - Left (Style 19)	1	1
2					Tube, Arm, Full Length, Black	1	1
3					Plug Button, Black (7/8")	1	2
4					Plug Button, Black (5/8")	1	2
5					Anti-Rattle	1	2
6	Guard, Clothing	1			1		
7	Rivet, Tubular	1			1		
8	Handle, Lock, Black - Left	1			1		
9	Spring, Arm Lock	1			1		
10	Pin, Locking	1			1		
11	Armrest, Adjustable Height, Black	1			1		
12	Spring, Torsion w/ Button Lock	1			1		
13	Plug, Armrest, Black (3/4") (18GA)	1			1		
14	Rivet	1			6		
15	Spring, Torsion with Button Lock	1			1		
16	Handle, Quad Release	1			1		
17	Plug Button, Arm Tube, Black (3/4")	1			1		
24	NLA - Pad, Arm, Full Length w/ Law Label	1			1		
25	Package, Screw Phillips Pan Head (#10-32 x 1-1/8")	1			1		
1	A,B,J	8881135513			Kit, Armrest, Desk Length, Black - Right (Style 29)	1	1
2					Tube, Arm, Desk Length, Black	1	1
3					Plug Button, Black (7/8")	1	2
4					Plug Button, Black (5/8")	1	2
5					Anti-Rattle	1	2
6			Guard, Clothing	1	1		

# Conventional Adjustable Height Arms - Chrome and Black Finish

**NOTE: If your chair was built with a serial number starting with "03H" or "03I", please contact an Invacare Parts Specialist for replacement parts at 1-800-333-6900 Ext. 3722.**

Item Number	Note	Part Number	Description	Quantity Per	
				Package	Assembly
7			Rivet, Tubular	1	1
8			Handle, Lock, Black - Right	1	1
9			Spring, Arm Lock	1	1
10			Pin, Locking	1	1
11			Armrest, Adjustable Height, Black	1	1
12			Spring, Torsion w/ Button Lock	1	1
13			Plug, Armrest, Black (3/4") (18GA)	1	1
14			Rivet	1	6
15			Spring, Torsion with Button Lock	1	1
16			Handle, Quad Release	1	1
17			Plug Button, Arm Tube, Black (3/4")	1	1
24			Arm Pad, Desk Length w/ Law Label	1	1
25			Package, Screw Phillips Pan Head (#10-32 x 1-1/8")	2	1
1	A,B,J	8881135514	Kit, Armrest, Desk Length, Black - Left (Style 29)	1	1
2			Tube, Arm, Desk Length, Black	1	1
3			Plug Button, Black (7/8")	1	2
4			Plug Button, Black (5/8")	1	2
5			Anti-Rattle	1	2
6			Guard, Clothing	1	1
7			Rivet, Tubular	1	1
8			Handle, Lock, Black - Left	1	1
9			Spring, Arm Lock	1	1
10			Pin, Locking	1	1
11			Armrest, Adjustable Height, Black	1	1
12			Spring, Torsion w/ Button Lock	1	1
13			Plug, Armrest, Black (3/4") (18GA)	1	1
14			Rivet	1	6
15			Spring, Torsion with Button Lock	1	1
16			Handle, Quad Release	1	1
17			Plug Button, Arm Tube, Black (3/4")	1	1
24			Arm Pad, Desk Length w/ Law Label	1	1
25			Package, Screw Phillips Pan Head (#10-32 x 1-1/8")	2	1
1	C,D,J	8881127562	Kit, Armrest, Full Length, Black- Right (Style 19)	1	1
2			Tube, Arm, Full Length, Black	1	1
3			Plug Button, Black (7/8")	1	2
4			Plug Button, Black (5/8")	1	2
5			Anti-Rattle	1	2
6			Guard, Clothing	1	1
7			Rivet, Tubular	1	1
8			Handle, Lock, Black - Right	1	1
9			Spring, Arm Lock	1	1
10			Pin, Locking	1	1
11			Armrest, Adjustable Height, Black	1	1
12			Spring, Torsion w/ Button Lock	1	1

# Conventional Adjustable Height Arms - Chrome and Black Finish

**NOTE: If your chair was built with a serial number starting with "03H" or "03I", please contact an Invacare Parts Specialist for replacement parts at 1-800-333-6900 Ext. 3722.**

Item Number	Note	Part Number	Description	Quantity Per	
				Package	Assembly
13			Plug, Armrest, Black (3/4") (18GA)	1	1
14			Rivet	1	6
18			Spring, Release	1	1
19			Insert, Threaded	1	1
20			Plug, Armrest, Black (3/4") (20GA)	1	1
21			NLA - Bolt, Hex Head Cap (1/4-20 x 3/4")	1	1
22			Spacer, Coved (1/4 x 11/16 x 1/2")	1	1
24			NLA - Pad, Arm, Full Length w/ Law Label	1	1
25			Package, Screw Phillips Pan Head (#10-32 x 1-1/8")	1	2
1	C,D,J	8881127560	Kit, Armrest, Full Length, Black- Left (Style 19)	1	1
2			Tube, Arm, Full Length, Black	1	1
3			Plug Button, Black (7/8")	1	2
4			Plug Button, Black (5/8")	1	2
5			Anti-Rattle	1	2
6			Guard, Clothing	1	1
7			Rivet, Tubular	1	1
8			Handle, Lock, Black - Left	1	1
9			Spring, Arm Lock	1	1
10			Pin, Locking	1	1
11			Armrest, Adjustable Height, Black	1	1
12			Spring, Torsion w/ Button Lock	1	1
13			Plug, Armrest, Black (3/4") (18GA)	1	1
14			Rivet	1	6
18			Spring, Release	1	1
19			Insert, Threaded	1	1
20			Plug, Armrest, Black (3/4") (20GA)	1	1
21			NLA - Bolt, Hex Head Cap (1/4-20 x 3/4")	1	1
22			Spacer, Coved (1/4 x 11/16 x 1/2")	1	1
24			NLA - Pad, Arm, Full Length w/ Law Label	1	1
25			Package, Screw Phillips Pan Head (#10-32 x 1-1/8")	1	2
23	E,J	8881127510	Kit, Arm Pad w/Screws - Desk Length	1	1
24			Arm Pad, Desk Length w/ Law Label	1	1
25			Package, Screw Phillips Pan Head (#10-32 x 1-1/8")	2	1
23	E,J	8881127509	Kit, Arm Pad w/Screws - Full Length	1	1
24			NLA - Pad, Arm, Full Length w/ Law Label	1	1
25			Package, Screw Phillips Pan Head (#10-32 x 1-1/8")	2	1
26	C,F,H	1121162	Kit, Armrest Base, Adjustable, Non-removable, Black - Right	1	1
5			Anti-Rattle	1	2
6			Guard, Clothing	1	1
7			Rivet, Tubular	1	1
8			Handle, Lock, Black - Right	1	1
9			Spring, Arm Lock	1	1
10			Pin, Locking	1	1

# Conventional Adjustable Height Arms - Chrome and Black Finish

**NOTE: If your chair was built with a serial number starting with "03H" or "03I", please contact an Invacare Parts Specialist for replacement parts at 1-800-333-6900 Ext. 3722.**

Item Number	Note	Part Number	Description	Quantity Per	
				Package	Assembly
11			Armrest, Adjustable Height, Black	1	1
12			Spring, Torsion w/ Button Lock	1	1
13			Plug, Armrest, Black (3/4") (18GA)	1	1
14			Rivet	1	6
18			Spring, Release	1	1
19			Insert, Threaded	1	1
20			Plug, Armrest, Black (3/4") (20GA)	1	1
21			NLA - Bolt, Hex Head Cap (1/4-20 x 3/4")	1	1
22			Spacer, Coved (1/4 x 11/16 x 1/2")	1	1
26	C,F,H	1121163	Kit, Armrest Base, Adjustable, Non-removeable, Black - Left	1	1
5			Anti-Rattle	1	2
6			Guard, Clothing	1	1
7			Rivet, Tubular	1	1
8			Handle, Lock, Black - Left	1	1
9			Spring, Arm Lock	1	1
10			Pin, Locking	1	1
11			Armrest, Adjustable Height, Black	1	1
12			Spring, Torsion w/ Button Lock	1	1
13			Plug, Armrest, Black (3/4") (18GA)	1	1
14			Rivet	1	6
18			Spring, Release	1	1
19			Insert, Threaded	1	1
20			Plug, Armrest, Black (3/4") (20GA)	1	1
21			NLA - Bolt, Hex Head Cap (1/4-20 x 3/4")	1	1
22			Spacer, Coved (1/4 x 11/16 x 1/2")	1	1
26	G,H	1038460-NLA	NLA - Arm Tube Assembly w/ Plug Buttons, Desk Length, Black - Right/Left	1	1
31	I	7100053	Arm Lock Assembly, Black - Right	1	1
32			Rivet, Tubular	1	2
33			Handle, Lock, Black - Right	1	1
34			Spring, Arm Lock	1	2
35			Pin, Locking	1	2
31	I	7100054	Arm Lock Assembly, Black - Left	1	1
32			Rivet, Tubular	1	2
33			Handle, Lock, Black - Left	1	1
34			Spring, Arm Lock	1	2
35			Pin, Locking	1	2

# Conventional Adjustable Height Arms - Chrome and Black Finish

**NOTE: If your chair was built with a serial number starting with "03H" or "03I", please contact an Invacare Parts Specialist for replacement parts at 1-800-333-6900 Ext. 3722.**

NOTE: A - Removable Arm.  
B - Includes items 2-17, 24 and 25.  
C - Non-Removable.  
D - Includes items 2-14, 18-22, 24 and 25.  
E - Includes items 24 and 25.  
F - Includes items 5-14 and 18-22.  
G - Includes items 2-4.  
H - Please contact an Invacare Parts Specialist to order this item.  
I - Includes items 32-35.  
J - Specify upholstery color when ordering, see category titled "Frame Finishes, Packaging, Literature and Upholstery".