

Profile Back Assembly

Fixed

Basic Tilt & Tilt Only

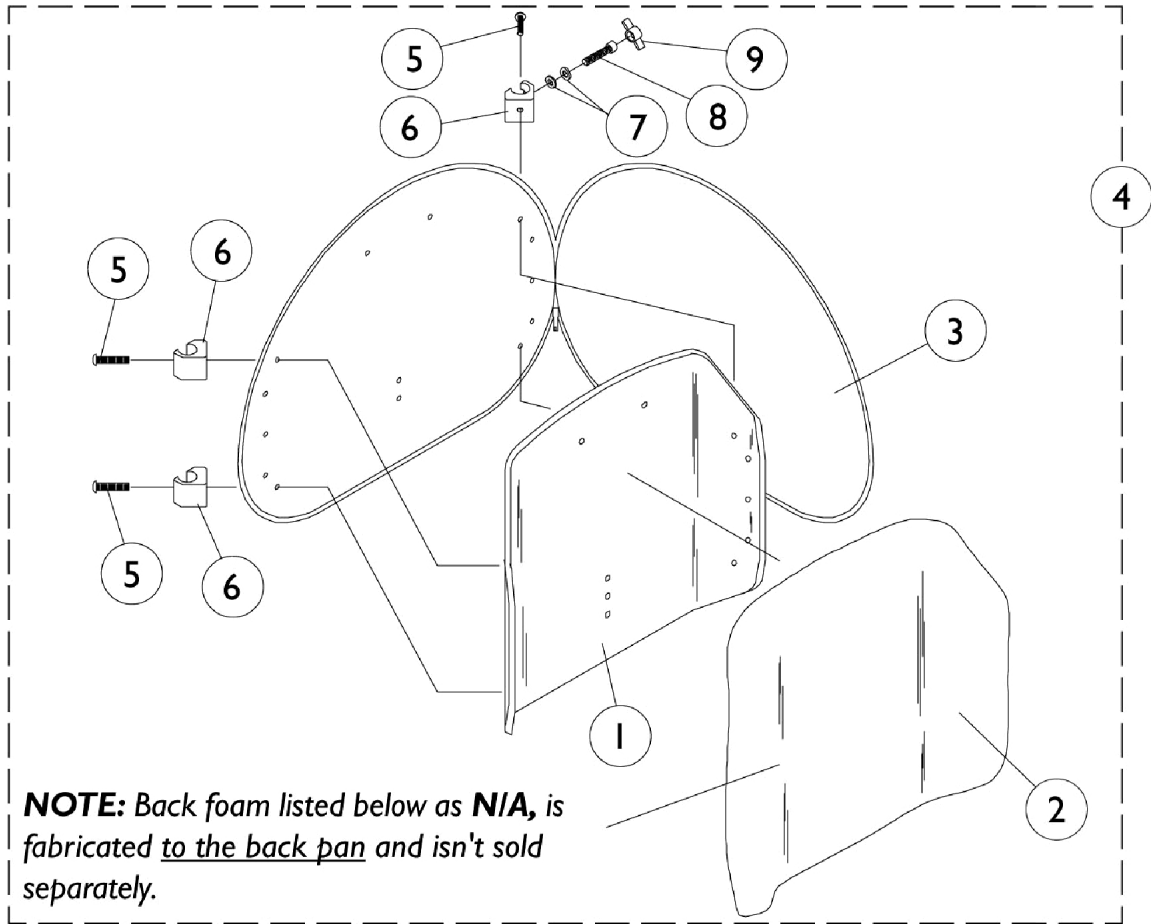

NOTE: Back foam listed below as **N/A**, is fabricated to the back pan and isn't sold separately.

Profile Back Assembly

Fixed

Basic Tilt & Tilt Only

Material Back Width x Height	Overall Back Height	Item #1 Back Pan	Item #2 Back Foam	Item #3 Back Cover	Item #4 Back Asbly w/Fixed Hdwr
16" x 16"	20"-21"H	0133019-NLA	0259220-NLA	0276800-NLA	1072912-NLA
17" x 16"	20"-21"H	0133019-NLA	0259220-NLA	0276800-NLA	1072913-NLA
18" x 16"	20"-21"H	0133119-NLA	0259120-NLA	0276900-NLA	1072914-NLA
19" x 16"	20"-21"H	0133119-NLA	0259120-NLA	0276900-NLA	1072915-NLA
20" x 16"	20"-21"H	0133219-NLA	N/A	0277000-NLA	1072916-NLA
16" x 18"	22"-24"H	0133319-NLA	N/A	0277100	1072917-NLA
17" x 18"	22"-24"H	0133319-NLA	N/A	0277100	1072918-NLA
18" x 18"	22"-24"H	0133419-NLA	0259020-NLA	0277200	1072919-NLA
19" x 18"	22"-24"H	0133419-NLA	0259020-NLA	0277200	1072920-NLA
20" x 18"	22"-24"H	0133519	N/A	0277300-NLA	1072921-NLA

Profile Back Assembly

Fixed

Basic Tilt & Tilt Only

Item Number	Note	Part Number	Description	Quantity Per	
				Package	Assembly
1-4		See Chart	#'s 1-4 Profile Back Assembly (Fixed)	1	1
5	B	0052906-NLA	NLA - Screw, Socket Button Head (1/4-20 x 3/4")	1	4
5	C	0051206-NLA	NLA - Screw, Machine, Hex Socket, Button Head (1/4-20 x 1-1/4)	1	4
6		0190500-NLA	NLA - Block, Glide (16", 18" and 20" Wide)	1	4
6		0190600-NLA	NLA - Block, Glide (17" and 19" Wide)	1	4
7		0050100-NLA	NLA - Washer, Nylon Flat (1/4 x 1/2 x 1/16")	1	4
8		7930304-NLA	NLA - Screw, Socket Head (1/4-20 x 1-1/4")	25	2
9		0226500-NLA	NLA - Knob, Tee	1	2
	A,D	0143900-NLA	NLA - Flap, Back Pan - Tarsys	1	1
	A,E	0144000-NLA	NLA - Flap, Back Pan - Tarsys	1	1
	A,F	0144100-NLA	NLA - Flap, Back Pan - Tarsys	1	1
NOTE: A - Not Shown B - 16"/18"/20" Wide C - 17"/19" Wide D - 16"-17" Wide E - 18"-19" Wide F - 20" Wide					