

Amputee Attachment

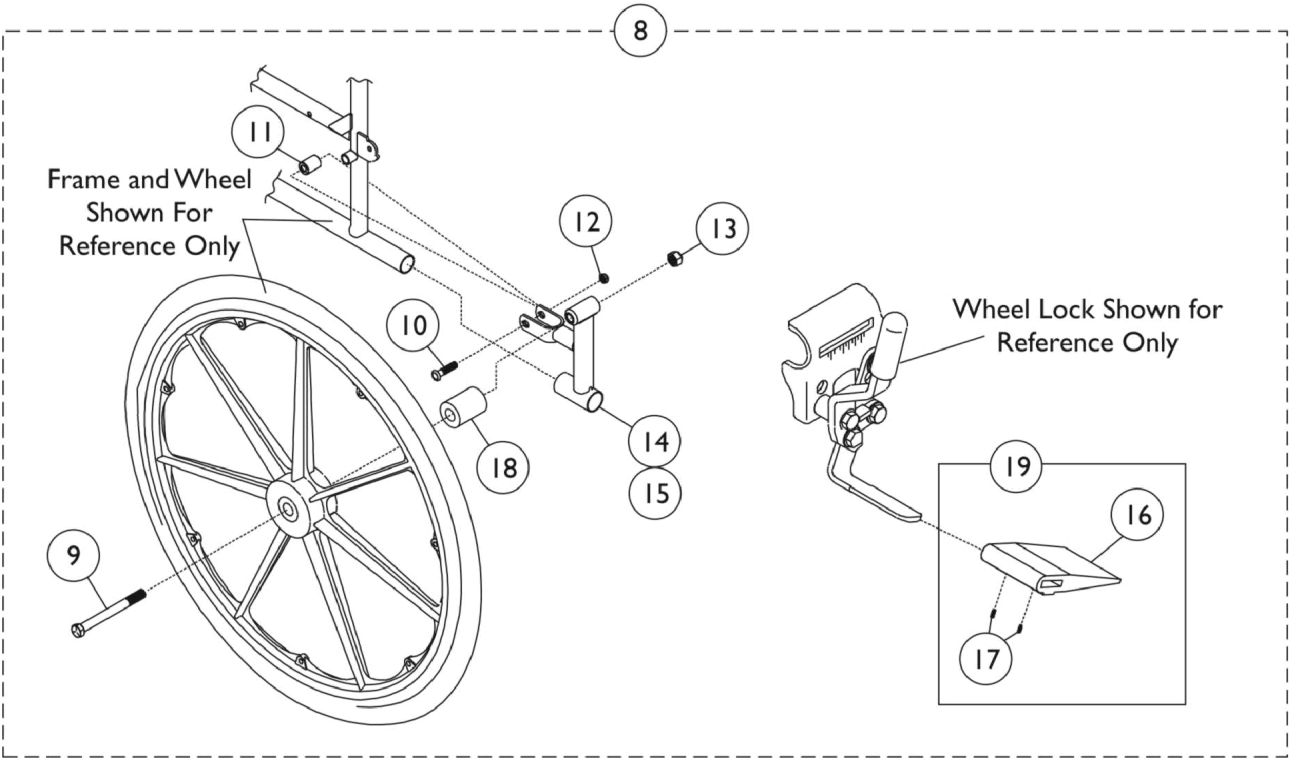
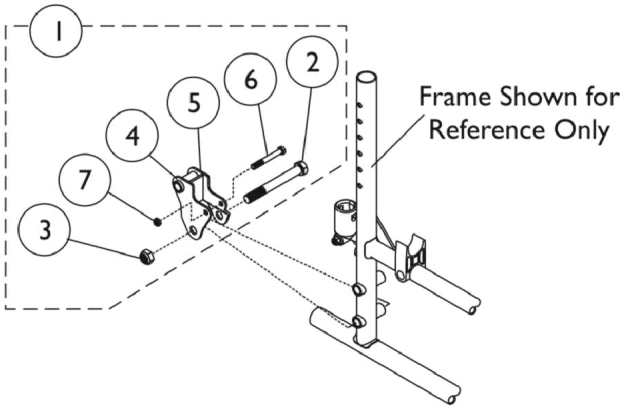

Amputee Attachment

Item Number	Note	Part Number	Description	Quantity Per	
				Package	Assembly
1	B,J	1182781	Kit, Amputee Attachment, Black (Pair)	1	1
2			NLA - Screw, Hex Head (7/16-20 x 2-1/2")	1	2
3			Locknut (7/16-20)	1	2
4			Bracket, Amputee, Black - Right Adult/ Left Hemi	1	1
5			Bracket, Amputee, Black - Left Adult/ Right Hemi	1	1
6			Screw, Hex Head (1/4-20 x 1-1/2")	1	2
7			Locknut (1/4-20)	1	2
8	A,C,E	1064054	Kit, Amputee Attachment, Black (Pair)	1	1
9			Bolt, Hex Head Cap (7/16-20 x 4-3/4")	1	2
10			Screw, Hex Head (5/16-24 x 1-1/2")	1	2
11			NLA - Spacer, Chrome (5/16 x 11/16 x 15/16")	1	2
12			Locknut (5/16-24)	1	2
13			Locknut (7/16-20)	1	2
14			Bracket, Amputee, Black - Right	1	1
15			Bracket, Amputee, Black - Left	1	1
16			Spacer, Wheel Lock Shoe (2-7/16")	1	2
17			Screw, Set Socket Cup Point (#8-32 x 3/16")	1	4
			Instruction Sheet	1	1
8	A,D,F	1065224	Kit, Amputee Attachment, Black (Pair)	1	1
9			Screw, Hex Head Cap (7/16-20 x 5-1/2")	1	2
10			Screw, Hex Head (5/16-24 x 1-1/2")	1	2
11			NLA - Spacer, Chrome (5/16 x 11/16 x 15/16")	1	2
12			Locknut (5/16-24)	1	2
13			Locknut (7/16-20)	1	2
14			Bracket, Amputee, Black - Right	1	1
15			Bracket, Amputee, Black - Left	1	1
16			Spacer, Wheel Lock Shoe (2-7/16")	1	2
17			Screw, Set Socket Cup Point (#8-32 x 3/16")	1	4
18			Spacer (7/16 x 5/8 x 1/2")	1	2
			Instruction Sheet	1	1
8	A,D,E	1182824	Kit, Amputee Attachment, Black (Pair)	1	1
9			Screw, Hex Head Cap (7/16-20 x 5-1/2")	1	2
10			Screw, Hex Head (5/16-24 x 1-1/2")	1	2
11			NLA - Spacer, Chrome (5/16 x 11/16 x 15/16")	1	2
12			Locknut (5/16-24)	1	2
13			Locknut (7/16-20)	1	2
14			Bracket, Amputee, Black - Right	1	1
15			Bracket, Amputee, Black - Left	1	1
16			Spacer, Wheel Lock Shoe (2-7/16")	1	2
17			Screw, Set Socket Cup Point (#8-32 x 3/16")	1	4
18			Spacer (7/16 x 5/8 x 1/2")	1	2
			Instruction Sheet	1	1
8	A,C,F	1182825	Kit, Amputee Attachment, Black (Pair)	1	1
9			Bolt, Hex Head Cap (7/16-20 x 4-3/4")	1	2
10			Screw, Hex Head (5/16-24 x 1-1/2")	1	2
11			NLA - Spacer, Chrome (5/16 x 11/16 x 15/16")	1	2
12			Locknut (5/16-24)	1	2

Amputee Attachment

Item Number	Note	Part Number	Description	Quantity Per	
				Package	Assembly
13			Locknut (7/16-20)	1	2
14			Bracket, Amputee, Black - Right	1	1
15			Bracket, Amputee, Black - Left	1	1
16			Spacer, Wheel Lock Shoe (2-7/16")	1	2
17			Screw, Set Socket Cup Point (#8-32 x 3/16")	1	4
			Instruction Sheet	1	1
19	C,G,I	1048656	Kit, Wheel Lock Shoe Spacer	1	1
16			Spacer, Wheel Lock Shoe (1-45/64")	1	1
17			Screw, Set Socket Cup Point (#8-32 x 3/16")	1	2
19	D,H,I	7400109	Kit, Wheel Lock Shoe Spacer (Pair)	1	1
17			Screw, Set Socket Cup Point (#8-32 x 3/16")	1	4
16			Spacer, Wheel Lock Shoe (2-7/16")	1	2
NOTE: A - Instruction sheet not shown. B - Includes items 2-7. C - To be used on Super Low chairs with space saver arm styles. D - To be used on Super Low chairs with conventional arm styles. E - Includes items 9-18 and instruction sheet. F - Includes items 9-18 and instruction sheet. G - Chairs with 20" or 22" rear wheels, order (2) of part # 1048656 for both sides of chair. H - 9000XDT Chairs with 19" - 20" seat depth, order (1) of part # 7400109 for both sides of chair. I - Includes items 16 and 17. J - For use on Adult or Hemi chairs.					