

# Control Panel and P.C. Board

## All Models Except Platinum 5 (Before 12/15/00)

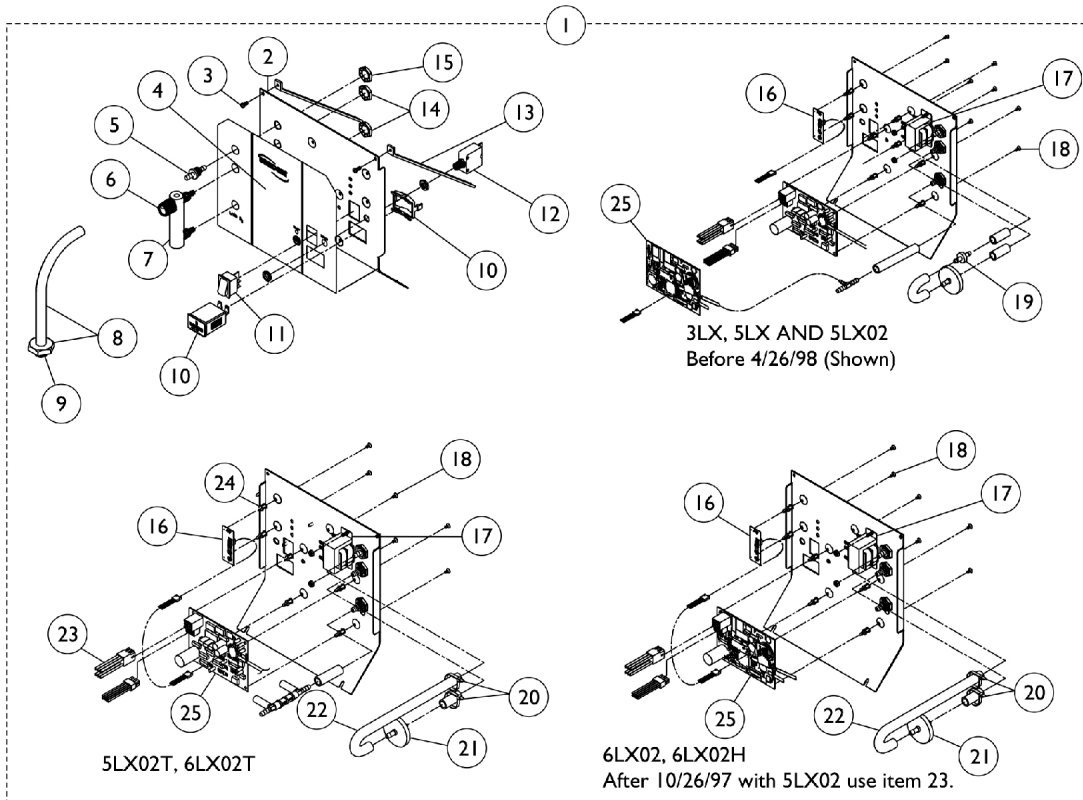

1128379

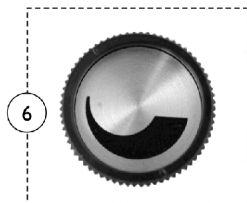

Used with Flowmeters that  
have an Indented Phillips  
Head Screw on top.

1128380

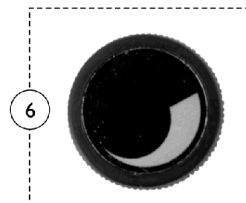

Used with Flowmeters that  
have a Slotted Head Screw  
on top.

## Control Panel and P.C. Board

### All Models Except Platinum 5 (Before 12/15/00)

Item Number	Note	Part Number	Description	Quantity Per	
				Package	Assembly
1		1101585-NLA	NLA - Control Panel Assembly - IRC3LX	1	1
1		1101584	Control Panel Assembly - IRC5LX	1	1
1		1101583	Control Panel Assembly - IRC5LX02	1	1
1		1073754-NLA	NLA - Control Panel Assembly - IRC5LX02T	1	1
1		1101582	Control Panel Assembly - IRC6LX02/ IRC6LX02H	1	1
1		1073752	Control Panel Assembly - IRC6LX02T	1	1
2		2001769-NLA	NLA - Panel, Control	1	1
3		40120X001	Screw, Phillips Pan Head (#8-32 x 3/8")	1	2
4		1080809-NLA	Label, Control Panel, English - IRC3LX	1	1
4		2002356-NLA	NLA - Label, Control Panel, English - IRC5LX	1	1
4		2002355-NLA	NLA - Label, Control Panel, English - IRC5LX02, 5LX02T	1	1
4		1074670	Label, Control Panel, English - IRC6LX02, 6LX02T, 6LX02H	1	1
4		1079329	Label, Control Panel, French Canadian - IRC5LX	1	1
4		1079330	Label, Control Panel, French Canadian - IRC5LX02	1	1
4		1079331	Label, Control Panel, French Canadian - IRC6LX02	1	1
4		1079324	Label, Control Panel, Spanish - IRC5LX	1	1
4		1079325	Label, Control Panel, Spanish - IRC5LX02	1	1
4		1079326	Label, Control Panel, Spanish - IRC6LX02	1	1
5		1180107	Connector, Barbed, Brass (1/4")	1	1
6		2001086-NLA	NLA - Knob, Flowmeter	1	1
6	I	1128379-NLA	NLA - Package, Knob, Flowmeter, Silver w/ Black Swish (Pkg. of 10)	10	1
6	J	1128380	Package, Knob, Flowmeter, Black w/ Silver Swish	10	1
7		2001989-NLA	NLA - Flowmeter with Palnuts - 3 Liter	1	1
7	H	2001773-NLA	NLA - Flowmeter with Palnuts - 5 Liter	1	1
7	G	1110561	Flowmeter without Palnuts - 5 Liter	1	1
7		1074672-NLA	NLA - Flowmeter with Palnuts - 6 Liter	1	1
8		2000799	Adapter with Tubing for Humidifier Bottle	1	1
9		2000503	Adapter, Humidifier Bottle	1	1
10		1098707	Hour Meter Assembly with Clip	1	1
11		2001134	Switch, On/Off	1	1
12		1056554	Circuit Breaker (8 AMP)	1	1
13		2000464-NLA	NLA - Support, Control Panel	1	2
14		2002674	Palnut (3/8-27)	1	1
15		2000507	Palnut (9/16-18)	1	2
16		1061773-NLA	NLA - Remote LED Assembly, Sens O2 - IRC5LX02	1	1
17	B	2001696-NLA	NLA - Transformer Assembly	1	1
17	C	1085200	Transformer Assembly	1	1
18		1028794-NLA	NLA - Screw, Phillips Truss Head Tap (#6 x 1/4")	1	6
19		2000436	Check Valve, Barb (5/16")	1	2
20		2001682	Tie Wrap (8" L)	1	2
21		P0750X030	Filter, Patient HEPA Outlet	1	1
22		2000897	Tubing, Tygon (1/4 x 24")	1	1
23	D	2001834-NLA	NLA - Harness, Wire IRC5LX	1	1

## Control Panel and P.C. Board

### All Models Except Platinum 5 (Before 12/15/00)

Item Number	Note	Part Number	Description	Quantity Per	
				Package	Assembly
23	D	2001762-NLA	NLA - Harness, Wire-Sensor - IRC5LX02	1	1
23	E	2003085-NLA	NLA - Harness, Wire, (All LX Models)	1	1
24		1036162	Stand-Off, P.C. Board	1	6
25	F	See Chart	# 25 P.C. Boards	1	1
	A	2001321-NLA	NLA - T-Fitting	1	1

NOTE: A - Not Shown.  
 B - Before 11/97.  
 C - After 10/97.  
 D - Before 5/97.  
 E - After 4/97.  
 F - See P.C. Board Chart.  
 G - Palnuts are no longer included, must be ordered separately. Requires (2) Palnuts - #2000507.  
 H - Item no longer available, refer to Part #1110561.  
 I - Knob is silver with black "swish". Used on Flowmeters with a Phillips Head Indented Screw on top.  
 J - Knob is black with silver "swish". Used on Flowmeters with a Slotted Head Screw on top.

### #25 P.C. Boards

Model	P.C. Board	Reconditioned P.C. Board
IRC3LX	1078183-NLA	1078183E
IRC5LX	1078183-NLA	1078183E
IRC5LX02 Before 7/98	1078181-NLA	1078181E-NLA
IRC5LX02 After 6/98	1113693	1113693E-NLA
IRC5LX02T	1079444-NLA	N/A
IRC6LX02 Before 7/98	1078181-NLA	1078181E-NLA
IRC6LX02 After 6/98	1113693	1113693E-NLA
IRC6LX02T	1079444-NLA	N/A

All P.C. Boards include an Instruction Sheet.