

Shower Chair - Mobile

Model 6358

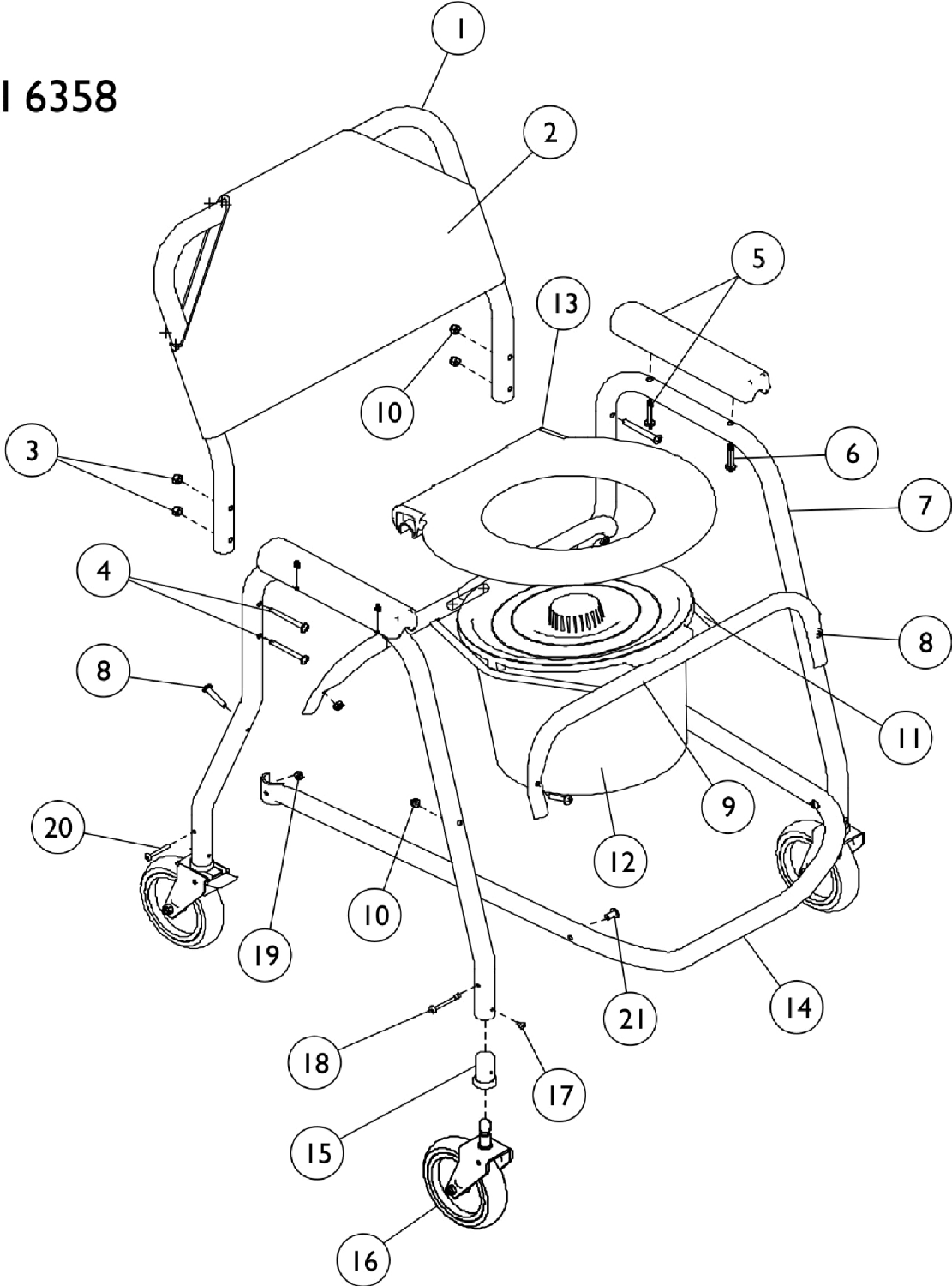

Shower Chair - Mobile

Item Number	Note	Part Number	Description	Quantity Per	
				Package	Assembly
1	D,J,V	1132265-NLA	NLA - Kit, Back Frame w/Upholstery and Hardware	1	1
2			NLA - Tube, Back Frame	1	1
3			NLA - Upholstery, Nylon Back, Grey	1	1
4			Locknut (1/4-20)	1	4
4			Screw, Phillips Pan Head (1/4-20 x 2-1/4")	1	4
1		13180X000-NLA	NLA - Tube, Back Frame	1	1
2	B	1086656-NLA	NLA - Upholstery, Nylon Back, Grey	1	1
2	A	13181X000-NLA	NLA - Upholstery, Nylon, Back, Bone	1	1
3		1008882	Locknut (1/4-20)	1	4
4		18860X007	Screw, Phillips Pan Head (1/4-20 x 2-1/4")	1	4
	D,H	1132261-NLA	NLA - Kit, Armrest with Hardware, Full Length - Grey	1	1
5			NLA - Armrest, Full Length, Grey	1	2
6			NLA - Screw, Phillips Pan Head (1/4 x 1-1/4")	1	4
5	B,C,Q	1059660-NLA	NLA - Armrest, Full Length, Grey	1	1
5	A	01010X003-NLA	NLA - Armrest, Desk Length	1	2
5	B	1066569-NLA	NLA - Kit, Arm Pad w/ Hardware (Pair)	1	1
6	A	48127X001-NLA	NLA - Screw, Phillips Round Head (#10-32 x 1/2")	1	4
6	B	1061431-NLA	NLA - Screw, Phillips Pan Head (1/4 x 1-1/4")	1	4
7	A	1020594-NLA	NLA - Frame, Side	1	2
7	B	1086654	Frame, Side	1	2
8		1008665-NLA	NLA - Screw, Phillips Pan Head (1/4-20 x 1-1/4")	1	4
	D,K	1132266-NLA	NLA - Kit, Seat Rails with Hardware	1	1
8			NLA - Screw, Phillips Pan Head (1/4-20 x 1-1/4")	1	4
9			NLA - Rail, Seat, Aluminum, Front	1	1
9			NLA - Rail, Seat, Aluminum, Rear	1	1
10			Locknut (1/4-20)	1	4
9		1020595-NLA	NLA - Rail, Seat, Aluminum, Front	1	1
9		1020596-NLA	NLA - Rail, Seat, Aluminum, Rear	1	1
10		60275X000	Locknut (1/4-20)	1	4
	D,I,T	1132262-NLA	NLA - Kit, Seat Ring with Pail and Holder	1	1
11			NLA - Holder, Pan/Pail	1	2
12			NLA - Pail with Lid and Handle, Grey	1	1
13			NLA - Seat, Ring	1	1
10	D,S,U	1152023-NLA	NLA - Kit, Seat Ring with Pail and Holder	1	1
11		1019161-NLA	NLA - Holder, Pan/Pail	1	2
12	A	13040X000-NLA	NLA - Pail with Lid, Almond	1	1
12	B,R	1080083	NLA - Pail with Lid and Handle, Grey	1	1
12		1152022	Pail w/ Lid and Handle, Grey	1	1
13	A	1079335-NLA	NLA - Seat, Ring	1	1
13	B	1061998-NLA	NLA - Seat, Ring	1	1
14		1020597-NLA	NLA - Tube, Foot Support	1	1
	D,E,M	1132263-NLA	NLA - Kit, Casters 5" without Wheel Locks	1	1
15			Caster Assembly, Swivel (5")	1	2
16			Sleeve, Caster	1	2
17			Screw, Phillips Pan Head Tap (#8-32 x 5/16")	1	2
	D,E,N	1132264-NLA	NLA - Kit, Caster 5" with Wheel Lock	1	1

Shower Chair - Mobile

Item Number	Note	Part Number	Description	Quantity Per	
				Package	Assembly
15			NLA - Caster Assembly, Swivel w/ Brake (5")	1	2
16			Sleeve, Caster	1	2
17			Screw, Phillips Pan Head Tap (#8-32 x 5/16")	1	2
15		1016683	Sleeve, Caster	1	4
16	G	01008X002-NLA	NLA - Casters without Wheel Lock, 1" Tube (5")	1	2
16	L	1016936-NLA	NLA - Caster without Wheel Lock (5")	1	2
16	E	1123547	Caster Assembly, Swivel (5")	1	2
16	F	01007X003-NLA	NLA - Casters with Wheel Lock, 1" Tube, (5")	1	2
16	E	1123546-NLA	NLA - Caster Assembly, Swivel w/ Brake (5")	1	2
17		020647	Screw, Phillips Pan Head Tap (#8-32 x 5/16")	1	4
	D,O	1132267-NLA	NLA - Kit, Frame Hardware	1	1
18			Screw, Phillips Pan Head w/ Patch (#10-32 x 1-3/4")	1	2
19			Locknut (#10-32)	1	2
20			Screw, Phillips Round Head (#10-32 x 1-3/8")	1	2
21			Rivnut (#10-32)	1	2
18		1007375	Screw, Phillips Pan Head w/ Patch (#10-32 x 1-3/4")	1	2
19		60279X003	Locknut (#10-32)	1	2
20		11008X011	Screw, Phillips Round Head (#10-32 x 1-3/8")	1	2
21		67005X000	Rivnut (#10-32)	1	2
	D	1027708-NLA	NLA - Decal, Invacare	1	1

NOTE: A - Before 5/15/99.
 B - After 5/14/99.
 C - Due to style changes, it is recommended to order Armrests in pairs (Part Number - 1059660) after 9/3/99.
 D - Not Shown.
 E - Due to style change, it is recommended that you replace the Casters for the entire Shower Chair. You may also need to order Items 15 and 17 along with the Casters.
 F - Item no longer available, use Part Number 1123546 as its replacement.
 G - Item no longer available, use Part Number 1016936 as its replacement.
 H - Kit includes (2) Armrests and (4) Screws.
 I - Kit includes items 11-13.
 J - Kit includes items 1-4.
 K - Kit includes items 8, 9 (Front and Rear) and 10.
 L - Item no longer available, use Part Number 1123547 as its replacement.
 M - Kit includes (2) Casters without Locks, (2) Sleeve Bearings and (2) Screws.
 N - Kit includes (2) Casters with Locks, (2) Sleeve Bearings and (2) Screws.
 O - Kit includes items 18 - 21.
 Q - Item no longer available, use Part Number 1132261 as its replacement.
 R - Item no longer available, use Part Number 1152022 as its replacement.
 S - Kit includes Pail, Seat Ring, and Holder.
 T - Before 8/16/07.
 U - After 8/15/07.
 V - No longer offered by the manufacturer.