

Link-Pivot Style Wheel Locks

9691B/9690B, Space Saver Arm, 9XT/9XDT/9SL & Space Saver Arm Super Low Model, 9XT (B4 8/14/03 Stock) (2/12/04-4/13/07 Bldr.) (After 4/13/07 Stock)

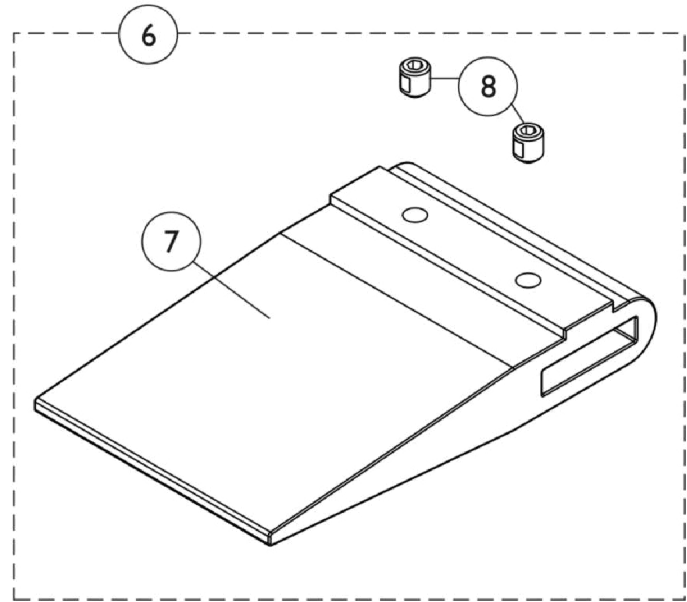
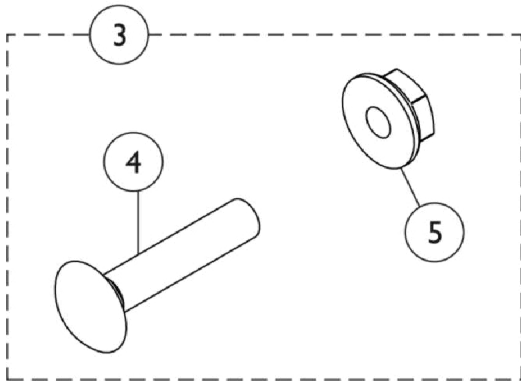
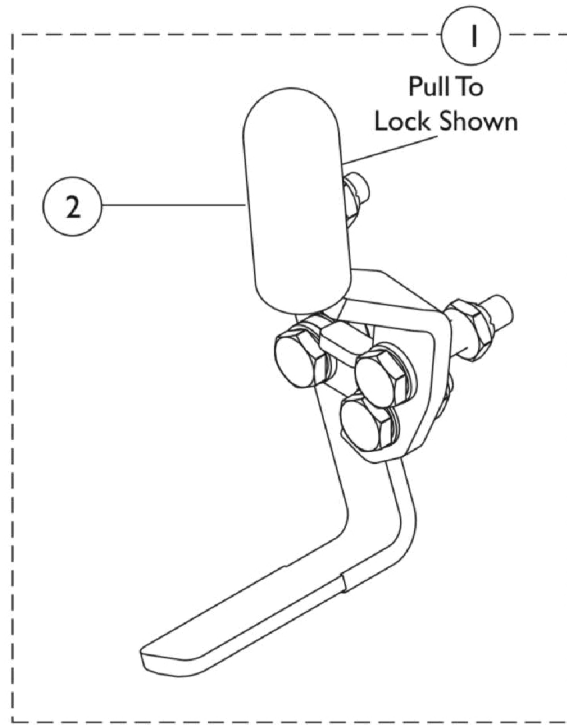
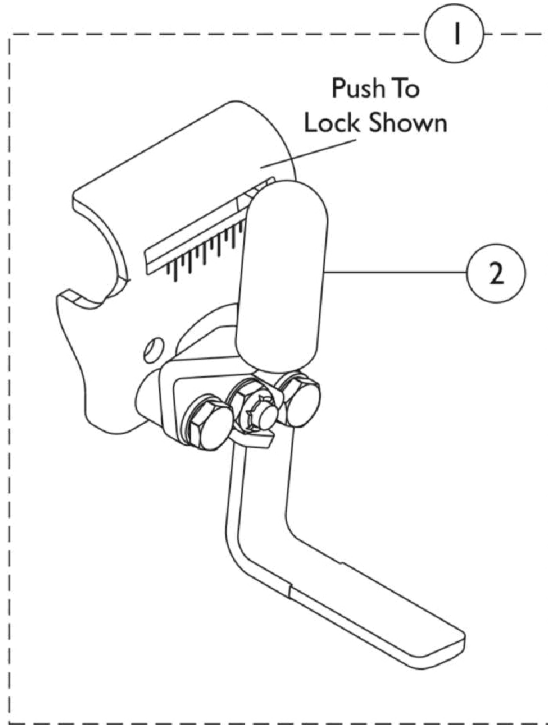

Link-Pivot Style Wheel Locks

9691B/9690B, Space Saver Arm, 9XT/9XDT/9SL & Space Saver Arm Super Low Model, 9XT (B4 8/14/03 Stock) (2/12/04-4/13/07 Bldr.) (After 4/13/07 Stock)

Item Number	Note	Part Number	Description	Quantity Per	
				Package	Assembly
1		1111924	Wheel Lock Assembly, Push to Lock, Black - Right	1	1
1		1111925	Wheel Lock Assembly, Push to Lock, Black - Left	1	1
1		1111926	Wheel Lock Assembly, Pull to Lock, Black - Right	1	1
1		1111927	Wheel Lock Assembly, Pull to Lock, Black - Left	1	1
1	D	1023484	Wheel Lock Assembly, Pull / Lock - Right	1	1
1	D	1023485	Wheel Lock Assembly, Pull / Lock - Left	1	1
1	D	1023493	Wheel Lock Assembly, Push to Lock - Right	1	1
1	D	1023494	Wheel Lock Assembly, Push / Lock - Left	1	1
2		47376X024	Tip, Rubber Wheel Lock Handle, Black	1	1
3	A	1017677	Kit, Hardware, Wheel Lock (Pair)	1	1
4			Bolt, Carriage (1/4-20 x 1-1/4")	1	2
5			Nut, Hex Flang (1/4-20)	1	2
6	C,B	1048656	Kit, Wheel Lock Shoe Spacer	1	1
7			Spacer, Wheel Lock Shoe (1-45/64")	1	1
8			Screw, Set Socket Cup Point (#8-32 x 3/16")	1	2
NOTE: A - Includes items 4 and 5. B - These items are not included with wheel lock, they may be needed if a chair has 20 or 22" rear wheels. C - Includes items 7 and 8. D - Space Saver Arm, Super Low Models, 9XT					
Note: Stock pick and Bldr. pick dates refer to how the wheel lock option was offered at the time.					